

F.A.P. RTE.	SECTION	COUNTY	TOTAL SHEETS	SHEET NO.
337	20R-6	LAKE	149	39
STA.		TO STA.		
FED. ROAD DIST. NO.		ILLINOIS FED. AID PROJECT		
CONTRACT NO. 62519				

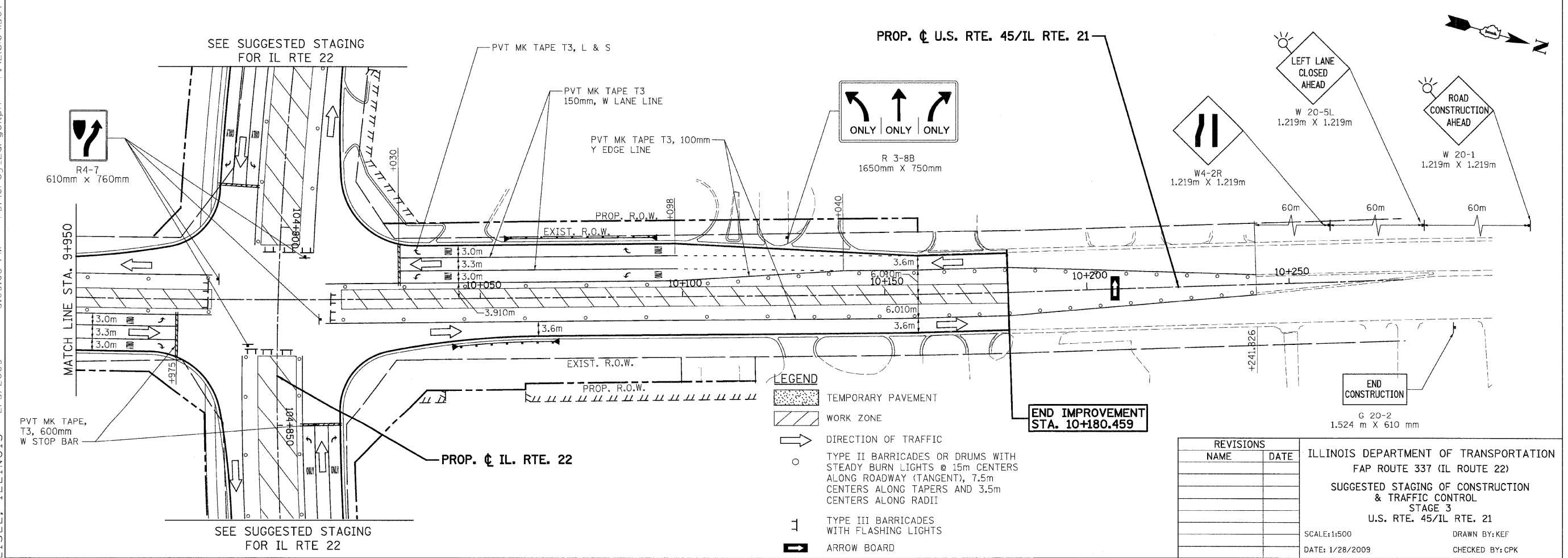
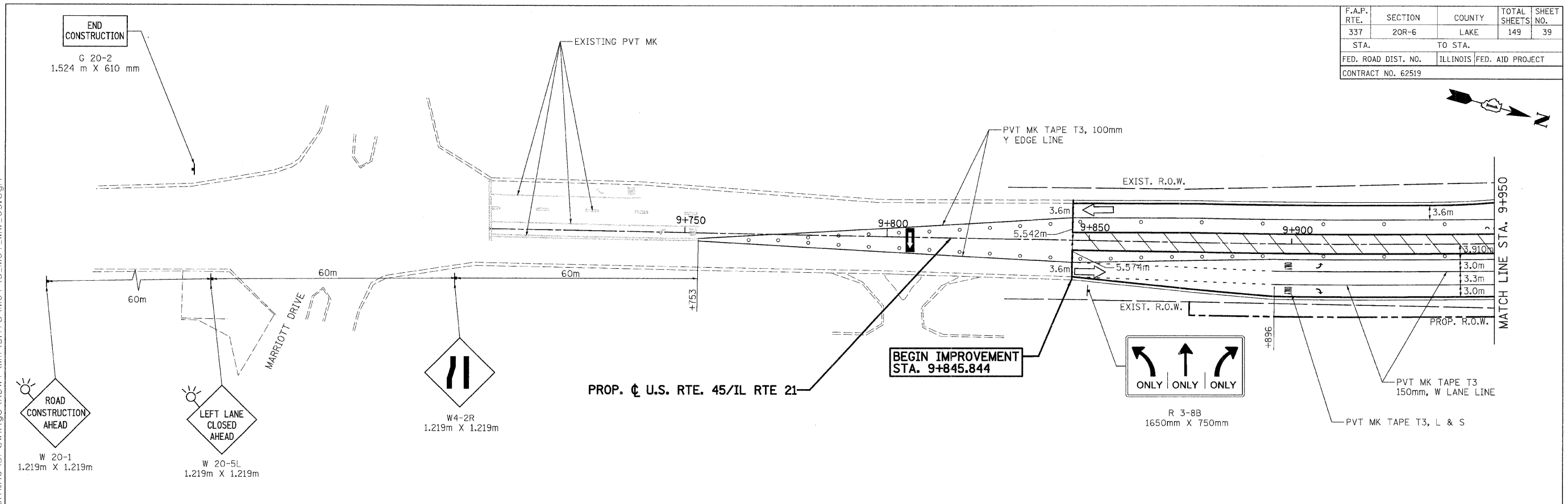

REVISIONS	
NAME	DATE

ILLINOIS DEPARTMENT OF TRANSPORTATION  
FAP ROUTE 337 (IL ROUTE 22)  
SUGGESTED STAGING OF CONSTRUCTION  
& TRAFFIC CONTROL  
STAGE 3  
U.S. RTE. 45/IL RTE. 21

SCALE: 1:500  
DATE: 1/28/2009

DRAWN BY: KEF  
CHECKED BY: CPK

tkoeppen(Rdwy\_Lislie) 5:09:03 PM 2/5/2009 P:\Lislie\DOT\9171\AO\Drawings\RDWY\MOT\Shts\MOT\S\_MOT\_MW\_03.dgn  
 PDF(Grey\_Large).plt  
**PATRICK ENGINEERING INC.**  
 LISLIE, ILLINOIS