

F.A.P. RTE.	SECTION	COUNTY	TOTAL SHEETS	SHEET NO.
337	20R-6	LAKE	149	62
STA.	TO STA.			
FED. ROAD DIST. NO.	ILLINOIS FED. AID PROJECT			
CONTRACT NO. 62519				

tkoeppen(Rdwy_Lisle) 2/5/2009 5:13:17 PM PDF(Grey_Large).plt P:\Lisle\IDOT\9171\A0\Drawings\RDWY\MII\Shts\Strp\S_Strp_MW.dgn

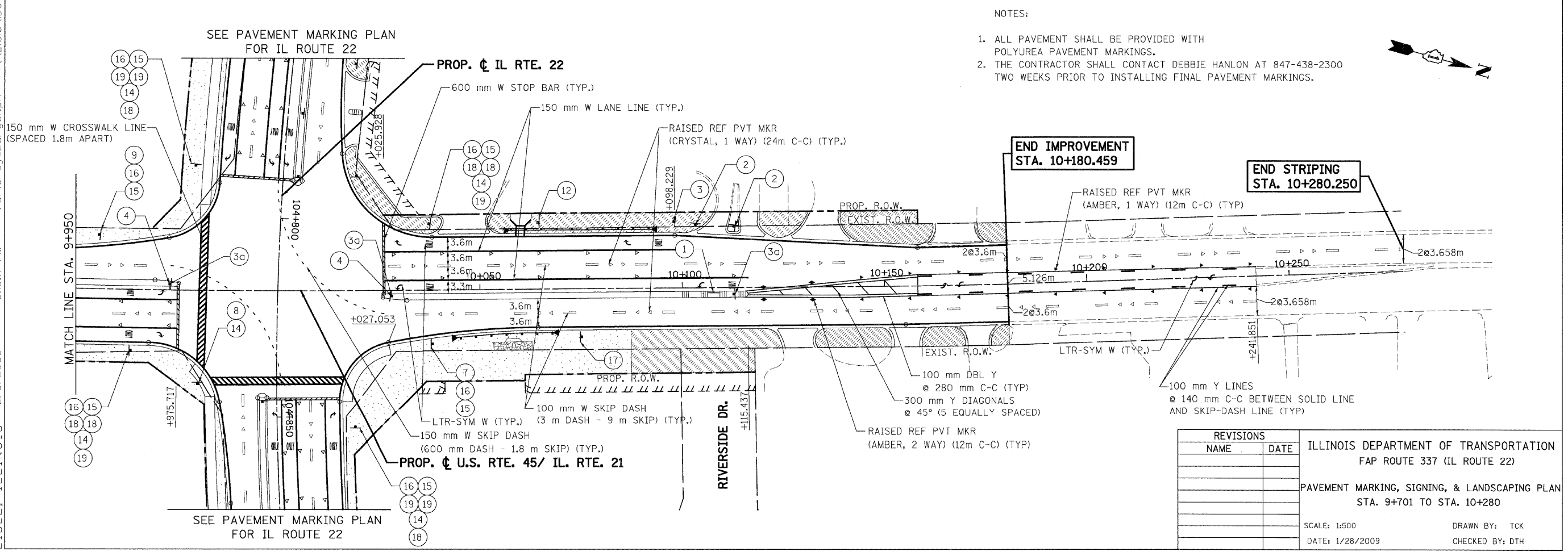
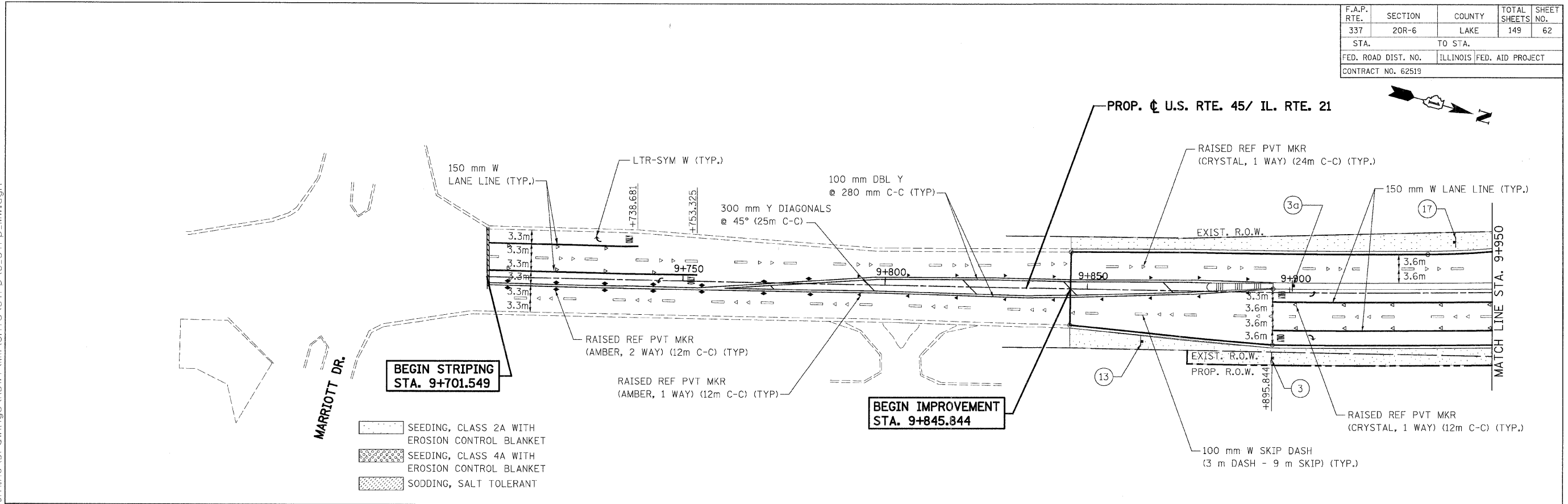

- NOTES:
1. ALL PAVEMENT SHALL BE PROVIDED WITH POLYUREA PAVEMENT MARKINGS.
 2. THE CONTRACTOR SHALL CONTACT DEBBIE HANLON AT 847-438-2300 TWO WEEKS PRIOR TO INSTALLING FINAL PAVEMENT MARKINGS.

REVISIONS	
NAME	DATE

ILLINOIS DEPARTMENT OF TRANSPORTATION
 FAP ROUTE 337 (IL ROUTE 22)
 PAVEMENT MARKING, SIGNING, & LANDSCAPING PLAN
 STA. 9+701 TO STA. 10+280
 SCALE: 1:500
 DATE: 1/28/2009
 DRAWN BY: TCK
 CHECKED BY: DTH

