

REMOVE EXISTING TRAFFIC SIGNAL EQUIPMENT

THE FOLLOWING EXISTING TRAFFIC SIGNAL EQUIPMENT SHALL BE REMOVED BY THE CONTRACTOR AND SHALL REMAIN THE PROPERTY OF THE AGENCY LISTED BELOW. THE CONTRACTOR SHALL SAFELY STORE AND ARRANGE FOR PICK UP OF ALL EQUIPMENT TO BE RETURNED TO THE LISTED AGENCY AS PER THE TRAFFIC SIGNAL SPECIFICATIONS.

AGENCY: LINCOLNSHIRE - RIVERWOODS FIRE PROTECTION DISTRICT

- 4 EACH CONFIRMATION BEACON
- 4 EACH LIGHT DETECTOR
- 1 EACH LIGHT DETECTOR AMPLIFIER

THE FOLLOWING ITEMS SHALL BE REMOVED BY THE CONTRACTOR AND SHALL BE DISPOSED OF BY THEM OUTSIDE THE RIGHT-OF-WAY AT THEIR EXPENSE. THE SALVAGE VALUE OF THE REMOVED EQUIPMENT SHALL BE REFLECTED ON THE CONTRACT BID PRICE.

- 4 EACH TRAFFIC SIGNAL BACKPLATE
- 4 EACH SIGNAL HEAD, 1-FACE
- 4 EACH MAST ARM ASSEMBLY AND POLE
- 4 EACH SIGNAL HEAD, 2-FACE
- 4 EACH TRAFFIC SIGNAL POST
- 1 EACH SERVICE INSTALLATION
- 1 EACH CONTROLLER AND CABINET (COMPLETE)

NO ROADWAY CONSTRUCTION WILL COMMENCE UNTIL THE TEMPORARY SIGNALS WITH TEMPORARY RADIO INTERCONNECT ARE CONSTRUCTED, INSPECTED AND TIMINGS ACCEPTED BY THE R-1 AREA TRAFFIC ENGINEER.

CONTROLLER CABINET TYPE & DIMENSION VARY. THE CONTRACTOR SHALL BE RESPONSIBLE FOR CORRECT CABINET DIMENSIONS PRIOR TO THE CONSTRUCTION OF THE CABINET MOUNTING PLATFORM SHOWN BELOW. CABINET PLATFORM LEGS & RAILS SHALL BE CONSTRUCTED OF 2" X 6" TREATED WOOD TO RESIST WEATHERING.

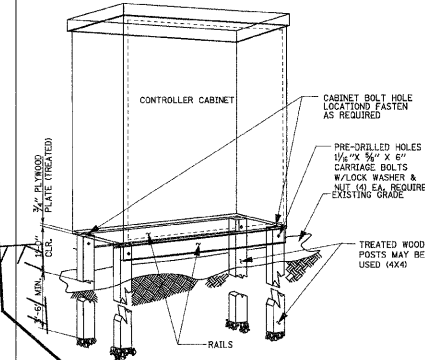

SIGNAL HEAD PLACEMENT LEGEND

- ① STAGE 1 MOT
- ② STAGE 2 MOT
- ③ STAGE 3 MOT

THE PLACEMENT OF SIGNAL HEADS & PRE-EMPTION EQUIPMENT AS SHOWN ARE BASED ON THE MAINTENANCE OF TRAFFIC PLANS. THE ACTUAL LOCATIONS SHALL BE AS PER THE LANE CONFIGURATION DURING CONSTRUCTION STAGING & AS DIRECTED BY THE ENGINEER.

RESTORATION OF WORK AREA. RESTORATION OF THE TRAFFIC SIGNAL WORK AREA SHALL BE INCIDENTAL TO THE RELATED PAY ITEM SUCH AS FOUNDATION, CONDUIT, HANDHOLE, TRENCH AND BACKFILL, ETC., AND NO EXTRA COMPENSATION SHALL BE ALLOWED. ALL ROADWAY SURFACES SUCH AS SHOULDERS, MEDIAN, SIDEWALKS, PAVEMENT ETC. SHALL BE REPLACED IN KIND. ALL DAMAGE TO MOWED LAWNS SHALL BE REPLACED WITH AN APPROVED SOD, AND ALL DAMAGE TO UNMOWED FIELDS SHALL BE SEEDED IN ACCORDANCE WITH STANDARD SPECIFICATIONS 252 AND 250 RESPECTIVELY.

F.A.P. RTE.	SECTION	COUNTY	TOTAL SHEETS	SHEET NO.
337	20R-6	LAKE	149	68
STA.	TO STA.			
FED. ROAD DIST. NO.	ILLINOIS	FED. AID PROJECT		

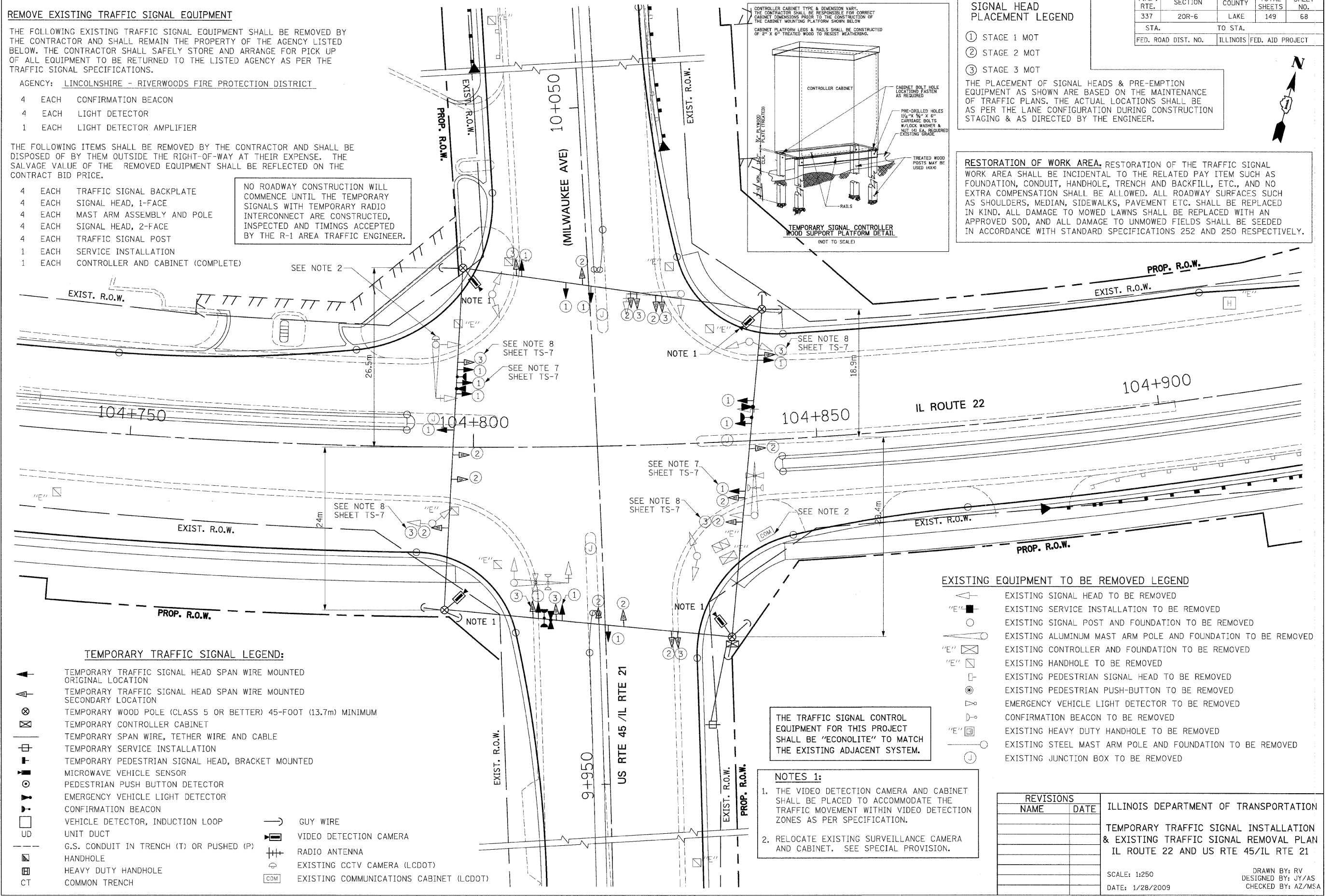

- TEMPORARY TRAFFIC SIGNAL LEGEND:**
- TEMPORARY TRAFFIC SIGNAL HEAD SPAN WIRE MOUNTED ORIGINAL LOCATION
 - TEMPORARY TRAFFIC SIGNAL HEAD SPAN WIRE MOUNTED SECONDARY LOCATION
 - TEMPORARY WOOD POLE (CLASS 5 OR BETTER) 45-FOOT (13.7m) MINIMUM
 - TEMPORARY CONTROLLER CABINET
 - TEMPORARY SPAN WIRE, TETHER WIRE AND CABLE
 - TEMPORARY SERVICE INSTALLATION
 - TEMPORARY PEDESTRIAN SIGNAL HEAD, BRACKET MOUNTED
 - MICROWAVE VEHICLE SENSOR
 - PEDESTRIAN PUSH BUTTON DETECTOR
 - EMERGENCY VEHICLE LIGHT DETECTOR
 - CONFIRMATION BEACON
 - VEHICLE DETECTOR, INDUCTION LOOP
 - UNIT DUCT
 - G.S. CONDUIT IN TRENCH (T) OR PUSHED (P)
 - HANDHOLE
 - HEAVY DUTY HANDHOLE
 - COMMON TRENCH
 - GUY WIRE
 - VIDEO DETECTION CAMERA
 - RADIO ANTENNA
 - EXISTING CCTV CAMERA (LCDOT)
 - EXISTING COMMUNICATIONS CABINET (LCDOT)

- EXISTING EQUIPMENT TO BE REMOVED LEGEND**
- EXISTING SIGNAL HEAD TO BE REMOVED
 - EXISTING SERVICE INSTALLATION TO BE REMOVED
 - EXISTING SIGNAL POST AND FOUNDATION TO BE REMOVED
 - EXISTING ALUMINUM MAST ARM POLE AND FOUNDATION TO BE REMOVED
 - EXISTING CONTROLLER AND FOUNDATION TO BE REMOVED
 - EXISTING HANDHOLE TO BE REMOVED
 - EXISTING PEDESTRIAN SIGNAL HEAD TO BE REMOVED
 - EXISTING PEDESTRIAN PUSH-BUTTON TO BE REMOVED
 - EMERGENCY VEHICLE LIGHT DETECTOR TO BE REMOVED
 - CONFIRMATION BEACON TO BE REMOVED
 - EXISTING HEAVY DUTY HANDHOLE TO BE REMOVED
 - EXISTING STEEL MAST ARM POLE AND FOUNDATION TO BE REMOVED
 - EXISTING JUNCTION BOX TO BE REMOVED

THE TRAFFIC SIGNAL CONTROL EQUIPMENT FOR THIS PROJECT SHALL BE "ECONOLITE" TO MATCH THE EXISTING ADJACENT SYSTEM.

- NOTES:**
- THE VIDEO DETECTION CAMERA AND CABINET SHALL BE PLACED TO ACCOMMODATE THE TRAFFIC MOVEMENT WITHIN VIDEO DETECTION ZONES AS PER SPECIFICATION.
 - RELOCATE EXISTING SURVEILLANCE CAMERA AND CABINET. SEE SPECIAL PROVISION.

REVISIONS	
NAME	DATE

ILLINOIS DEPARTMENT OF TRANSPORTATION
 TEMPORARY TRAFFIC SIGNAL INSTALLATION & EXISTING TRAFFIC SIGNAL REMOVAL PLAN
 IL ROUTE 22 AND US RTE 45/IL RTE 21
 SCALE: 1:250
 DATE: 1/28/2009
 DRAWN BY: RV
 DESIGNED BY: JY/AS
 CHECKED BY: AZ/MSA

PATRICK ENGINEERING INC.
 LISLE, ILLINOIS
 P:\11101\DOT\9171.A0\Drawings\RDWY\11\Shets\Traf\m.lwtp.in.dgn
 2/6/2009 10:39:14 AM