

F.A.P. RTE.	SECTION	COUNTY	TOTAL SHEETS	SHEET NO.
337	20R-6	LAKE	149	77
STA.	TO STA.			
FED. ROAD DIST. NO.	ILLINOIS	FED. AID PROJECT		

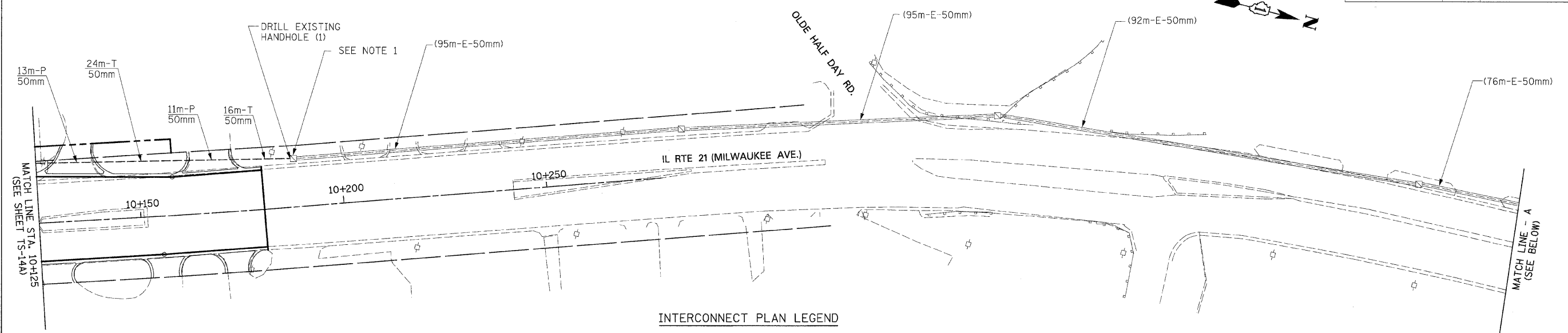

**RESTORATION OF WORK AREA.** RESTORATION OF THE TRAFFIC SIGNAL WORK AREA SHALL BE INCIDENTAL TO THE RELATED PAY ITEM SUCH AS FOUNDATION, CONDUIT, HANDHOLE, TRENCH AND BACKFILL, ETC., AND NO EXTRA COMPENSATION SHALL BE ALLOWED. ALL ROADWAY SURFACES SUCH AS SHOULDERS, MEDIAN, SIDEWALKS, PAVEMENT ETC. SHALL BE REPLACED IN KIND. ALL DAMAGE TO MOWED LAWNS SHALL BE REPLACED WITH AN APPROVED SOD, AND ALL DAMAGE TO UNMOWED FIELDS SHALL BE SEEDDED IN ACCORDANCE WITH STANDARD SPECIFICATIONS 252 AND 250 RESPECTIVELY.

**INTERCONNECT PLAN LEGEND**

PROPOSED	EXISTING	
		CONTROLLER
		HANDHOLE
		DOUBLE HANDHOLE
		HEAVY-DUTY HANDHOLE
		G.S. CONDUIT IN TRENCH (T) OR PUSHED (P)
		DETECTOR LOOP
		COMMON TRENCH
		UNIT DUCT
		SYSTEM
		INTERSECTION

**NOTES:**

1. THE CONDUIT SHALL BE INSTALLED INTO THE HANDHOLE AT THE CONDUIT STUB FROM THE TEMPORARY INTERCONNECT.

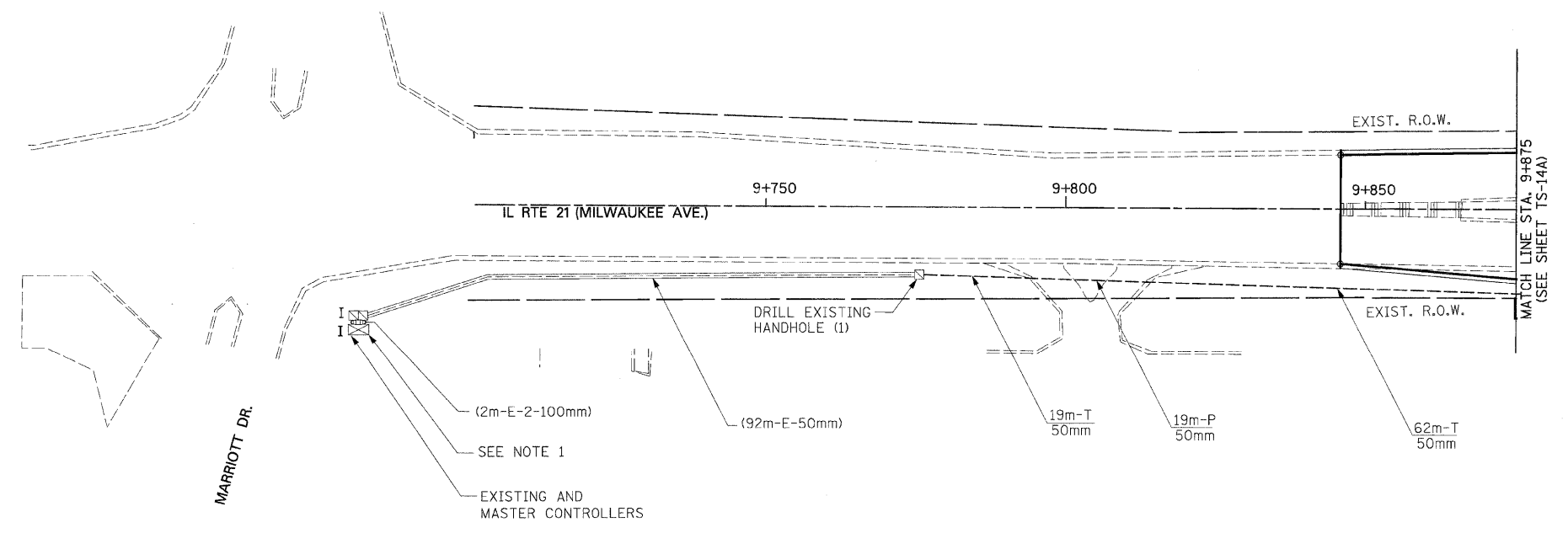
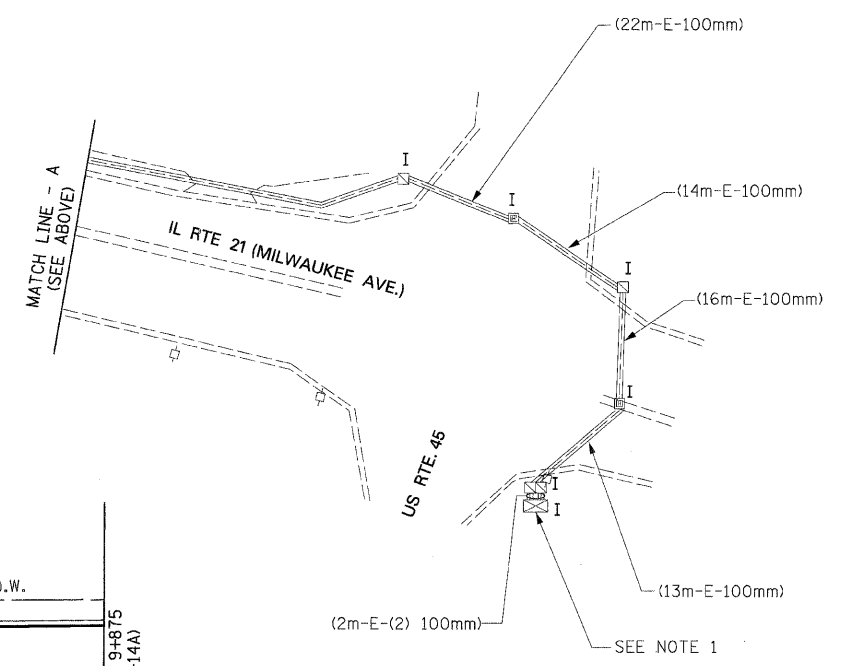

THE TRAFFIC SIGNAL CONTROL EQUIPMENT FOR THIS PROJECT SHALL BE "ECONOLITE" TO MATCH THE EXISTING ADJACENT SYSTEM.

TS-15

REVISIONS	
NAME	DATE

ILLINOIS DEPARTMENT OF TRANSPORTATION  
 IL RTE 21 & IL RTE 22  
 INTERCONNECT  
 SHEET 2 OF 3  
 SCALE: 1:500  
 DATE: 1/28/2009  
 DRAWN BY: RV  
 DESIGNED BY: JY/AS  
 CHECKED BY: AZ/MSA

**PATRICK ENGINEERING INC.**  
 LISLE, ILLINOIS  
 P:\Lisle\1007\9171-A0\Drawings\RDW\Y\MI1\Shets\Traf\Int2.dgn  
 2/6/2009 10:51:00 AM