

F.A.I. RTE.	SECTION	COUNTY	TOTAL SHEETS	SHEET NO.
57	2021.1B-R	COOK	101	022
STA.		TO STA.		
FED. ROAD DIST. NO. 1		ILLINOIS FED. AID PROJECT		
CONTRACT NO. 62532				

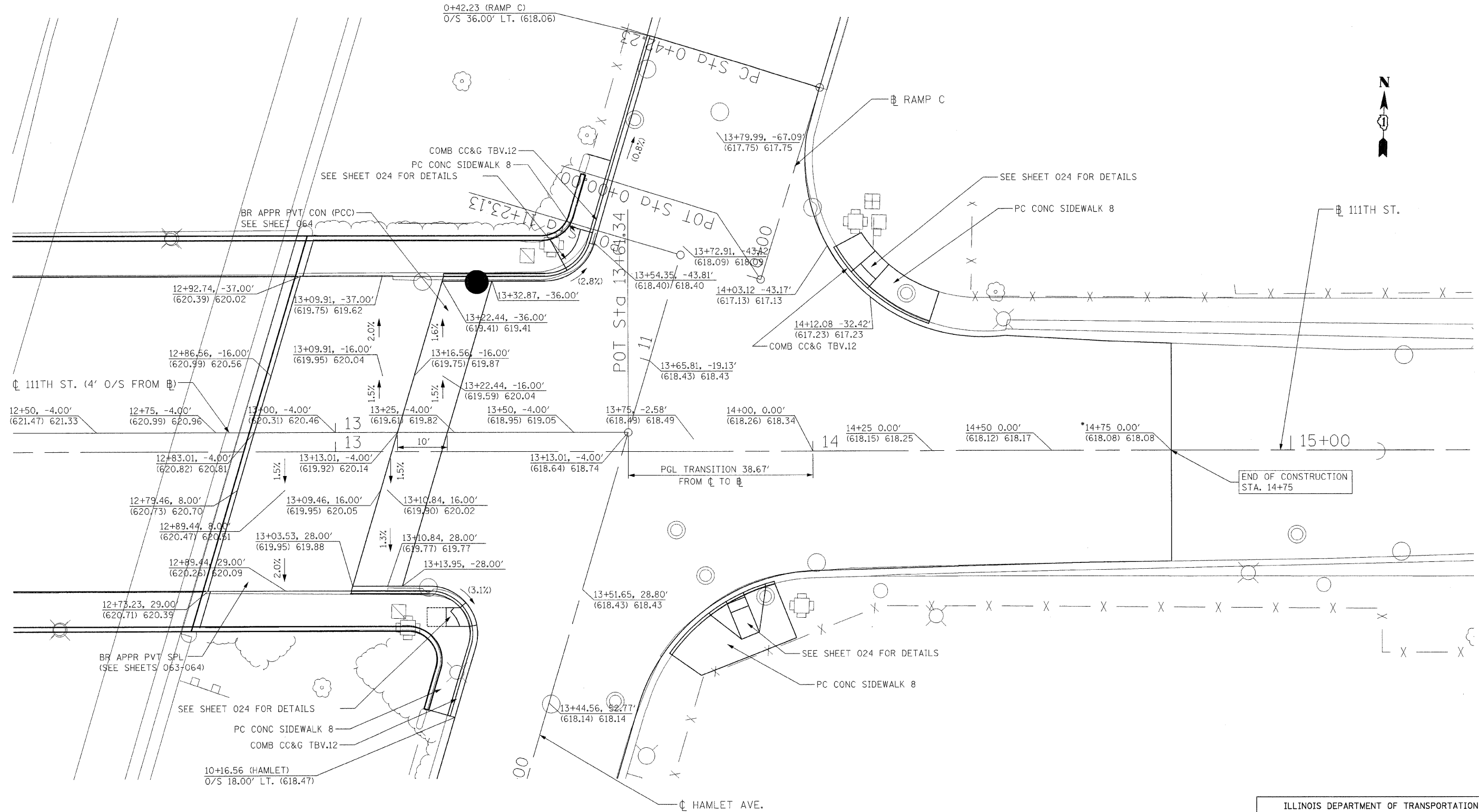

PROPOSED INTERSECTION GRADING PLAN  
FOR 111TH STREET AND HAMLET AVE.

NOTE: ALL STATIONING MEASURED OFF 111TH STREET  $\varnothing$  UNLESS OTHERWISE NOTED.  
• CONTRACTOR SHALL VERIFY EXISTING ELEVATION PRIOR TO CONSTRUCTION

LEGEND

STATION, OFFSET  
(EXIST. ELEV.) PROP. ELEV.  
(X.X%) - EXISTING SLOPE

REVISIONS	
NAME	DATE

ILLINOIS DEPARTMENT OF TRANSPORTATION  
111TH STREET OVER  
F.A.I. ROUTE 57 (INTERSTATE 57)  
**111TH AND HAMLET AVE.  
INTERSECTION GRADING PLAN**

SCALE: 1"=10'  
DATE: 01/16/09

DRAWN BY: BRH  
CHECKED BY: ACL

**TENG**  
TENG & ASSOCIATES, INC.  
ENGINEERS, ARCHITECTS, PLANNERS  
205 N. MICHIGAN AVE., CHICAGO, IL 60601  
TELEPHONE: 312/616-0000

\\L:\T0008\8.DGN, \\DRA008\8.DGN, \\T1000\8.DGN, \\DRA007\Z.DGN, \\TPO00\U.DGN, \\RWO0\T.BE.DGN, \\HECHTBR  
 I-6-2009, 14:52:20 T:\DOCUMENT\930860\CIVIL\JDN\RWO0\8.DGN  
 1 2 3 4 5 6 7 8 9 10 11 12 13 14 15 16 17 18 19 20 21 22 23 24 25 26 27 28 29 30 31 32 33 34 35 36 37 38 39 40 41 42 43 44 45 46 47 48 49 50 51 52 53 54 55 56 57 58 59 60 61 62