

F.A.I. RTE.	SECTION	COUNTY	TOTAL SHEETS	SHEET NO.
57	2021.13-R	COOK	101	086
STA.	TO STA.			
FED. ROAD DIST. NO. 1	ILLINOIS		FED. AID PROJECT	
CONTRACT NO. 62532				

BAR LIST

Bar	No.	Size	Length	Shape
d25(E)	118	#6	3'-1"	
d26(E)	115	#4	2'-9"	
d27(E)	22	#6	4'-4"	
d28(E)	38	#4	2'-6"	
d29(E)	6	#6	4'-9"	
d30(E)	10	#6	8'-11"	
d31(E)	22	#4	3'-8"	
e25(E)	12	#4	8'-8"	
e26(E)	3	#4	8'-6"	
e27(E)	3	#4	8'-0"	
e29(E)	12	#4	2'-9"	
e31(E)	3	#4	12'-5"	
e32(E)	3	#4	11'-7"	
e33(E)	6	#4	13'-3"	
e34(E)	24	#4	16'-11"	
e35(E)	6	#4	9'-8"	
h25(E)	8	#5	44'-4"	
h26(E)	4	#6	44'-6"	
h27(E)	4	#5	2'-3"	
h28(E)	4	#6	8'-4"	
h29(E)	6	#5	5'-2"	
h30(E)	6	#5	5'-11"	
h31(E)	6	#5	5'-0"	
h32(E)	6	#5	5'-4"	
h34(E)	12	#5	6'-3"	
h35(E)	4	#5	36'-1"	
h36(E)	4	#5	11'-1"	
v25(E)	16	#4	3'-5"	
v26(E)	69	#4	3'-3"	
v27(E)	69	#4	5'-2"	
v28(E)	32	#4	5'-5"	
v29(E)	69	#4	3'-2"	
v30(E)	69	#4	3'-4"	
v32(E)	4	#6	5'-6"	
v33(E)	4	#4	5'-6"	
v34(E)	4	#6	5'-11"	
v35(E)	4	#4	5'-11"	

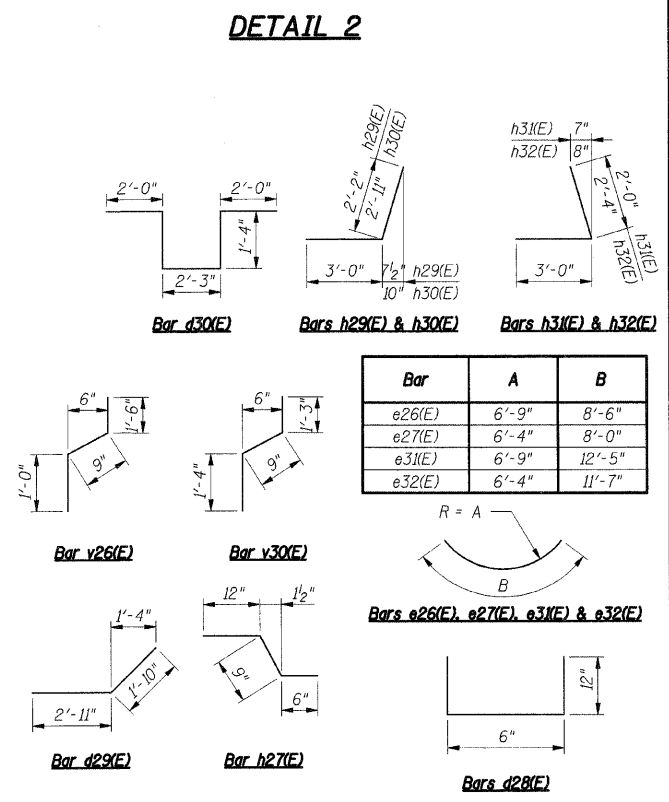
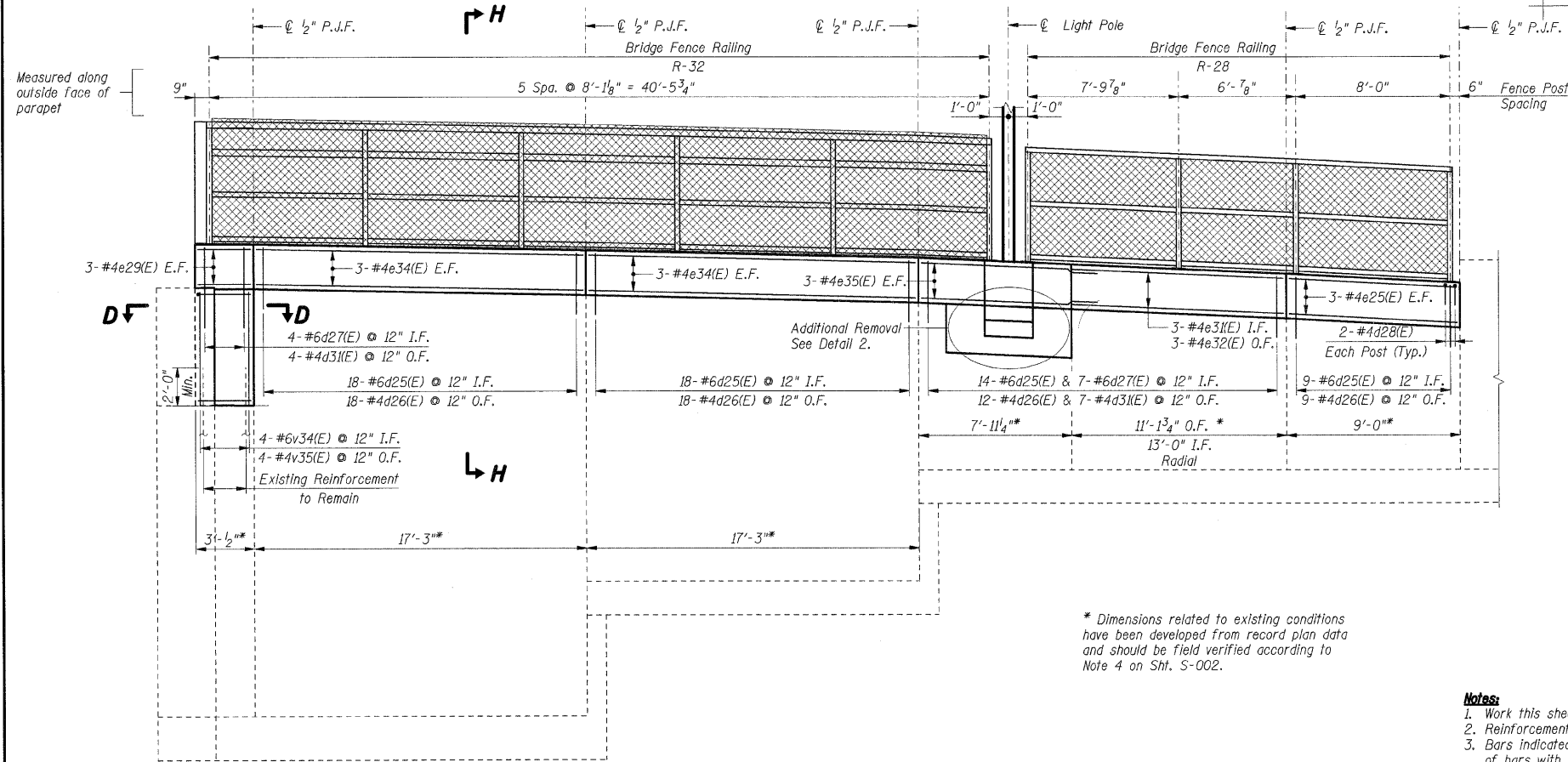
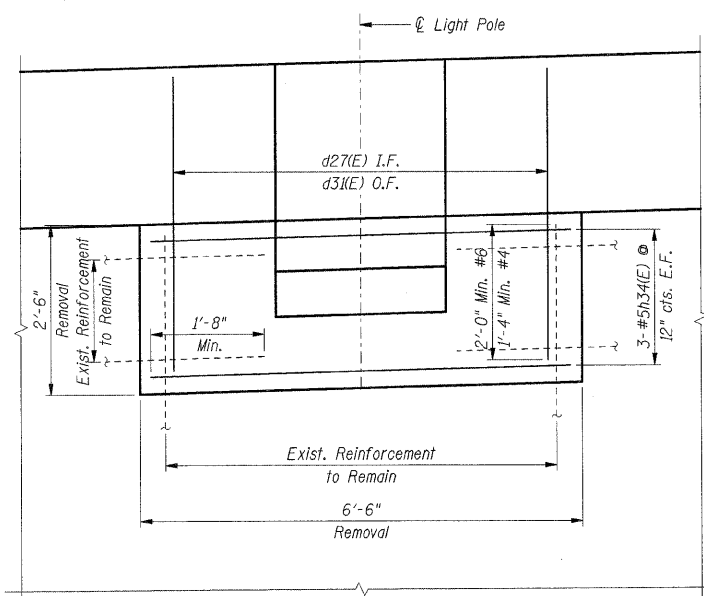
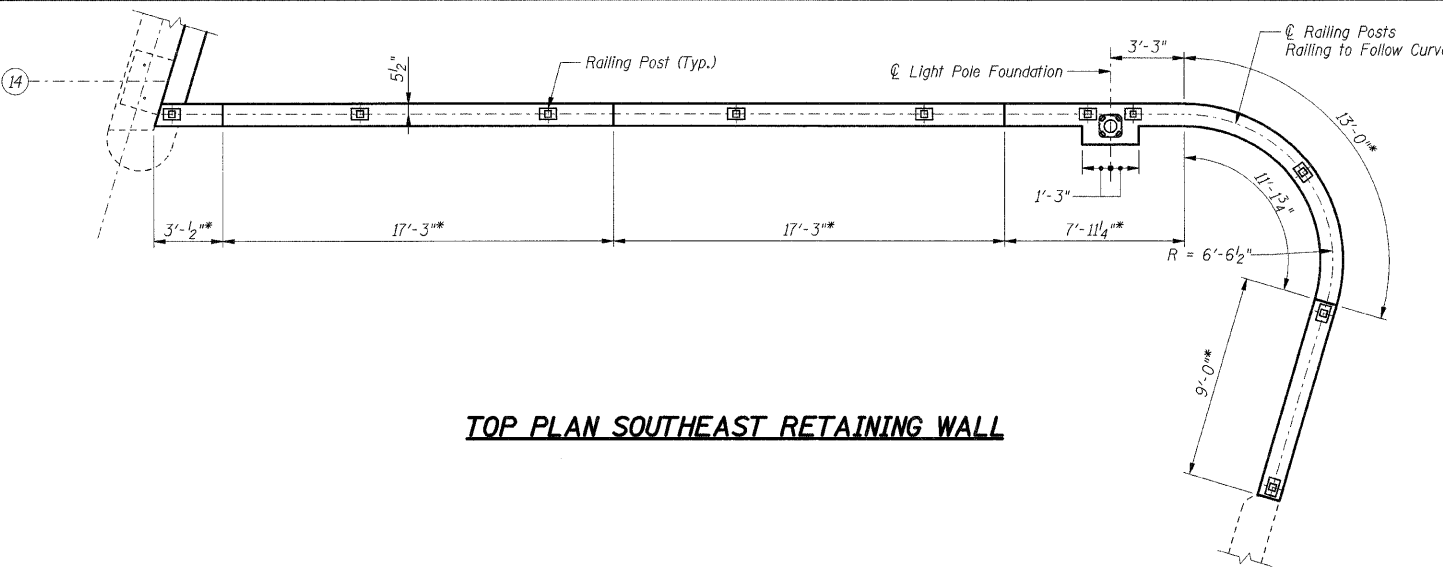

Bar	A	B
e26(E)	6'-9"	8'-6"
e27(E)	6'-4"	8'-0"
e31(E)	6'-9"	12'-5"
e32(E)	6'-4"	11'-7"

R = A

Bar	A	B
e26(E), e27(E), e31(E) & e32(E)		

LAP LENGTHS

Bar Size	Min. Lap
#4	1'-11"
#5	1'-8"
#6	2'-0"

* Dimensions related to existing conditions have been developed from record plan data and should be field verified according to Note 4 on Sht. S-002.

- Notes:**
1. Work this sheet with Shts. S-020 & S-021.
 2. Reinforcement bars designated (E) shall be epoxy coated.
 3. Bars indicated thus 30 x 2-#5 etc. indicates 30 lines of bars with 2 lengths per line.
 4. All edges shall have standard 3/4" chamfers except as noted.
 5. I.F. Indicates Inside Face
O.F. Indicates Outside Face
B.F. Indicates Back Face
 6. Quantities indicated with a double asterisk (**) are estimated quantities to be determined by the Engineer in the field. Adjustment to the quantities shall not be cause for additional compensation; however the Contractor will be paid for the quantity of work performed at the unit price bid for the work.
 7. Existing reinforcement bars to remain shall be cleaned and incorporated into new construction with a minimum projection length as shown. Bars with insufficient projection or with 10% or more section loss shall be removed flush to the concrete removal line and replaced in kind by drilling and grouting new bars of equivalent size, the cost of which is included with Concrete Removal.
 8. Reinforcement bars shall be epoxy grouted in accordance with Section 584 of the Standard Specifications. The grout and method of application shall be approved by the Department. Cost included with Reinforcement Bars, Epoxy Coated.

BILL OF MATERIAL

Item	Unit	Total
Porous Granular Embankment, Special	Cu Yd	90
Concrete Removal	Cu Yd	23.2
Structure Excavation	Cu Yd	90
Concrete Structures	Cu Yd	26.8
Reinforcement Bars, Epoxy Coated	lbs	3,780
Bar Splacers	Each	69
Concrete Sealer	Sq Ft	167
Structural Repair of Concrete, Depth Equal to or Less Than 5" **	Sq Ft	350

LEGEND

Concrete Removal

SHT. S-022

REVISIONS

NAME	DATE

ILLINOIS DEPARTMENT OF TRANSPORTATION
 F.A.I. ROUTE 57 (INTERSTATE 57)
 111TH STREET BRIDGE DECK REPLACEMENT
 111TH STREET OVER I-57
 SN 016-0989 STA. 556+99.89
 COOK COUNTY

EAST ABUTMENT
 DETAILS AND BILL OF MATERIAL

DATE: 01/16/09

DRAWN BY: TMH
 CHECKED BY: JLR

TENG

TENG & ASSOCIATES, INC.
 ENGINEERS/ARCHITECTS/PLANNERS
 205 N. MICHIGAN AVE., CHICAGO, IL 60601
 TELEPHONE: 312.516.0000

N:\PROJECTS\0301_111ST\111ST_ABT001\111ST_ABT001_1.DGN, N:\PROJECTS\0301_111ST\111ST_ABT001_1.DGN, N:\PROJECTS\0301_111ST\111ST_ABT001_1.DGN
 FILE: 0301_111ST_111ST_ABT001_1.DGN, FILE: 0301_111ST_111ST_ABT001_1.DGN, FILE: 0301_111ST_111ST_ABT001_1.DGN
 color: table: K:\STANDARDS\TEXTDATA\COLORTABLE.TBL