

NOTE:
 CONTRACTOR ACCESS AND INSTALLATION, MAINTENANCE, REMOVAL AND RESTORATION OF HAUL ROADS SHALL NOT BE PAID FOR SEPARATELY, BUT SHALL BE INCLUDED IN THE COST OF THE CONTRACT. RESTORATION SHALL INCLUDE REMOVAL OF ALL HAUL ROAD MATERIALS, GRADING, TOPSOIL PLACEMENT AND EROSION CONTROL IN ACCORDANCE WITH STANDARD SPECIFICATIONS FOR ROAD AND BRIDGE CONSTRUCTION (SEE EDITION SPECIFIED UNDER GENERAL NOTES ON SHEET #2 FOR DETAILS).

- TEMPORARY CAUSEWAY
- TEMPORARY FENCE (TO BE PLACED 1' ALONG EACH SIDE OF HAUL ROUTES)
- OVERHEIGHT VEHICLE DETECTION SYSTEM
- TROLLEY WIRE AND COMED POLE
- OVERHEAD ELECTRIC LINE
- TEMPORARY CHAINLINK FENCE VEHICLE GATE

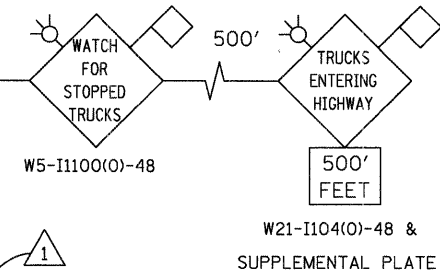
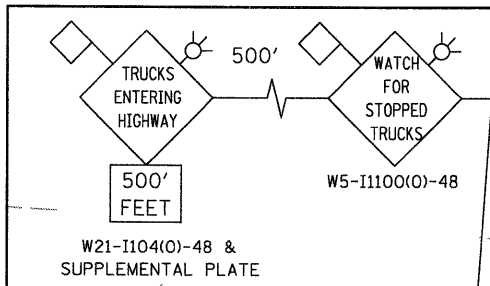

FILE NAME = IL31_con_entr_mot

USER NAME = GYSherman
 PLOT SCALE = 40.0000' / IN.
 PLOT DATE = 4/9/2009

DESIGNED - GS
 DRAWN - GS
 CHECKED - SE
 DATE - 01/16/09

REVISED Δ Addendum 4/9/09
 REVISED -
 REVISED -
 REVISED -

**STATE OF ILLINOIS
 DEPARTMENT OF TRANSPORTATION**

**STEARNS ROAD
 SUGGESTED CONTRACTOR ACCESS PLAN**

SCALE: 1"=40' SHEET NO. 5 OF 5 SHEETS STA. TO STA.

F.A.P. RTE. 361	SECTION 06-00214-20-BR	COUNTY KANE	TOTAL SHEETS 320	SHEET NO. 47
CONTRACT NO.				
FED. ROAD DIST. NO. ILLINOIS FED. AID PROJECT				

