

F.A.P. RTE.	SECTION	COUNTY	TOTAL SHEETS	SHEET NO.
361	06-00214-20-BR	KANE	320	166
STA. 511+80.00		TO STA. 609+14.92		
FED. ROAD DIST. NO. 7		ILLINOIS FED. AID PROJECT		
SHEET NO. S61 OF S108				

Girder 8

Location	Station	Offset (ft)	Theoretical Grade Elevations	Theoretical Grade Elevations Adjusted For Dead Load Deflection
Ⓜ MUP Ramp	569+70.91	10.17	701.44	701.44
Ⓞ Brgs. W. Abut.	569+71.79	10.17	701.44	701.44
AA	569+83.32	10.17	701.49	701.62
AB	569+93.32	10.17	701.63	701.83
AC	570+03.32	10.17	701.84	702.09
AD	570+13.32	10.17	702.14	702.38
AE	570+23.32	10.17	702.51	702.71
AF	570+33.32	10.17	702.97	703.08
Ⓞ Brgs. W. Pier 2	570+45.00	10.17	703.54	703.53
Ⓞ Pier 2	570+46.25	10.17	703.60	703.60

Girder 9

Location	Station	Offset (ft)	Theoretical Grade Elevations	Theoretical Grade Elevations Adjusted For Dead Load Deflection
Ⓜ MUP Ramp	569+72.16	1.83	701.31	701.31
Ⓞ Brgs. W. Abut.	569+73.04	1.83	701.31	701.31
AA	569+83.32	1.83	701.37	701.49
AB	569+93.32	1.83	701.50	701.71
AC	570+03.32	1.83	701.72	701.96
AD	570+13.32	1.83	702.01	702.25
AE	570+23.32	1.83	702.39	702.58
AF	570+33.32	1.83	702.84	702.96
Ⓞ Brgs. W. Pier 2	570+45.00	1.83	703.42	703.40
Ⓞ Pier 2	570+46.25	1.83	703.48	703.48

P.G.

Location	Station	Offset (ft)	Theoretical Grade Elevations	Theoretical Grade Elevations Adjusted For Dead Load Deflection
Ⓜ MUP Ramp	569+72.44	0.00	701.28	701.28
Ⓞ Brgs. W. Abut.	569+73.32	0.00	701.29	701.29
AA	569+83.32	0.00	701.34	701.46
AB	569+93.32	0.00	701.47	701.68
AC	570+03.32	0.00	701.69	701.93
AD	570+13.32	0.00	701.98	702.23
AE	570+23.32	0.00	702.36	702.56
AF	570+33.32	0.00	702.82	702.93
Ⓞ Brgs. W. Pier 2	570+45.00	0.00	703.39	703.38
Ⓞ Pier 2	570+46.25	0.00	703.45	703.45

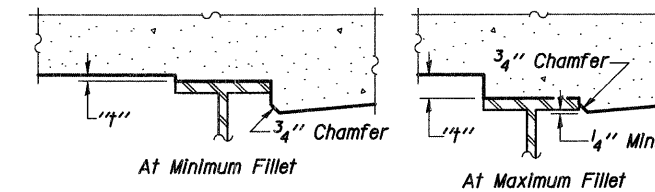
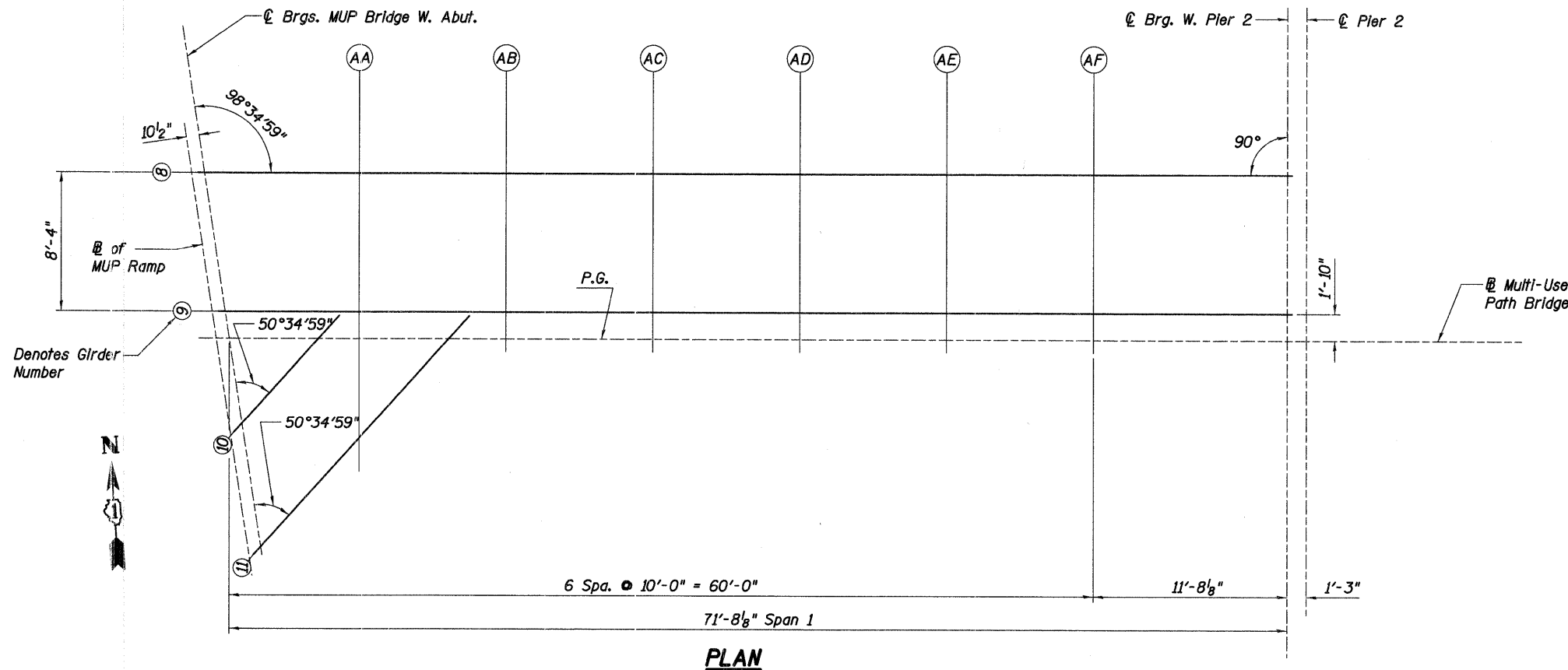

To determine "4": After all structural steel has been erected, elevations of the top flanges of the beams shall be taken at intervals shown below. These elevations subtracted from the "Theoretical Grade Elevations Adjusted for Dead Load Deflection" shown below, minus slab thickness, equals the fillet heights "4" above top flange of beams.

FILLET HEIGHTS

Girder 10

Location	Station	Offset (ft)	Theoretical Grade Elevations	Theoretical Grade Elevations Adjusted For Dead Load Deflection
Ⓜ MUP Ramp	569+73.31	-5.76	701.20	701.20
Ⓞ Brgs. W. Abut.	569+74.06	-4.92	701.21	701.21

Girder 11

Location	Station	Offset (ft)	Theoretical Grade Elevations	Theoretical Grade Elevations Adjusted For Dead Load Deflection
Ⓜ MUP Ramp	569+74.43	-13.17	701.09	701.09
Ⓞ Brgs. W. Abut.	569+75.18	-12.34	701.10	701.10
AA	569+83.32	-3.30	701.29	701.61

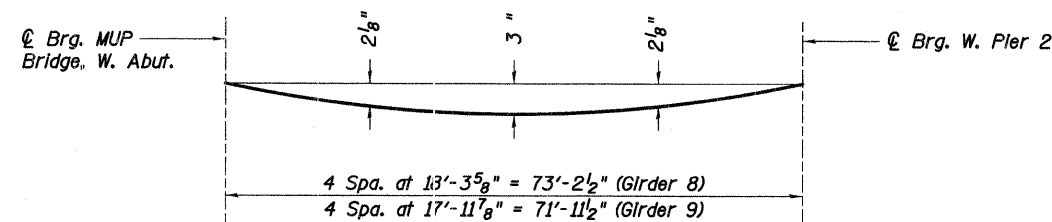

DEAD LOAD DEFLECTION DIAGRAM

(Includes weight of concrete, roof and railing)

Note: The above deflections are not to be used in the field if the engineer is working from the grade elevations adjusted for dead load deflections as shown in the tables Girder 8, Girder 9, P.G. Girder 10 and Girder 11.

REVISIONS	
NAME	DATE



ILLINOIS DEPARTMENT OF TRANSPORTATION
MUP BRIDGE -
TOP OF SLAB ELEVATIONS
 MULTI-USE PATH BRIDGE OVER THE FOX RIVER
 STRUCTURE NUMBER 045-3164
 KANE COUNTY FAP 361 SECTION 06-00214-20-BR
 STATION 572+37.71 DESIGNED: DFM DRAWN: SGW
 DATE: JANUARY 16, 2009 CHECKED: KPZ CHECKED: KPZ

h:\33005\3.0 phase 11 deliverables\3.3 structure\drawings\Final\045-3164 MUP Bridge SlabElevs.dgn 1/16/2009