

PROPOSED TREE, *CELTIS OCCIDENTALIS*
(COMMON HACKBERRY), 2-1/2" CALIPER,
BALLED AND BURLAPED

LOCATION	EACH
STA. 104+92, 39' LT.	1
STA. 107+00, 53' LT.	1
STA. 107+95, 54' LT.	1
STA. 108+45, 54' LT.	1
STA. 108+99, 54' LT.	1
STA. 109+41, 46' LT.	1
STA. 109+78, 33' LT.	1
STA. 110+20, 33' LT.	1
STA. 111+20, 33' LT.	1
STA. 105+55, 43' RT.	1
STA. 107+50, 57' RT.	1
STA. 108+00, 57' RT.	1
STA. 108+50, 57' RT.	1
STA. 109+00, 57' RT.	1
STA. 109+70, 40' RT.	1
STA. 110+34, 34' RT.	1
TOTAL	16

PROPOSED TREE, *GYMNOCLADUS DIOICUS*
(KENTUCKY COFFEETREE), 2-1/2" CALIPER,
BALLED AND BURLAPED

LOCATION	EACH
STA. 105+60, 41' LT.	1
STA. 107+70, 54' LT.	1
STA. 108+20, 54' LT.	1
STA. 108+70, 54' LT.	1
STA. 109+20, 54' LT.	1
STA. 109+41, 46' LT.	1
STA. 109+91, 30' LT.	1
STA. 110+50, 33' LT.	1
STA. 105+00, 42' RT.	1
STA. 106+05, 43' RT.	1
STA. 107+75, 57' RT.	1
STA. 108+25, 57' RT.	1
STA. 108+75, 57' RT.	1
STA. 109+35, 46' RT.	1
STA. 110+21, 35' RT.	1
STA. 110+47, 33' RT.	1
TOTAL	16

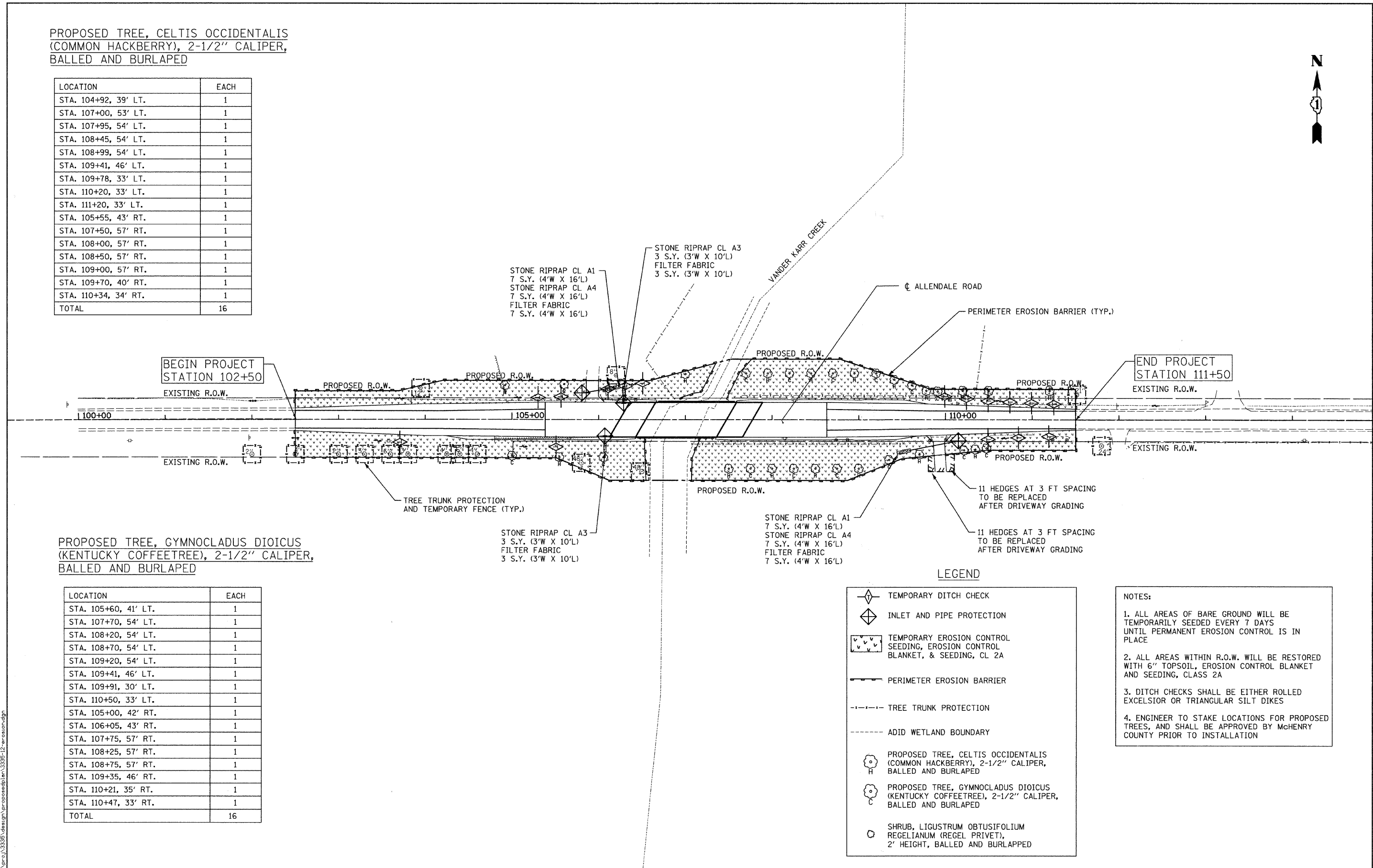

LEGEND

	TEMPORARY DITCH CHECK
	INLET AND PIPE PROTECTION
	TEMPORARY EROSION CONTROL SEEDING, EROSION CONTROL BLANKET, & SEEDING, CL 2A
	PERIMETER EROSION BARRIER
	TREE TRUNK PROTECTION
	ADID WETLAND BOUNDARY
	PROPOSED TREE, <i>CELTIS OCCIDENTALIS</i> (COMMON HACKBERRY), 2-1/2" CALIPER, BALLED AND BURLAPED
	PROPOSED TREE, <i>GYMNOCLADUS DIOICUS</i> (KENTUCKY COFFEETREE), 2-1/2" CALIPER, BALLED AND BURLAPED
	SHRUB, <i>LIGUSTRUM OBTUSIFOLIUM</i> REGELIANUM (REGEL PRIVET), 2' HEIGHT, BALLED AND BURLAPED

NOTES:

- ALL AREAS OF BARE GROUND WILL BE TEMPORARILY SEEDED EVERY 7 DAYS UNTIL PERMANENT EROSION CONTROL IS IN PLACE
- ALL AREAS WITHIN R.O.W. WILL BE RESTORED WITH 6" TOPSOIL, EROSION CONTROL BLANKET AND SEEDING, CLASS 2A
- DITCH CHECKS SHALL BE EITHER ROLLED EXCELSIOR OR TRIANGULAR SILT DIKES
- ENGINEER TO STAKE LOCATIONS FOR PROPOSED TREES, AND SHALL BE APPROVED BY McHENRY COUNTY PRIOR TO INSTALLATION

FILE NAME = nt\p\3335\design\proposed\plan\3335-12-er-rosion.dgn

Ciorba Group, Inc.
CONSULTING ENGINEERS
6507 North Cumberland Avenue, Suite 402
Chicago, Illinois 60656
Tel. 773.775.4009 Fax 773.775.4014

USER NAME = ntumbv	DESIGNED - MWR	REVISED -
PLOT SCALE = 50.0000' / IN.	DRAWN - MWR	REVISED -
PLOT DATE = 2/6/2009	CHECKED - MJL	REVISED -
DATE - 10/31/2008	REVISIONS -	REVISED -

**McHENRY COUNTY
DIVISION OF TRANSPORTATION**

**TR 73 / ALLENDALE ROAD
OVER VANDER KARR
LANDSCAPING & EROSION CONTROL PLAN**

SCALE: 1" = 50' SHEET NO. OF SHEETS STA. TO STA.

F.A. RTE.	SECTION	COUNTY	TOTAL SHEETS	SHEET NO.
73	05-00310-00-BR	McHENRY	44	12
FED. ROAD DIST. NO. - ILLINOIS FED. AID PROJECT			CONTRACT NO. 63114	