

McHENRY COUNTY  
DIVISION OF TRANSPORTATION

NORTH EDGE OF SHOULDER

Location	Station	Offset	Theoretical Grade Elevations
W. End West Appr. Pav't.	106+35.80	20 Lt.	849.86
A1	106+45.80	20 Lt.	849.91
A2	106+55.80	20 Lt.	849.97
E. End West Appr. Pav't	106+65.80	20 Lt.	850.02

NORTH EDGE OF PAVEMENT

Location	Station	Offset	Theoretical Grade Elevations
W. End West Appr. Pav't.	106+31.18	12 Lt.	850.01
A1	106+41.18	12 Lt.	850.05
A2	106+51.18	12 Lt.	850.11
E. End West Appr. Pav't	106+61.18	12 Lt.	850.16

☉ ROADWAY AND PROFILE GRADE

Location	Station	Offset	Theoretical Grade Elevations
W. End West Appr. Pav't.	106+24.25	0.00	850.16
A1	106+34.25	0.00	850.21
A2	106+44.25	0.00	850.26
E. End West Appr. Pav't	106+54.25	0.00	850.31

SOUTH EDGE OF PAVEMENT

Location	Station	Offset	Theoretical Grade Elevations
W. End West Appr. Pav't.	106+17.32	12 Rt.	849.95
A1	106+27.32	12 Rt.	849.99
A2	106+37.32	12 Rt.	850.03
E. End West Appr. Pav't	106+47.32	12 Rt.	850.09

SOUTH EDGE OF SHOULDER

Location	Station	Offset	Theoretical Grade Elevations
W. End West Appr. Pav't.	106+12.70	20 Rt.	849.77
A1	106+22.70	20 Rt.	849.80
A2	106+32.70	20 Rt.	849.85
E. End West Appr. Pav't	106+42.70	20 Rt.	849.89

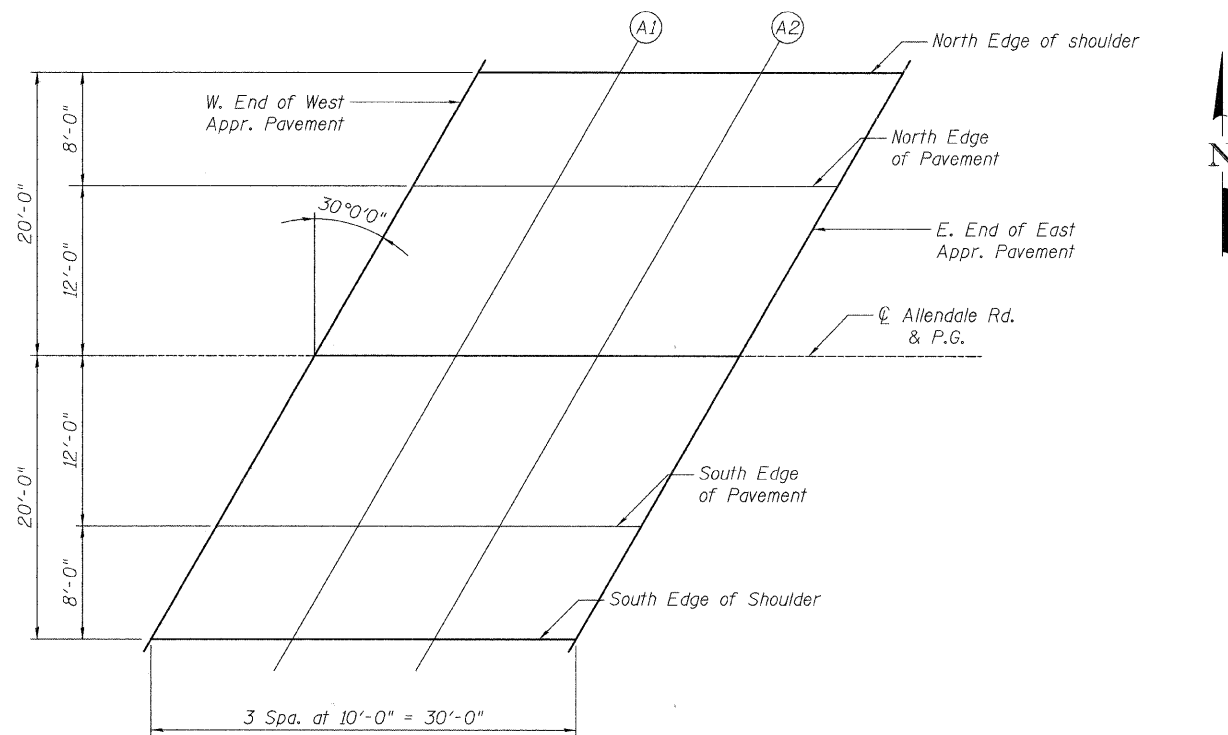

**PLAN**  
West Approach

DESIGNED	AMK
CHECKED	EKM
DRAWN	RD
CHECKED	EKM

PA-E 5-16-08



**Ciorba Group, Inc.**  
CONSULTING ENGINEERS  
5507 North Cumberland Avenue, Suite 402 Chicago, Illinois 60656  
Tel. 773.775.4009 Fax 773.775.4014 Email chicago@ciorba.com

**TOP OF WEST APPROACH  
SLAB ELEVATIONS  
STRUCTURE NO. 056-3173**

SHEET NO. S-5 OF S-20 SHEETS	F.A. RTE.	SECTION	COUNTY	TOTAL SHEETS	SHEET NO.
		05-00310-00-BR	McHENRY	44	21
			CONTRACT NO. 63114		
FED. ROAD DIST. NO.		ILLINOIS FED. AID PROJECT			

6-400000 // IN. rdanley 2/6/2009 2/6/2009 N:\PROJ\3335\Design\Structural\CAD\3335 05 Top of West Approach Slab Elevations.dgn