

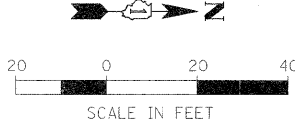

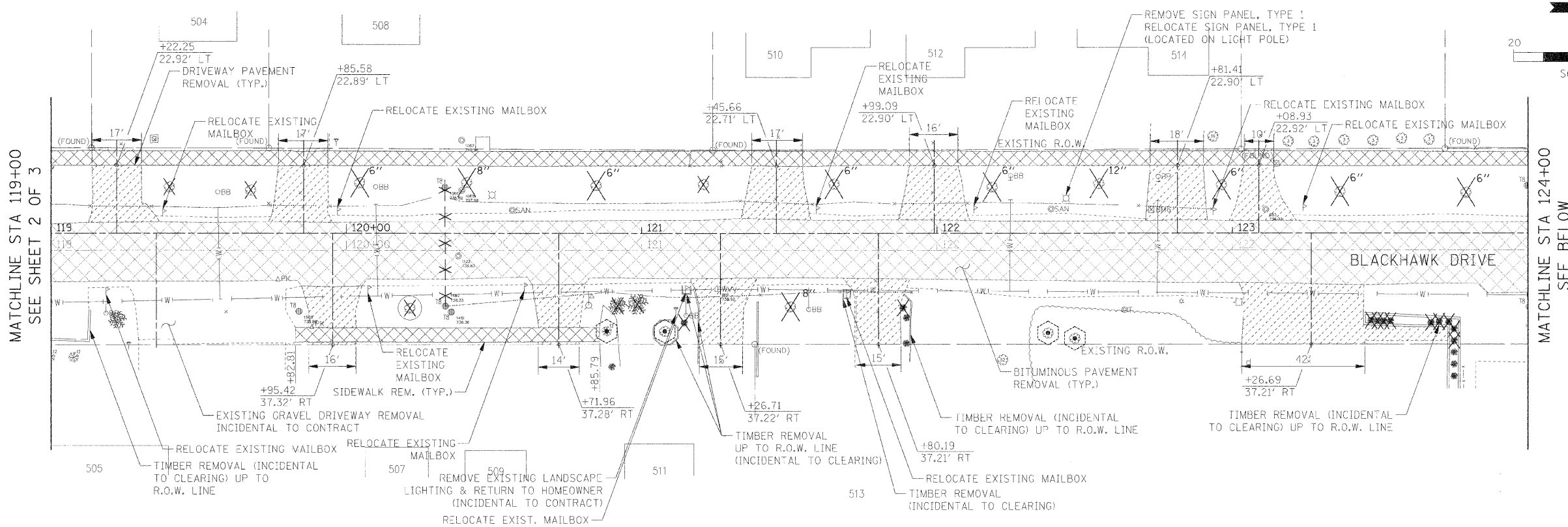

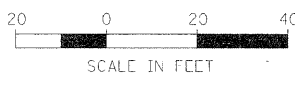

PLAN	DATE
BY	
APPROVED	
PROJECTED	
PLOTTED	
PRINTED	
CHECKED	
REVISIONS	
DATE	
BY	
DESCRIPTION	
NO.	

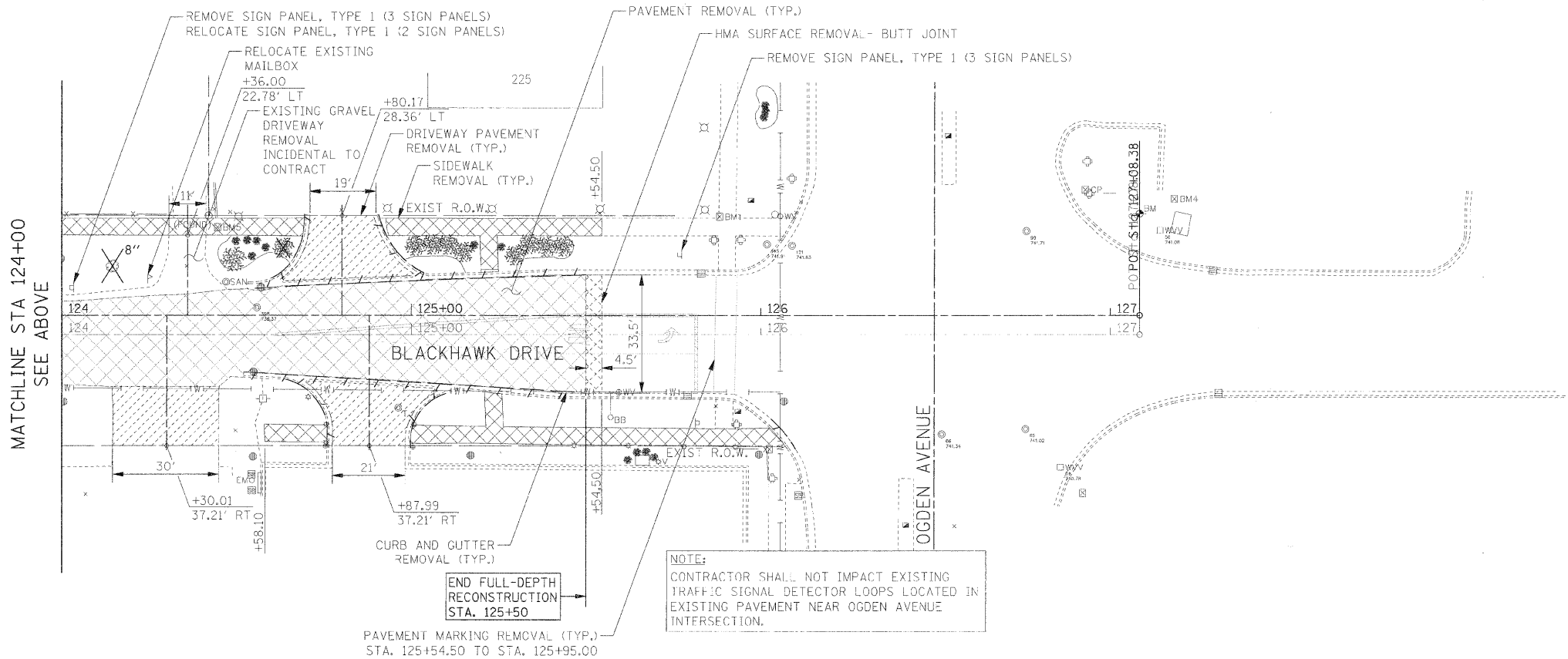

PROFILE	DATE
BY	
APPROVED	
PROJECTED	
PLOTTED	
PRINTED	
CHECKED	
REVISIONS	
DATE	
BY	
DESCRIPTION	
NO.	

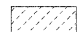
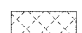
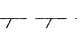

REMOVAL LEGEND:

-  PAVEMENT REMOVAL
-  SIDEWALK REMOVAL
-  DRIVEWAY PAVEMENT REMOVAL
-  HMA SURFACE REMOVAL - BUTT JOINT
-  COMBINATION CURB AND GUTTER REMOVAL
-  TREE REMOVAL
-  TREE PROTECTION
-  SAPLING (LESS THAN 6" DIA.), SHRUB, AND BUSH REMOVAL; CONSIDERED INCIDENTAL TO CLEARING

NOTE:
 CONTRACTOR SHALL NOT IMPACT EXISTING TRAFFIC SIGNAL DETECTOR LOOPS LOCATED IN EXISTING PAVEMENT NEAR OGDEN AVENUE INTERSECTION.

END FULL-DEPTH RECONSTRUCTION STA. 125+50

PAVEMENT MARKING REMOVAL (TYP.)
 STA. 125+54.50 TO STA. 125+95.00

FILE NAME = #FILE.#	USER NAME = #USER#	DESIGNED - JAB	REVISED -	STATE OF ILLINOIS DEPARTMENT OF TRANSPORTATION	ROADWAY REMOVAL PLAN	F.A.U. 3003	SECTION 00 00064 00 PV	COUNTY DUPAGE	TOTAL SHEETS 112	SHEET NO. 23		
	PLOT SCALE = #SCALE#	DRAWN - JAB	REVISED -			SCALE: 1:20	SHEET NO. 3	OF 3 SHEETS	STA. 119+00.00	TO STA. 127+08.38	BLACKHAWK DR RECONSTRUCTION	CONTRACT NO. 63121
	PLOT DATE = #DATE#	CHECKED - JMT	REVISED -			FED. ROAD DIST. NO. 1		ILLINOIS		FED. AID PROJECT		