

QUANTITY
4 (100) LINE = 64.1 ft. (19.7 m)
21.1 sq. ft. (1.97 sq. m)

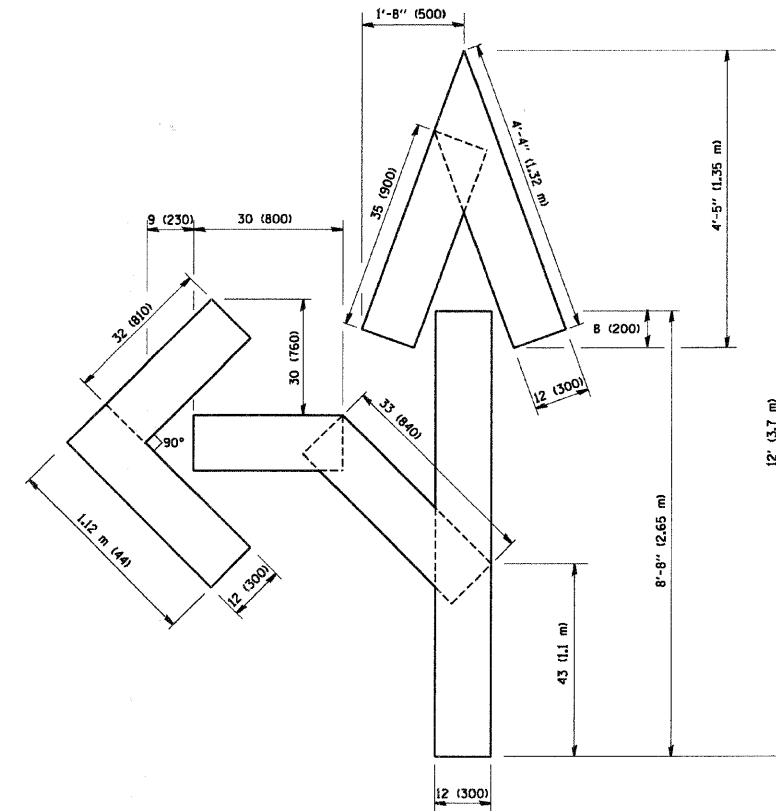

QUANTITY
4 (100) LINE = 82.5 ft. (25.3 m)
27.5 sq. ft. (2.53 sq. m)

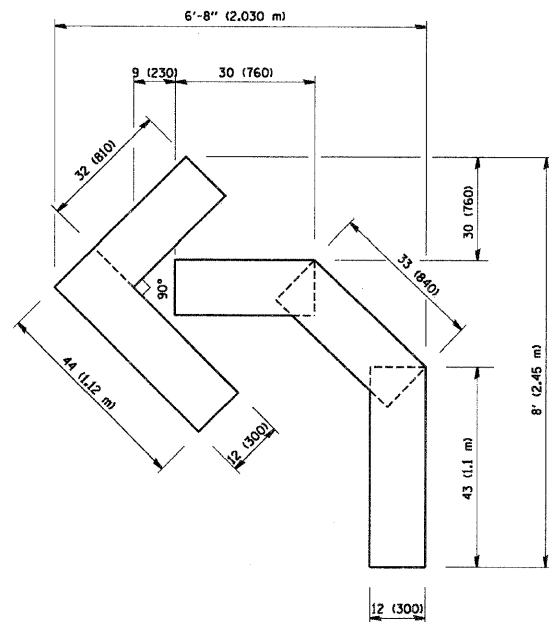

QUANTITY
4 (100) LINE = 45.5 ft. (13.9 m)
15.2 sq. ft. (1.39 sq. m)

All dimensions are in inches (millimeters) unless otherwise shown.

FILE NAME = W:\diststd\22x34\vc16.dgn	USER NAME = geglianobt	DESIGNED - DRAWN - CHECKED - DATE - 09-18-94	REVISED -T. RAMMACHER 06-05-96 REVISED -T. RAMMACHER 11-04-97 REVISED -T. RAMMACHER 03-02-98 REVISED -E. GOMEZ 08-28-00
--	---------------------------	---	--

STATE OF ILLINOIS
DEPARTMENT OF TRANSPORTATION

PAVEMENT MARKING LETTERS AND SYMBOLS
FOR TRAFFIC STAGING

F.A. RTE.	SECTION	COUNTY	TOTAL SHEETS	SHEET NO.
1462	07-00105-00-PV	COOK	49	21
FED. ROAD DIST. NO. 1 ILLINOIS FED. AID PROJECT				

SCALE: NONE SHEET NO. 1 OF 1 SHEETS STA. TO STA.

FILE NAME = N:\FORESTPARK\070081\1\NET_072001.D	USER NAME = PRAZALAN	DESIGNED - DRAWN - CHECKED - DATE -	REVISED - REVISED - REVISED - REVISED -
--	-------------------------	--	--

STATE OF ILLINOIS
DEPARTMENT OF TRANSPORTATION

CONSTRUCTION DETAILS - JACKSON BOULEVARD

F.A. RTE.	SECTION	COUNTY	TOTAL SHEETS	SHEET NO.
1462	07-00105-00-PV	COOK	49	21
FED. ROAD DIST. NO. 1 ILLINOIS FED. AID PROJECT				

SCALE: SHEET NO. OF SHEETS STA. TO STA.

CONTRACT NO. 63134