

F.A. RTE.	SECTION	COUNTY	TOTAL SHEETS	SHEET NO.
4039	08-00029-00-FP	MCHENRY	29	1
FED. ROAD DIST. NO.	ILLINOIS	CONTRACT NO. 63142		

**INDEX OF SHEETS**

- 1 COVER SHEET
- 2 GENERAL NOTES AND LIST OF STATE HIGHWAY STANDARDS
- 3 SUMMARY OF QUANTITIES
- 4 EXISTING TYPICAL SECTIONS
- 5 PROPOSED TYPICAL SECTIONS
- 6 ALIGNMENT, TIES AND BENCHMARKS
- 7-8 ROADWAY PLAN AND PROFILES
- 9 DETOUR PLANS SUGGESTED MAINTENANCE OF TRAFFIC
- 10 EROSION CONTROL PLAN
- 11-13 DRAINAGE AND UTILITY PLAN AND PROFILES
- 14 INTERSECTION GRADING PLAN
- 15 STRIPING, SIGNING AND LANDSCAPING PLAN
- 16-19 DISTRICT ONE STANDARDS
- 20-21 GENERAL DETAILS
- 22-29 CROSS SECTIONS

# VILLAGE OF LAKE IN THE HILLS PLANS FOR PROPOSED FEDERAL-AID HIGHWAY

**FAU 4039 (MILLER ROAD)  
RANDALL ROAD TO CRYSTAL LAKE ROAD  
RECONSTRUCTION**

**AND  
FAU 4038 (CRYSTAL LAKE ROAD)  
CRYSTAL LAKE ROAD TO OAK STREET  
RECONSTRUCTION**

**SECTION NO.: 08-00029-00-FP  
C-91-018-09**

**PROJECT NO.: M-9003 (081)  
VILLAGE OF LAKE IN THE HILLS  
MCHENRY COUNTY**

TRAFFIC DATA		
ADT:		
MILLER ROAD	4,200 VPD (2008)	6,000 VPD (2030)
CRYSTAL LAKE ROAD	3,000 VPD (2008)	5,000 VPD (2030)
POSTED SPEED      DESIGN SPEED		
25 MPH (EXISTING)	30 MPH (PROPOSED)	
25 MPH (PROPOSED)		

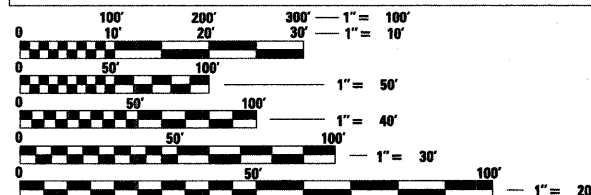

FULL SIZE PLANS HAVE BEEN PREPARED USING STANDARD ENGINEERING SCALES. REDUCED SIZED PLANS WILL NOT CONFORM TO STANDARD SCALES. IN MAKING MEASUREMENTS ON REDUCED PLANS, THE ABOVE SCALES MAY BE USED.

**J.U.L.I.E.**  
JOINT UTILITY LOCATION INFORMATION FOR EXCAVATION CALL 811



Know what's below.  
Call before you dig.

Illinois Professional Design Firm # 184-000108



**SEC Group, Inc.**  
Engineering  
Surveying  
Planning  
Landscape Architecture

McHenry • Yorkville • New Lenox • Chicago  
www.secgroupinc.com

**PROJECT ENGINEER: BENJAMIN D. HARTMAN**  
**PROJECT MANAGER: JEFFREY L. PISHA**

**CONTRACT NO. 63142**

PROJECT BEGINS  
MILLER ROAD  
STA. 32 + 86

PROJECT LOCATION MAP  
RANGE 8 EAST

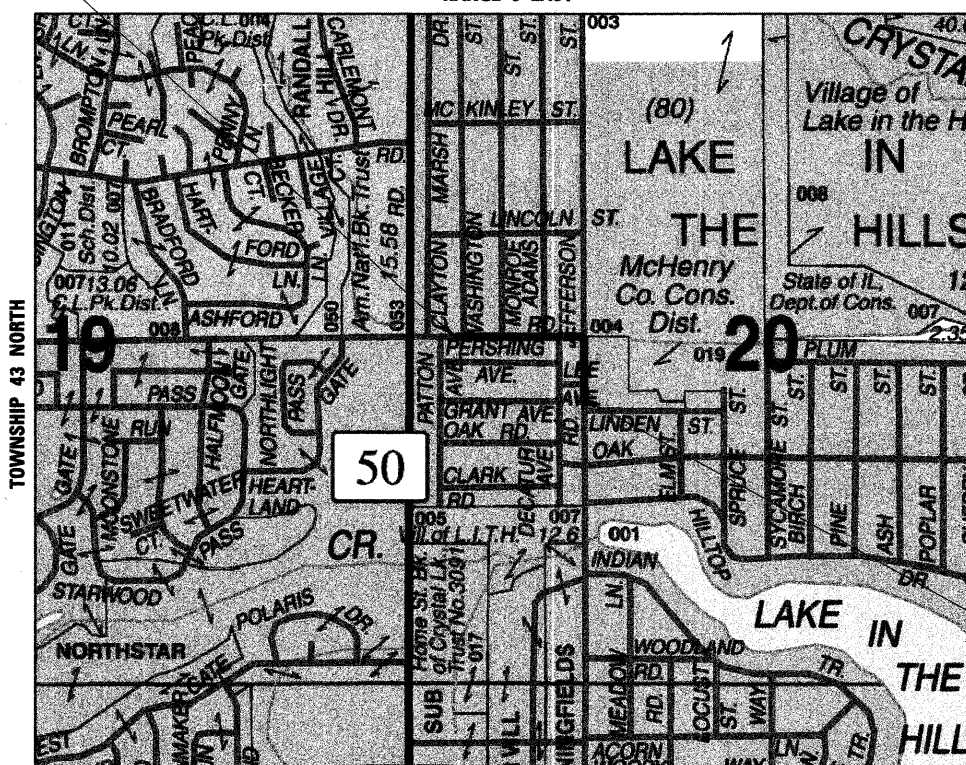

PROJECT LOCATION MAP  
N.T.S.

PROJECT LENGTH

NET LENGTH OF PROJECT (MILLER ROAD) = 1,104.13 FT (0.2091 MI)  
NET LENGTH OF PROJECT (CRYSTAL LAKE ROAD) = 610.65 FT (0.1157 MI)  
GROSS LENGTH OF PROJECT = 1,714.78 FT (0.3248 MI)

PROJECT ENDS  
CRYSTAL LAKE ROAD  
STA. 60 + 00

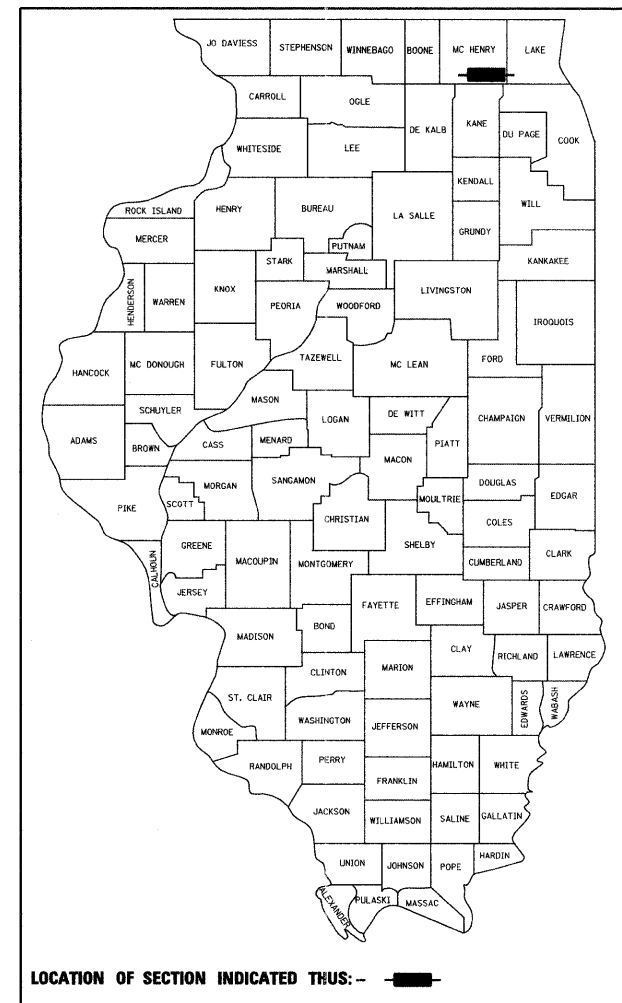

STATE OF ILLINOIS  
DEPARTMENT OF TRANSPORTATION  
DIVISION OF HIGHWAYS

APPROVED Feb. 13 20 09  
*Paul Miller*  
VILLAGE OF LAKE IN THE HILLS

PASSED FEBRUARY 10 20 09  
*Christy Christenholz*  
DISTRICT ONE ENGINEER OF LOCAL ROADS AND STREETS

RELEASING FOR BID  
BASED ON LIMITED REVIEW FEBRUARY 20, 20 09  
*Diana M. O'Keefe*  
DEPUTY DIRECTOR OF HIGHWAYS, REGION ONE ENGINEER

PROFESSIONAL ENGINEER'S SIGN & SEAL



*Jeffrey L. Pisha* 2-2009  
JEFFREY L. PISHA  
EXPIRES: 11-30-09  
SEAL

**PRINTED BY THE AUTHORITY  
OF THE STATE OF ILLINOIS**

COMPANY NAME: SEC GROUP, INC.  
 PROJECT CONTACT: J. PISHA  
 CLIENT: VILLAGE OF LAKE IN THE HILLS  
 DATE PLOTTED: 2/12/2009 9:49:02 AM  
 PLOT NUMBER: 010291-CV-09P  
 PEN TABLE: standard-trans.tbl  
 ASSOCIATE FIELD ENGINEER: KEVIN STALLWORTH, P.E. (847) 705-4169