

LEGEND:

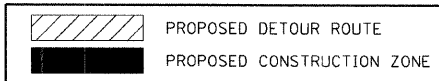

SIGN LEGEND:

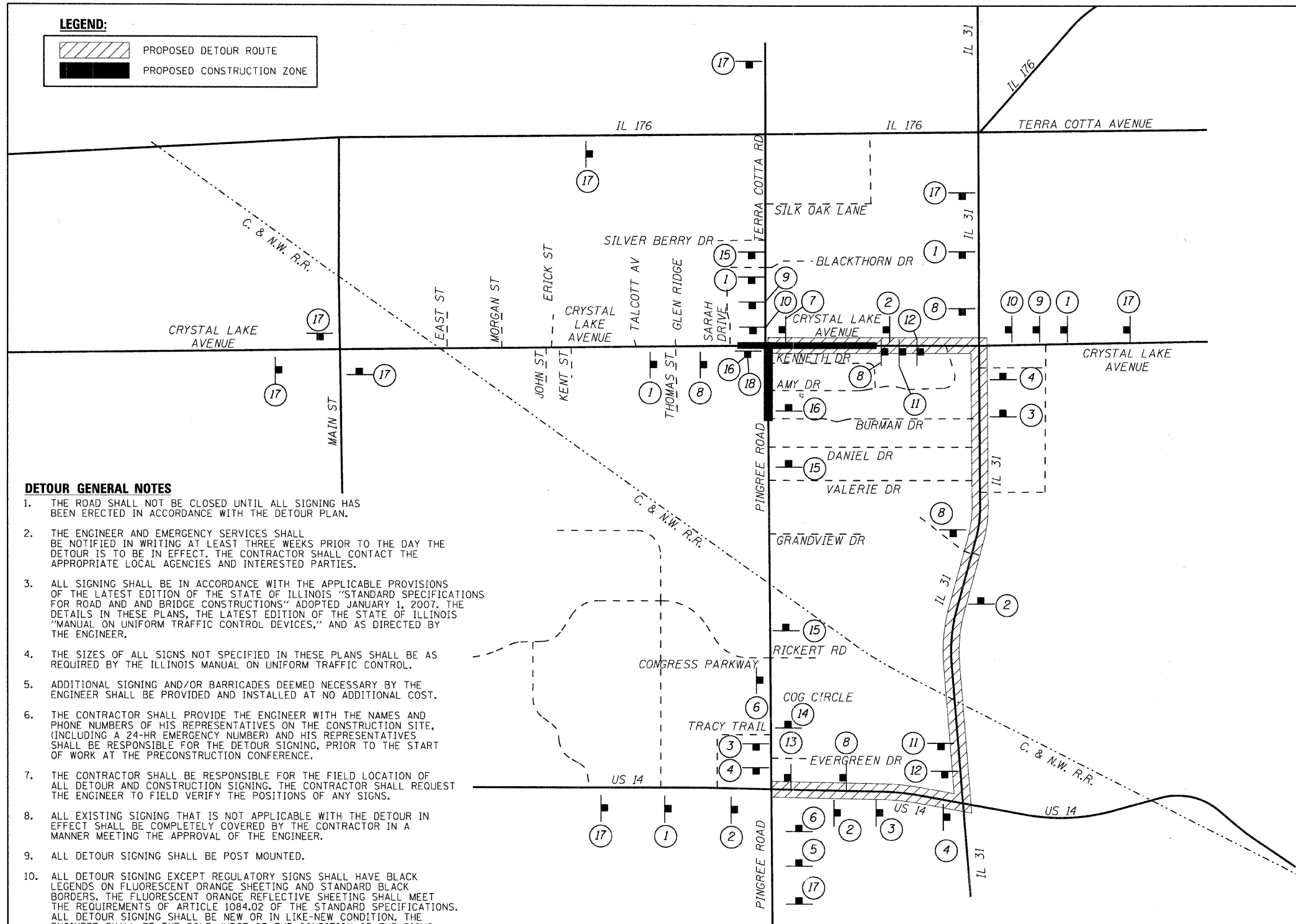
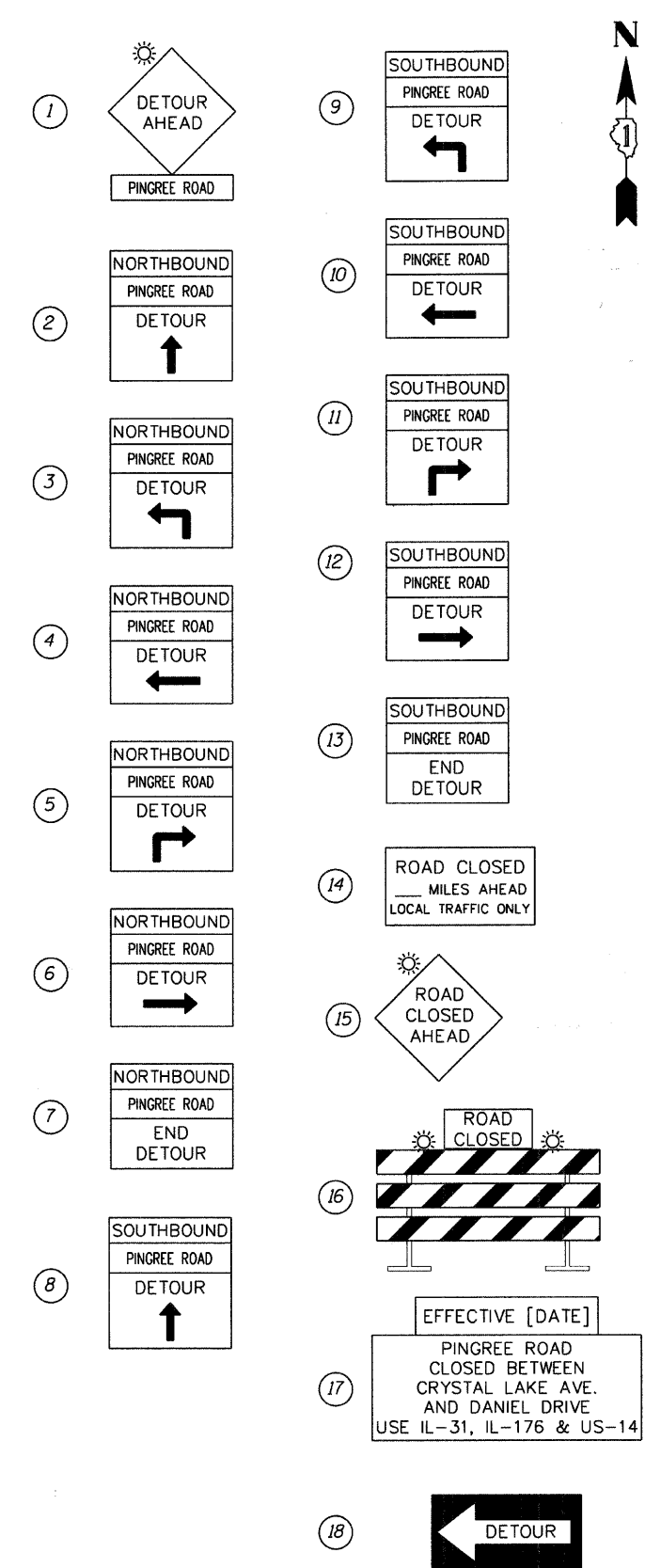

DETOUR GENERAL NOTES

1. THE ROAD SHALL NOT BE CLOSED UNTIL ALL SIGNING HAS BEEN ERECTED IN ACCORDANCE WITH THE DETOUR PLAN.
2. THE ENGINEER AND EMERGENCY SERVICES SHALL BE NOTIFIED IN WRITING AT LEAST THREE WEEKS PRIOR TO THE DAY THE DETOUR IS TO BE IN EFFECT. THE CONTRACTOR SHALL CONTACT THE APPROPRIATE LOCAL AGENCIES AND INTERESTED PARTIES.
3. ALL SIGNING SHALL BE IN ACCORDANCE WITH THE APPLICABLE PROVISIONS OF THE LATEST EDITION OF THE STATE OF ILLINOIS "STANDARD SPECIFICATIONS FOR ROAD AND AND BRIDGE CONSTRUCTIONS" ADOPTED JANUARY 1, 2007. THE DETAILS IN THESE PLANS, THE LATEST EDITION OF THE STATE OF ILLINOIS "MANUAL ON UNIFORM TRAFFIC CONTROL DEVICES," AND AS DIRECTED BY THE ENGINEER.
4. THE SIZES OF ALL SIGNS NOT SPECIFIED IN THESE PLANS SHALL BE AS REQUIRED BY THE ILLINOIS MANUAL ON UNIFORM TRAFFIC CONTROL.
5. ADDITIONAL SIGNING AND/OR BARRICADES DEEMED NECESSARY BY THE ENGINEER SHALL BE PROVIDED AND INSTALLED AT NO ADDITIONAL COST.
6. THE CONTRACTOR SHALL PROVIDE THE ENGINEER WITH THE NAMES AND PHONE NUMBERS OF HIS REPRESENTATIVES ON THE CONSTRUCTION SITE, (INCLUDING A 24-HR EMERGENCY NUMBER) AND HIS REPRESENTATIVES SHALL BE RESPONSIBLE FOR THE DETOUR SIGNING, PRIOR TO THE START OF WORK AT THE PRECONSTRUCTION CONFERENCE.
7. THE CONTRACTOR SHALL BE RESPONSIBLE FOR THE FIELD LOCATION OF ALL DETOUR AND CONSTRUCTION SIGNING. THE CONTRACTOR SHALL REQUEST THE ENGINEER TO FIELD VERIFY THE POSITIONS OF ANY SIGNS.
8. ALL EXISTING SIGNING THAT IS NOT APPLICABLE WITH THE DETOUR IN EFFECT SHALL BE COMPLETELY COVERED BY THE CONTRACTOR IN A MANNER MEETING THE APPROVAL OF THE ENGINEER.
9. ALL DETOUR SIGNING SHALL BE POST MOUNTED.
10. ALL DETOUR SIGNING EXCEPT REGULATORY SIGNS SHALL HAVE BLACK LEGENDS ON FLUORESCENT ORANGE SHEETING AND STANDARD BLACK BORDERS. THE FLUORESCENT ORANGE REFLECTIVE SHEETING SHALL MEET THE REQUIREMENTS OF ARTICLE 1084.02 OF THE STANDARD SPECIFICATIONS. ALL DETOUR SIGNING SHALL BE NEW OR IN LIKE-NEW CONDITION. THE ENGINEER SHALL BE THE SOLE JUDGE OF THE CONDITION OF THE SIGNS.
11. THE ROAD NAME SIGN SHALL BE A BLACK LEGEND ON ORANGE REFLECTIVE SHEETING. THE SIGN BLANK SHALL BE VARIABLE WITH DESIGN SERIES C LETTERS. THE CAPITAL LETTERS SHALL BE 6".
12. THE CONTRACTOR SHALL BE RESPONSIBLE FOR ENSURING THAT ALL BARRICADES, SIGNS, LIGHTS, AND OTHER DEVICES INSTALLED BY HIM ARE IN PLACE AND OPERATING 24 HOURS EACH DAY, INCLUDING SUNDAYS AND HOLIDAYS
13. THE "ROAD CLOSED" (R11-2) AND (R11-4) SIGNS SHALL BE MOUNTED ABOVE THE TOPS OF THE TYPE III BARRICADES. ALL TYPE III BARRICADES SHALL HAVE TWO AMBER TYPE A-LOW INTENSITY FLASHING LIGHTS SPACED NEAR THE CENTERLINES OF THE SUPPORTS.

DETOUR GENERAL NOTES (CONT.)

14. THE TYPE III BARRICADES USED AT POINTS OF CLOSURE TO THRU TRAFFIC ONLY SHALL NOT EXCEED 8 FEET IN WIDTH EACH FOR A SINGLE APPROACH LANE. ALL BARRICADES AT THESE LOCATIONS SHALL HAVE REFLECTORIZED STRIPING ON THE BACK SIDES OF THE BARRICADES.
15. THE CONTRACTOR SHALL BE RESPONSIBLE FOR MAINTAINING THE VISIBILITY OF ALL DETOUR AND CONSTRUCTION SIGNS, INCLUDING BRUSHING BACK VEGETATION IF DEEMED NECESSARY BY THE ENGINEER.
16. THE ENGINEER SHALL BE NOTIFIED AT LEAST 24 HOURS BEFORE THE ROAD IS TO BE REOPENED TO TRAFFIC. THE ENGINEER WILL CONTACT THE APPROPRIATE LOCAL AGENCIES AND INTERESTED PARTIES.
17. ALL WORK REQUIRED FOR DETOUR SIGNING SHALL BE PAID FOR AT THE CONTRACT UNIT PRICE FOR LUMP SUM AS "TRAFFIC CONTROL AND PROTECTION FOR TEMPORARY DETOUR."



| | | |
|------------------------|----------------|-----------|
| USER NAME = char-tke | DESIGNED - JRM | REVISED - |
| PLOT SCALE = 1" = 700' | DRAWN - JPA | REVISED - |
| PLOT DATE = 2/13/2009 | CHECKED - TCH | REVISED - |
| | DATE - 2/13/09 | REVISED - |

**MCHENRY COUNTY
DIVISION OF TRANSPORTATION**

| | |
|---|--------------------------------------|
| DETOUR PLAN - STAGE 1 PINGREE ROAD | |
| SCALE: 1" = 700' | SHEET NO. 1 OF 1 SHEETS STA. TO STA. |

| F.A. RTE. | SECTION | COUNTY | TOTAL SHEETS | SHEET NO. |
|---|----------------|---------|--------------------|-----------|
| 0116 | 08-00327-01-CH | MCHENRY | 56 | 14 |
| FED. ROAD DIST. NO. ILLINOIS FED. AID PROJECT | | | CONTRACT NO. 63144 | |