

PLAN	SURVEYED	BY	DATE
	PLOTTED		
	NOTED		
	REVISIONS		
	CAD FILE NAME		

PROFILE	SURVEYED	BY	DATE
	PLOTTED		
	NOTED		
	REVISIONS		
	STRUCTURE NOTATIONS		

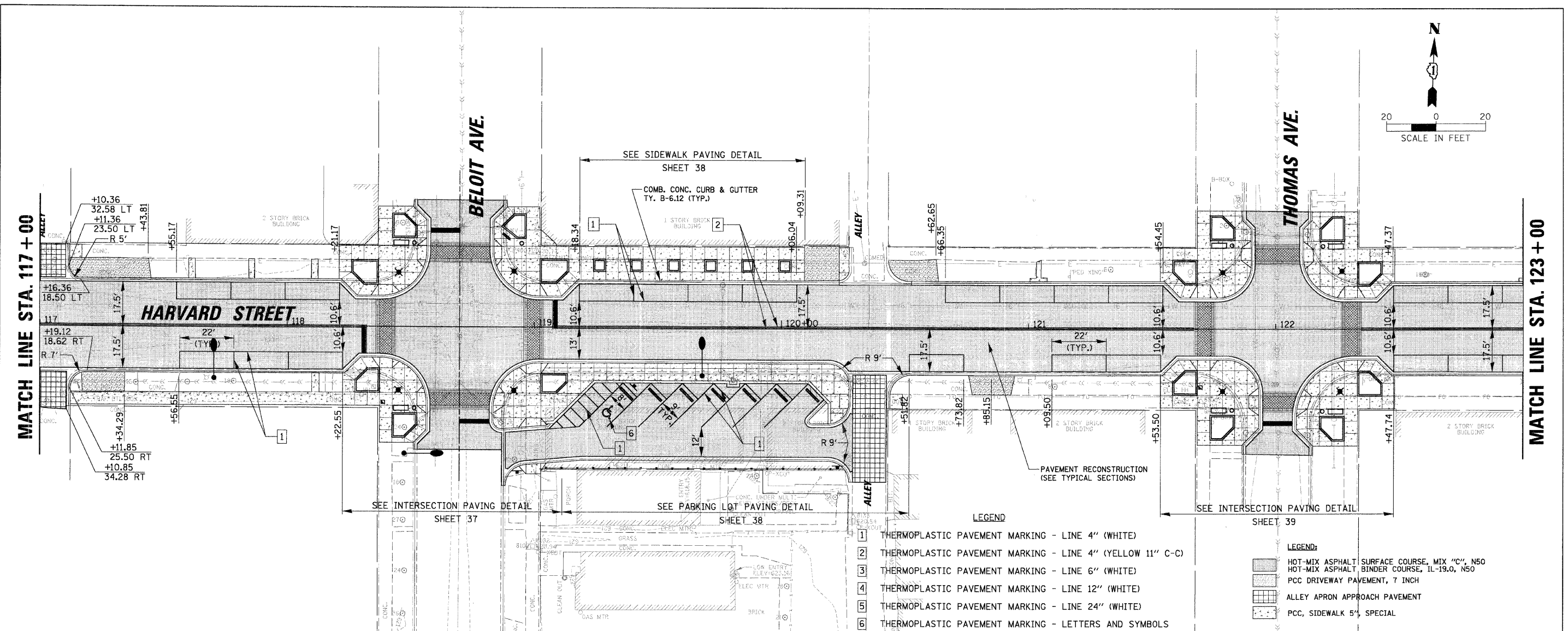

- LEGEND**
- 1 THERMOPLASTIC PAVEMENT MARKING - LINE 4" (WHITE)
  - 2 THERMOPLASTIC PAVEMENT MARKING - LINE 4" (YELLOW 11" C-C)
  - 3 THERMOPLASTIC PAVEMENT MARKING - LINE 6" (WHITE)
  - 4 THERMOPLASTIC PAVEMENT MARKING - LINE 12" (WHITE)
  - 5 THERMOPLASTIC PAVEMENT MARKING - LINE 24" (WHITE)
  - 6 THERMOPLASTIC PAVEMENT MARKING - LETTERS AND SYMBOLS
- LEGEND:**
- [Symbol] HOT-MIX ASPHALT SURFACE COURSE, MIX "C", N50
  - [Symbol] HOT-MIX ASPHALT BINDER COURSE, IL-19.0, N50
  - [Symbol] PCC DRIVEWAY PAVEMENT, 7 INCH
  - [Symbol] ALLEY APRON APPROACH PAVEMENT
  - [Symbol] PCC, SIDEWALK 5", SPECIAL

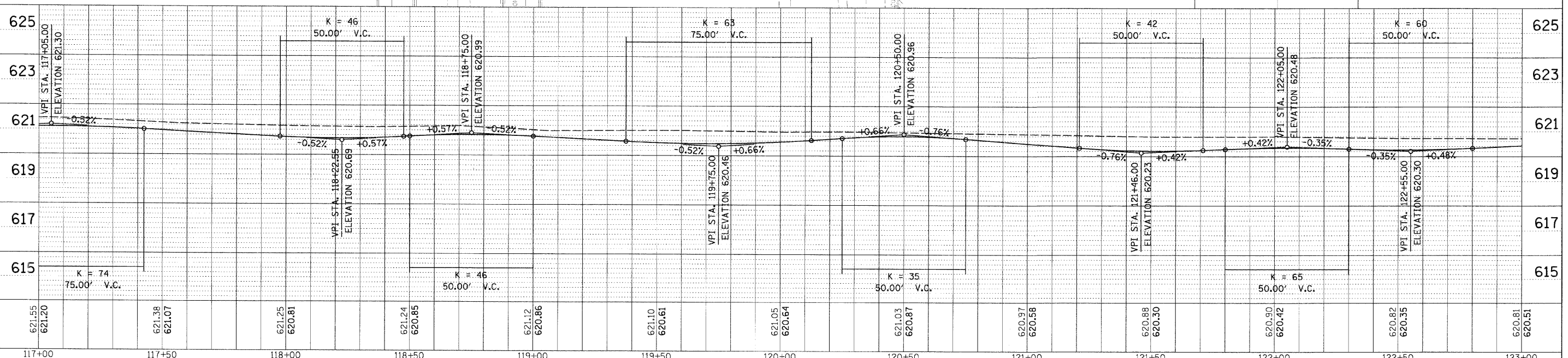

FILE NAME =	USER NAME = JBARNETT	DESIGNED -	REVISED -	<b>STATE OF ILLINOIS DEPARTMENT OF TRANSPORTATION</b>	<b>ROADWAY PLAN AND PROFILE - HARVARD STREET STA. 117+00.00 TO STA. 123+00.00</b>	F.A.U. RTE.	SECTION	COUNTY	TOTAL SHEETS	SHEET NO.	
N:\FORESTPARK\070082\Civil\RPP_070082_04.dwt		DRAWN -	REVISED -			1702	07-00106-00-PV	COOK	75	18	
PLOT SCALE = 20'		CHECKED -	REVISED -			CONTRACT NO. 63148					
PLOT DATE = 2/18/2009		DATE -	REVISED -			FED. ROAD DIST. NO. 1 ILLINOIS FED. AID PROJECT					