

IL 2 / LYNN BLVD.

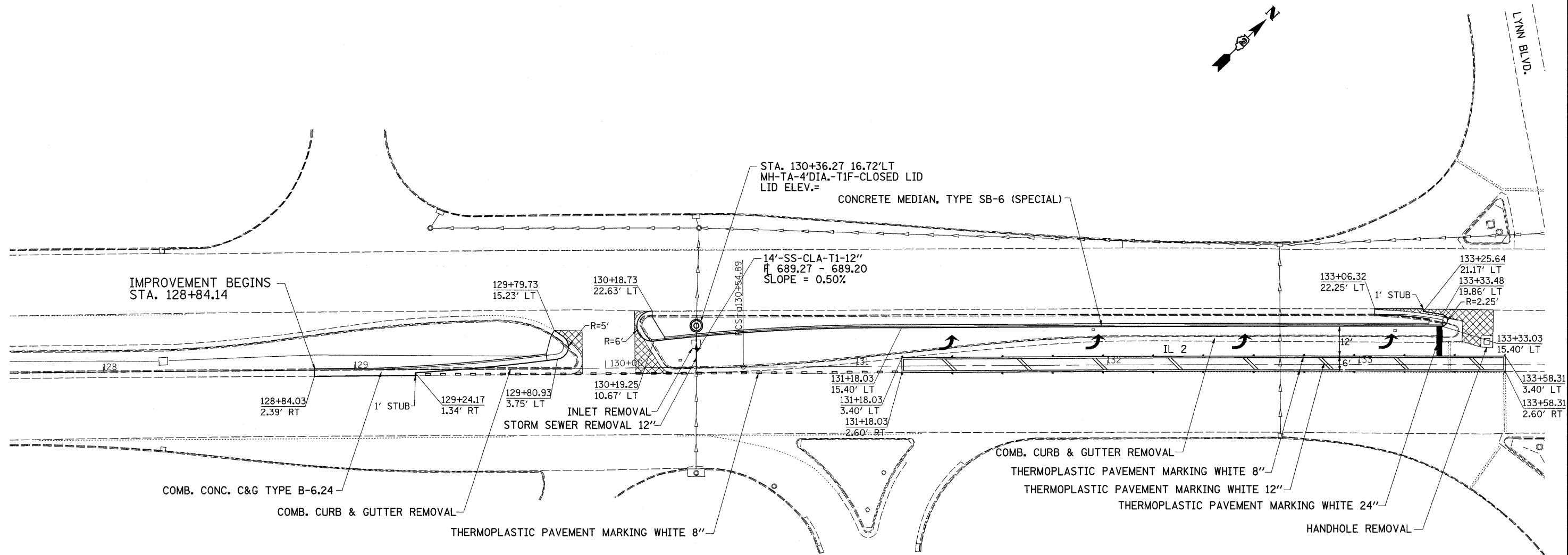

STA. 128+84 to 129+90	
EARTH EX. = 25.2	CU.YDS.
EMB. = 0	CU.YDS.
WASTE = 18.9	CU.YDS.

STA. 130+11.68 to 133+41.23	
EARTH EX. = 163.4	CU.YDS.
EMB. = 0	CU.YDS.
WASTE = 122.6	CU.YDS.

 PAVEMENT REMOVAL

FILE NAME =	USER NAME = cushmanbw	DESIGNED -	REVISED -	STATE OF ILLINOIS DEPARTMENT OF TRANSPORTATION	IL 2 / LYNN BLVD.	F.A. RTE.	SECTION	COUNTY	TOTAL SHEETS	SHEET NO.
ct:\pw\work\pwidot\cushmanbw\dms51062\0200109-sht-plan.dgn	DRAWN -	REVISED -	561			(32-4M-2)	WHITESIDE	34	13	
PLOT SCALE = 20,0000' / IN.	CHECKED -	REVISED -	CONTRACT NO. 64E58							
PLOT DATE = Fri Jan 23 06:59:41 2009	DATE -	REVISED -	FED. ROAD DIST. NO. [ILLINOIS] FED. AID PROJECT							
SCALE: SHEET NO. OF SHEETS STA. TO STA.										