

N.E. ENTRANCE RAMP  
 EXISTING CURVE DATA  
 PI STA. =44+81.60  
 $\Delta = 38^\circ 15' 58''$  (RT)  
 $D = 7^\circ 27' 19''$   
 $R = 768.52'$   
 $T = 266.62'$   
 $L = 513.27'$   
 $E = 44.94'$   
 $e =$  ----  
 T.R. = ----  
 S.E. RUN = ----  
 P.C. STA. =42+14.97  
 P.T. STA. =47+28.25

N.E. ENTRANCE RAMP  
 PROPOSED CURVE DATA  
 PI STA. =44+76.66  
 $\Delta = 38^\circ 26' 31''$  (RT)  
 $D = 4^\circ 45' 17''$   
 $R = 1,205.00'$   
 $T = 420.12'$   
 $L = 808.48'$   
 $E = 71.14'$   
 $S.E. = 0.08'/'$   
 T.R. = N/A  
 S.E. RUN = 285'  
 P.C. STA. =40+56.54  
 P.T. STA. =48+65.02  
 STA 38+66.54 BEGIN S.E. TRANS  
 STA 41+51.54 FULL S.E.  
 STA 47+35.02 END FULL S.E.

PLAN	SURVEYED	BY	DATE
	PLOTTED		
	NOTED		
	REVISIONS		
	NO.		

PROFILE	SURVEYED	BY	DATE
	PLOTTED		
	NOTED		
	REVISIONS		
	NO.		

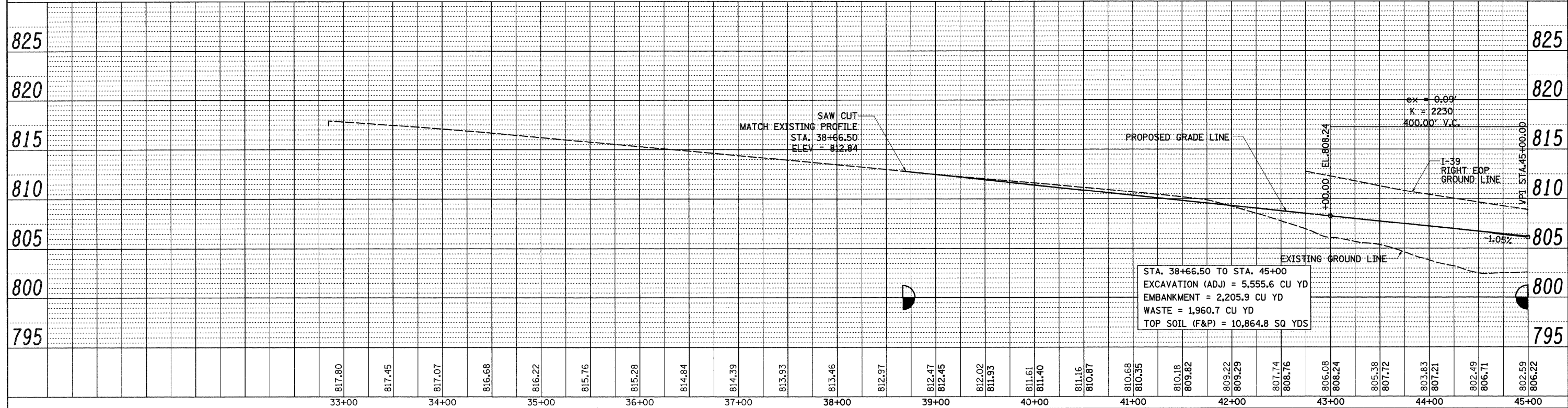
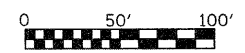
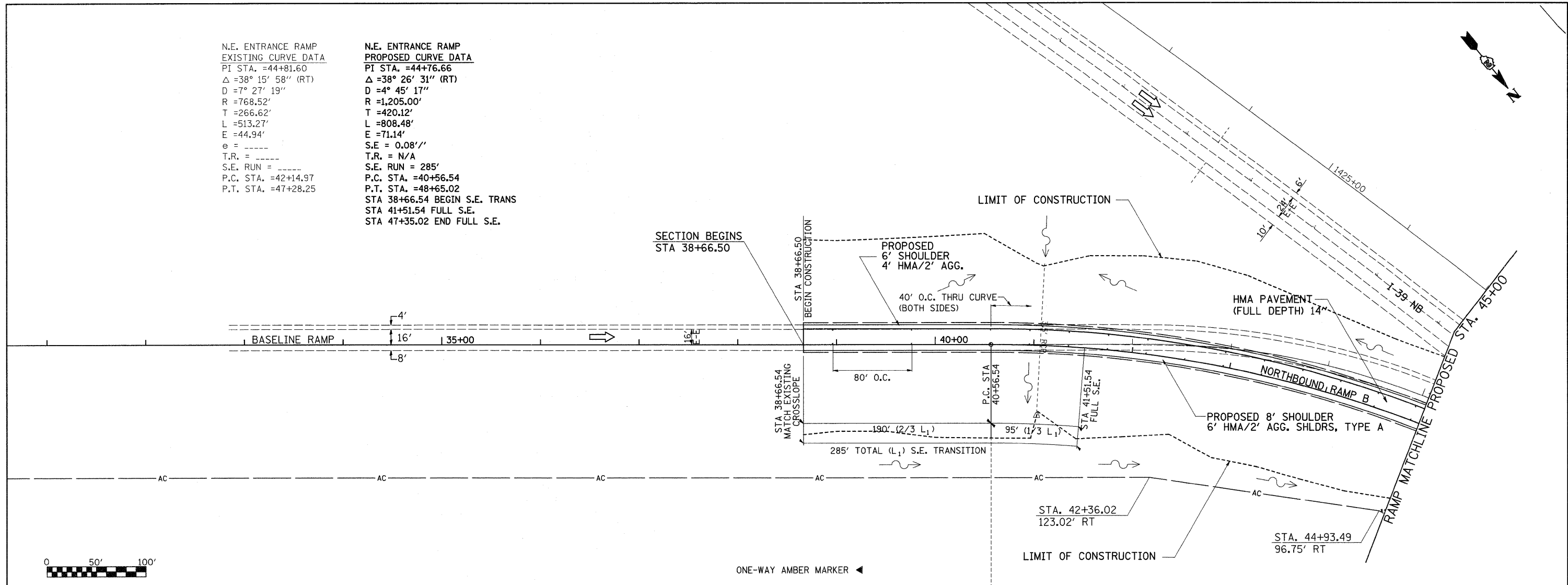

FILE NAME =	USER NAME = stringerjm	DESIGNED -	REVISED -	<b>STATE OF ILLINOIS DEPARTMENT OF TRANSPORTATION</b>	<b>PLAN &amp; PROFILE FOR THE NORTHBOUND ENTRANCE RAMP TO I-39 FROM I-88</b>			F.A.I. RTE.	SECTION	COUNTY	TOTAL SHEETS	SHEET NO.
ca:\pwwork\p\j\01\STRINGERJM\dms84027\020309-plan_shts.dgn		DRAWN -	REVISED -		SCALE: 1"=50'-0"	SHEET NO. 20 OF 82 SHEETS	STA. 33+00 TO STA. 45+00	39	(141-1)M-1	OGLE	82	20
		CHECKED -	REVISED -					CONTRACT NO. 64E60				
		DATE	REVISED -					FED. ROAD DIST. NO. ILLINOIS FED. AID PROJECT				