

F.A.I. RTE.	SECTION	COUNTY	TOTAL SHEETS	SHEET NO.
39	(201-2HB)M-1	WINNEBAGO	11	1
		ILLINOIS	CONTRACT NO. 64E96	

**INDEX OF SHEETS**

1. Cover Sheet, Index of Sheets, Standards
2. Summary of Quantities
3. General Notes
4. General Plan & Elevation
5. Details

**STANDARDS**

- 701101-02
- 701400-03
- 701401-05
- 701901-01
- 720001-01
- 720006-02
- 720011-01
- 729001-01

**STATE OF ILLINOIS**  
**DEPARTMENT OF TRANSPORTATION**  
**DIVISION OF HIGHWAYS**

**PROPOSED**  
**HIGHWAY PLANS**

**FAI ROUTE 39 (I-39)**  
**SECTION (201-2HB)M-1**  
**BRIDGE REPAIR**  
**WINNEBAGO COUNTY**

D-92-057-09

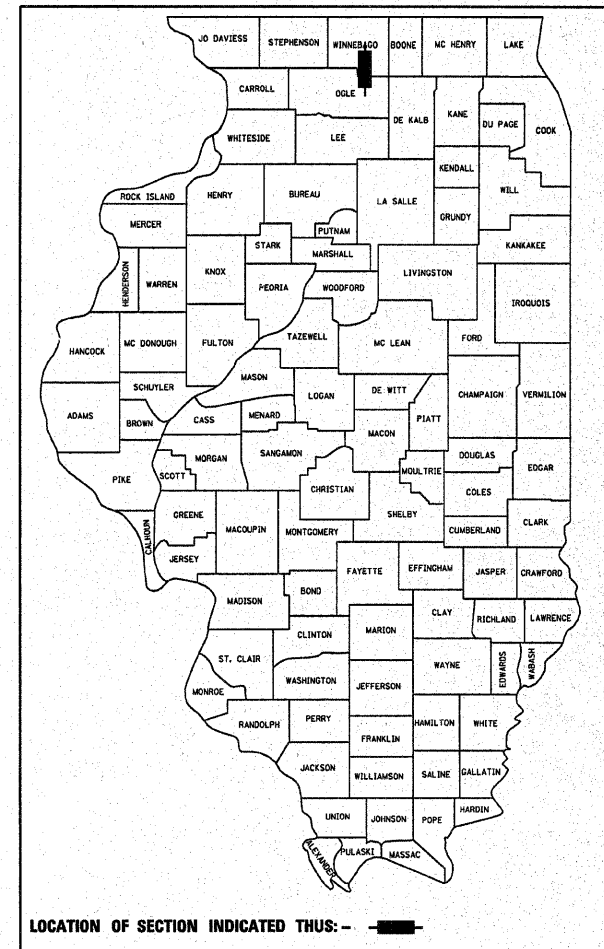

Project Location  
Structures 101-0142 (SB) & 101-0143 (NB)

C-92-093-09

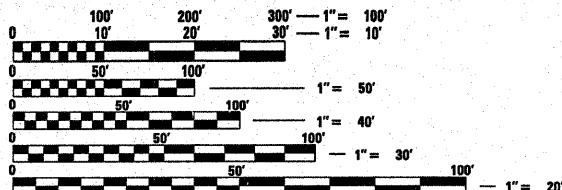
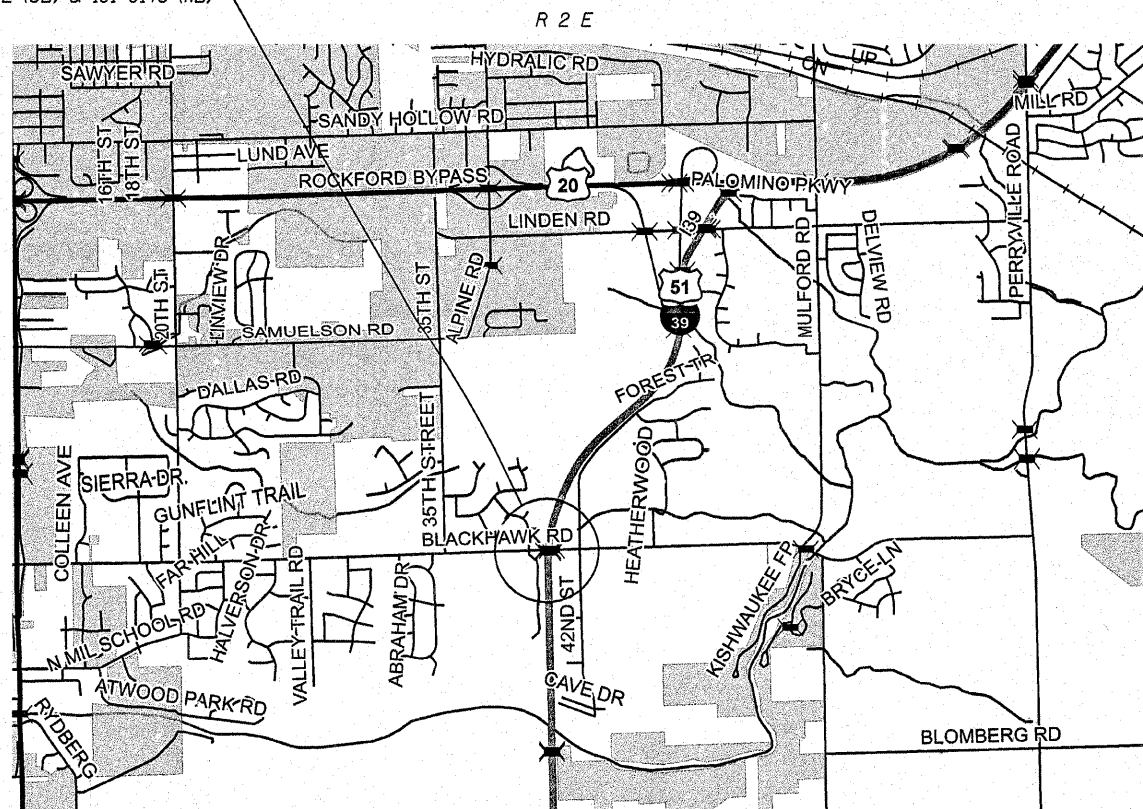

FULL SIZE PLANS HAVE BEEN PREPARED USING STANDARD ENGINEERING SCALES. REDUCED SIZED PLANS WILL NOT CONFORM TO STANDARD SCALES. IN MAKING MEASUREMENTS ON REDUCED PLANS, THE ABOVE SCALES MAY BE USED.

J.U.L.I.E.  
JOINT UTILITY LOCATION INFORMATION FOR EXCAVATION  
1-800-892-0123  
OR 811

PROJECT ENGINEER: MAHMOUD ETEMADI 815/284-5393

GROSS LENGTH = 450 FT. = 0.085 MILE  
NET LENGTH = 450 FT. = 0.085 MILE

CONTRACT NO. 64E96

STATE OF ILLINOIS  
DEPARTMENT OF TRANSPORTATION  
DIVISION OF HIGHWAYS

SUBMITTED Jan 23 2009  
George F. Ryan  
DEPUTY DIRECTOR OF HIGHWAYS, REGION ENGINEER

March 27 2009  
Charles G. Ingersoll  
ENGINEER OF DESIGN AND ENVIRONMENT

March 27 2009  
Christine M. Reed  
DIRECTOR OF HIGHWAYS, CHIEF ENGINEER

**PRINTED BY THE AUTHORITY**  
**OF THE STATE OF ILLINOIS**