

F.A. RTE.	SECTION	COUNTY	TOTAL SHEETS	SHEET NO.
**	**	KANKAKEE	109	19
STA. TO STA.		ILLINOIS FED. AID PROJECT		
FED. ROAD DIST. NO.		FED. AID PROJECT		

LEGEND

- HOT-MIX ASPHALT SURFACE REMOVAL - BUTT JOINT OR PCC SURFACE REMOVAL - BUTT JOINT
- PAVEMENT REMOVAL
- PAVEMENT WIDENING

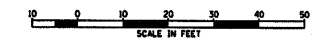

FAU ROUTE 6176 (ARMOUR ROAD)
SECTION (79)W&RS & 140RS

DATE	BY	REVISION
11/02	CHAMIN	1.00
07/03	CHAMIN	1.01
07/03	CHAMIN	1.02
07/03	CHAMIN	1.03
07/03	CHAMIN	1.04
07/03	CHAMIN	1.05
07/03	CHAMIN	1.06
07/03	CHAMIN	1.07
07/03	CHAMIN	1.08
07/03	CHAMIN	1.09
07/03	CHAMIN	1.10
07/03	CHAMIN	1.11
07/03	CHAMIN	1.12
07/03	CHAMIN	1.13
07/03	CHAMIN	1.14
07/03	CHAMIN	1.15
07/03	CHAMIN	1.16
07/03	CHAMIN	1.17
07/03	CHAMIN	1.18
07/03	CHAMIN	1.19
07/03	CHAMIN	1.20

DATE	BY	REVISION
11/02	CHAMIN	1.00
07/03	CHAMIN	1.01
07/03	CHAMIN	1.02
07/03	CHAMIN	1.03
07/03	CHAMIN	1.04
07/03	CHAMIN	1.05
07/03	CHAMIN	1.06
07/03	CHAMIN	1.07
07/03	CHAMIN	1.08
07/03	CHAMIN	1.09
07/03	CHAMIN	1.10
07/03	CHAMIN	1.11
07/03	CHAMIN	1.12
07/03	CHAMIN	1.13
07/03	CHAMIN	1.14
07/03	CHAMIN	1.15
07/03	CHAMIN	1.16
07/03	CHAMIN	1.17
07/03	CHAMIN	1.18
07/03	CHAMIN	1.19
07/03	CHAMIN	1.20

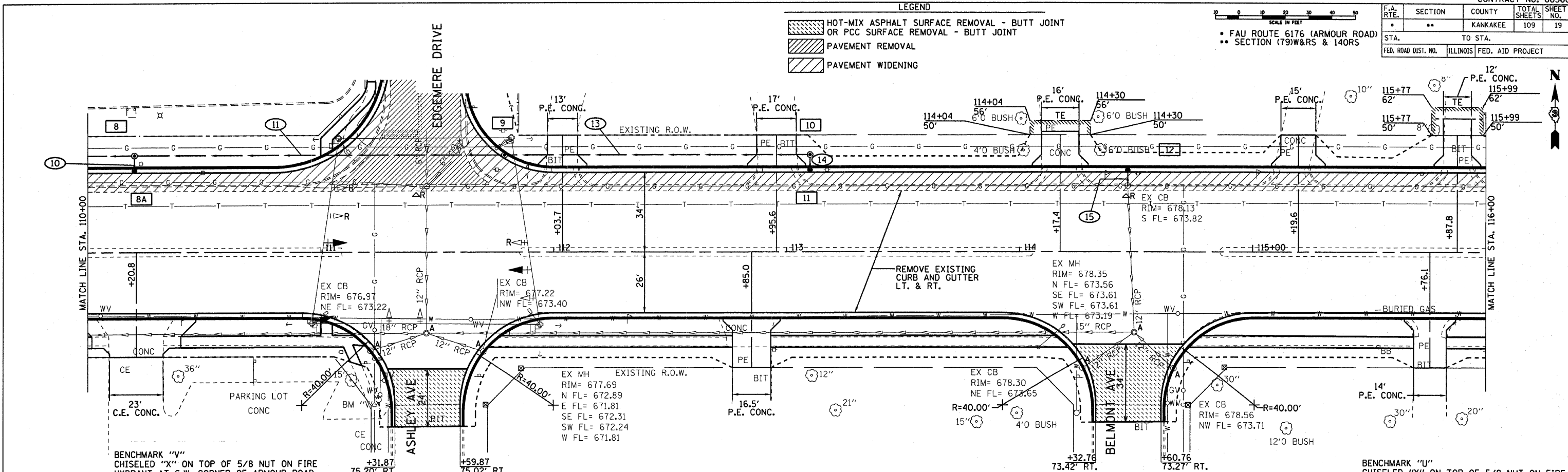

BENCHMARK "V"
CHISELED "X" ON TOP OF 5/8 NUT ON FIRE HYDRANT AT S.W. CORNER OF ARMOUR ROAD AND ASHLEY AVENUE ELEV. 680.59

BENCHMARK "U"
CHISELED "X" ON TOP OF 5/8 NUT ON FIRE HYDRANT AT S.W. CORNER OF ARMOUR ROAD AND BELMONT AVENUE ELEV. 682.09

STRUCTURE NO.	8	8A	9	10	11	12	--	--	--	STRUCTURE NO.
STA	110+20.0	110+20	111+78.8	113+10.0	113+10.0	114+46.4	--	--	--	STA
OFFSET	41.6 LT	34.0 LT	41.6 LT	41.6 LT	34.0 LT	34.0 LT	--	--	--	OFFSET
STRUCTURE TYPE	MH TA 5	CB-C	MH TA 5	MH TA 5	CB-C	CB-C	--	--	--	STRUCTURE TYPE
F&G TYPE	1 CL	3	3	1 CL	3	3	--	--	--	F&G TYPE
RIM ELEVATION	677.60	677.10	677.47	678.40	677.91	678.26	--	--	--	RIM ELEVATION
EAST INVERT	671.04	--	671.68	--	--	--	--	--	--	EAST INVERT
WEST INVERT	671.04	--	671.68	672.20	--	--	--	--	--	WEST INVERT
NORTH INVERT	--	674.10	--	--	674.89	--	--	--	--	NORTH INVERT
SOUTH INVERT	674.07	--	--	674.86	--	673.85	--	--	--	SOUTH INVERT
PIPE NUMBER	10	11	13	14	15	--	--	--	--	PIPE NUMBER
SIZE	12"	24"	24"	12"	12"	--	--	--	--	SIZE
LENGTH	7'	159'	131'	7'	7'	--	--	--	--	LENGTH
CLASS	A	A (RG)	A (RG)	A	A	--	--	--	--	CLASS
TYPE	1	2	2	1	2	--	--	--	--	TYPE
% SLOPE	0.40%	0.40%	0.40%	0.40%	0.42%	--	--	--	--	% SLOPE
T.B.	--	36.4	48.9	--	2.1	--	--	--	--	T.B.

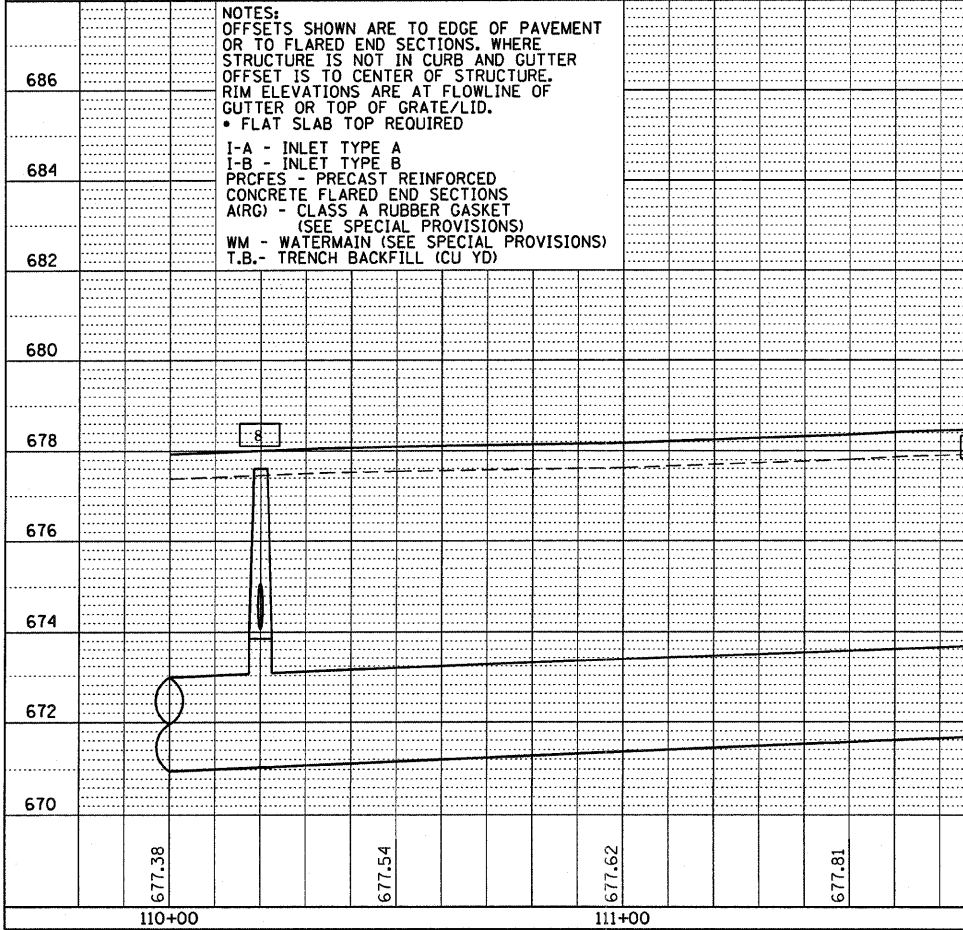

EXISTING PROFILE 2.5' NORTH OF TRANSIT LINE

NOTE: PROPOSED PROFILE GRADE IS INTENDED TO BE 0.75' HIGHER THAN EXISTING TOP OF CONCRETE AT RIGHT EDGE OF PAVEMENT STA. 104+51 TO STA. 143+70

PROPOSED PROFILE GRADE AT TRANSIT LINE