

**STRUCTURE 026-0032**

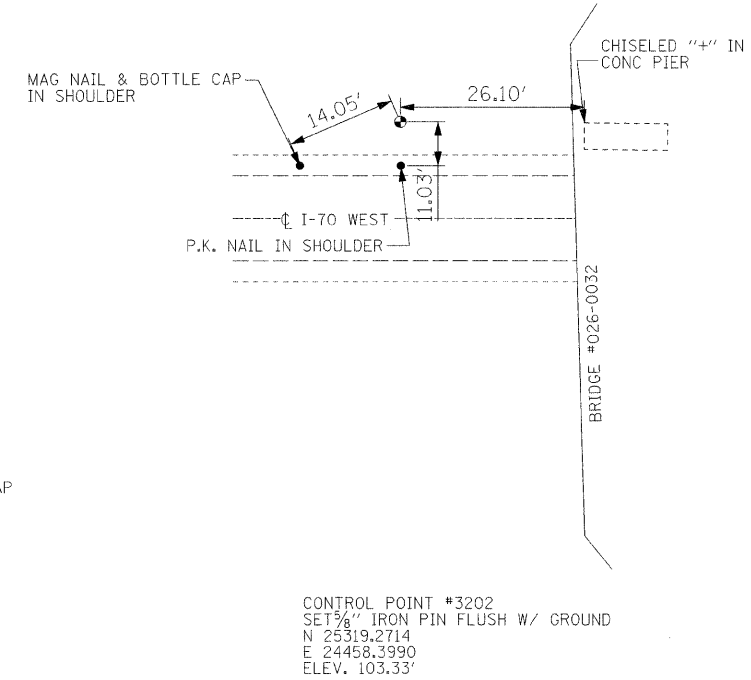
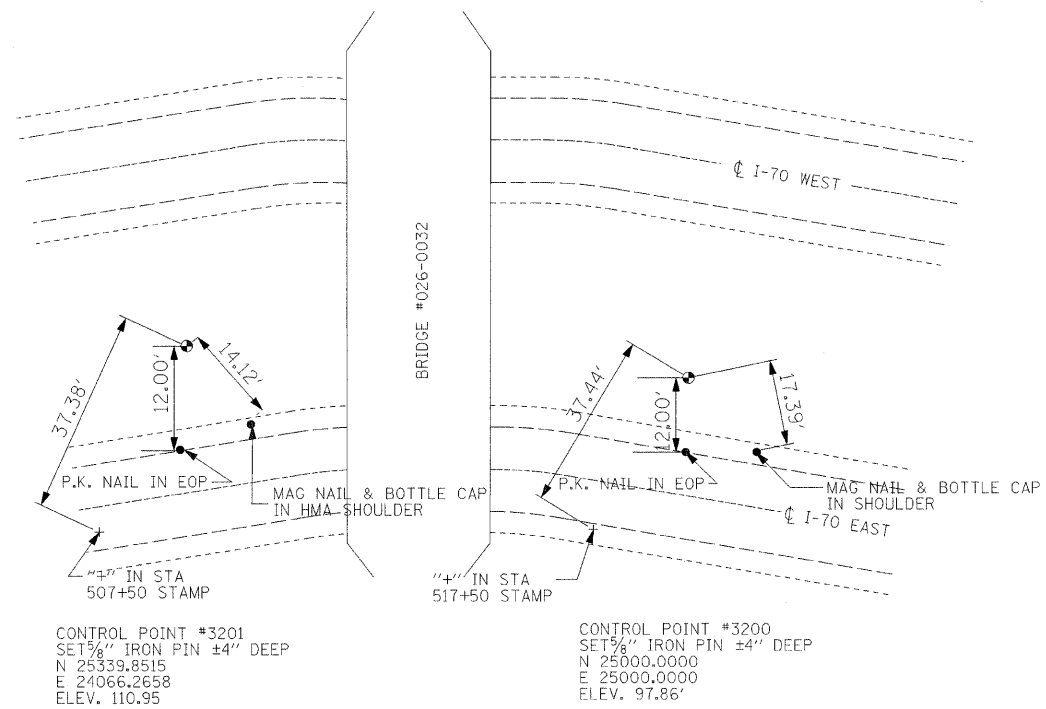

CONTROL POINT #3201  
 SET 5/8" IRON PIN ±4" DEEP  
 N 25339.8515  
 E 24066.2658  
 ELEV. 110.95'

CONTROL POINT #3200  
 SET 5/8" IRON PIN ±4" DEEP  
 N 25000.0000  
 E 25000.0000  
 ELEV. 97.86'

CONTROL POINT #3202  
 SET 5/8" IRON PIN FLUSH W/ GROUND  
 N 25319.2714  
 E 24458.3990  
 ELEV. 103.33'

**STRUCTURE 026-0049**

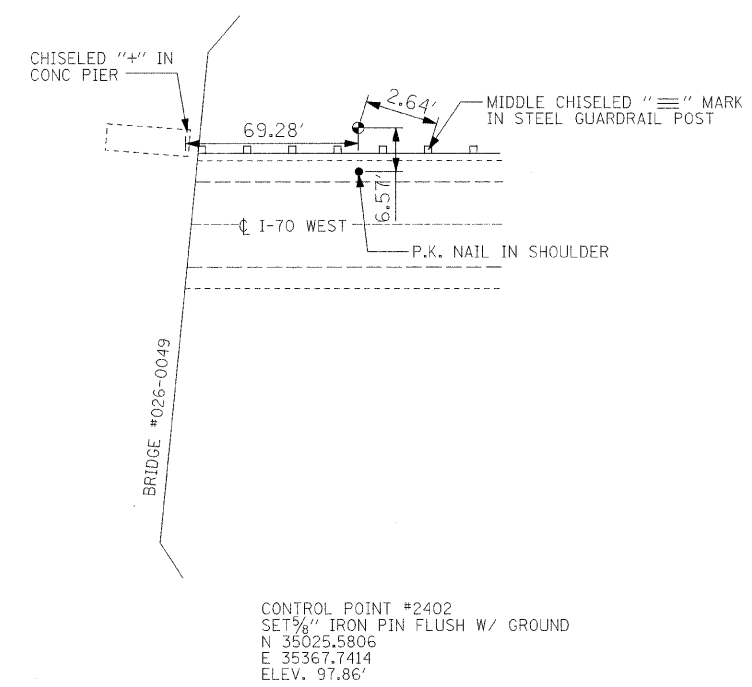
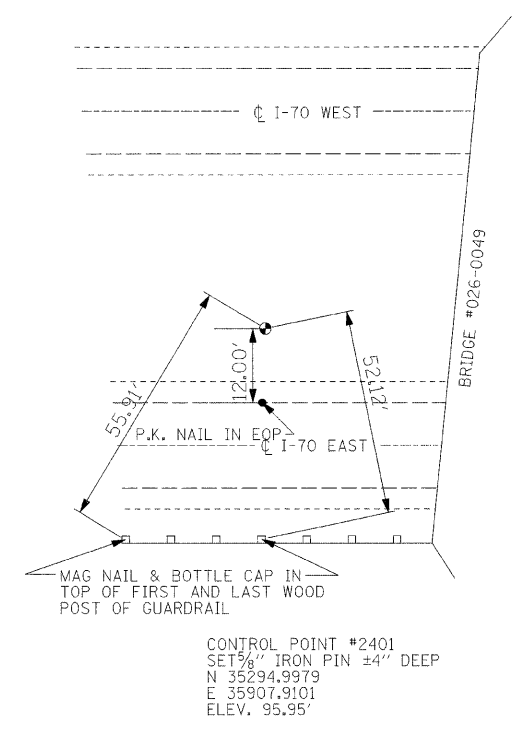
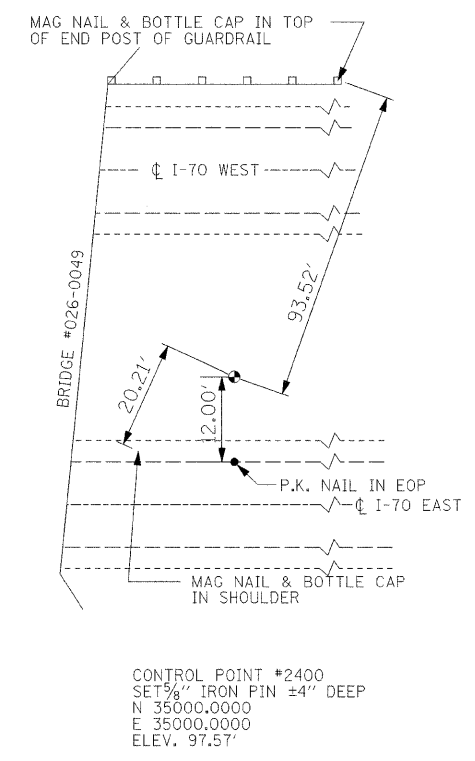

CONTROL POINT #2400  
 SET 5/8" IRON PIN ±4" DEEP  
 N 35000.0000  
 E 35000.0000  
 ELEV. 97.57'

CONTROL POINT #2401  
 SET 5/8" IRON PIN ±4" DEEP  
 N 35294.9979  
 E 35907.9101  
 ELEV. 95.95'

CONTROL POINT #2402  
 SET 5/8" IRON PIN FLUSH W/ GROUND  
 N 35025.5806  
 E 35367.7414  
 ELEV. 97.86'

|   |                             |            |           |
|---|-----------------------------|------------|-----------|
| FILE NAME =                               | USER NAME = swartzw         | DESIGNED - | REVISED - |
| ct:\pw\work\pwsdot\swartzw\dms50728\sh... | sp20_74313.dgn              | DRAWN -    | REVISED - |
|   | PLOT SCALE = 20,0000' / IN. | CHECKED -  | REVISED - |
|   | PLOT DATE = 1/28/2009       | DATE -     | REVISED - |

**STATE OF ILLINOIS  
 DEPARTMENT OF TRANSPORTATION**

| TIE POINT DETAILS |                         |      |         |
|-------------------|-------------------------|------|---------|
| SCALE: NA         | SHEET NO. 1 OF 7 SHEETS | STA. | TO STA. |

|   |                   |         |              |           |
|---|-------------------|---------|--------------|-----------|
| F.A.I. RTE.                                   | SECTION           | COUNTY  | TOTAL SHEETS | SHEET NO. |
| 70  | D-7 SAFETY 2009-1 | FAYETTE | 100          | 8         |
| CONTRACT NO. 74313                            |                   |         |              |           |
| FED. ROAD DIST. NO. ILLINOIS FED. AID PROJECT |                   |         |              |           |