

F.A.P. RTE.	SECTION	COUNTY	TOTAL SHEETS	SHEET NO.
310	60-15-2 60-15HB-2	MADISON	272	32
STA.		TO STA.		
FED. ROAD DIST. NO.		ILLINOIS FED. AID PROJECT		
CONTRACT NO. 76624				

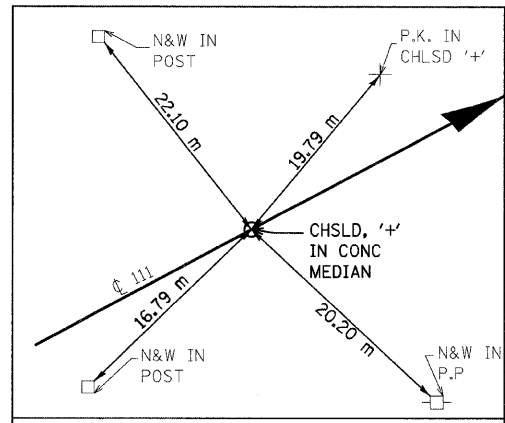

IL 111 POT STA 29+828.458  
N 255,615.1753 E 697,935.4380

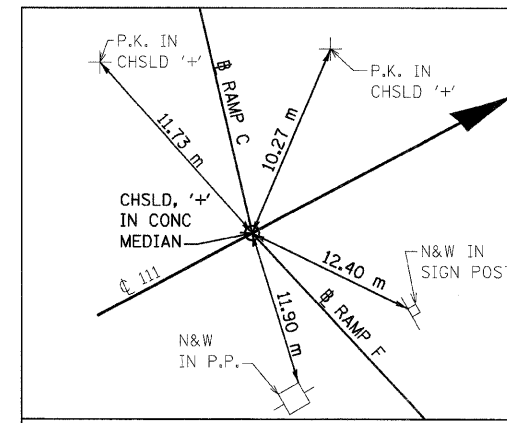

IL 111 @ RAMP F & RAMP C  
POT STA 29+857.028  
N 255,628.6235 E 697,960.6452

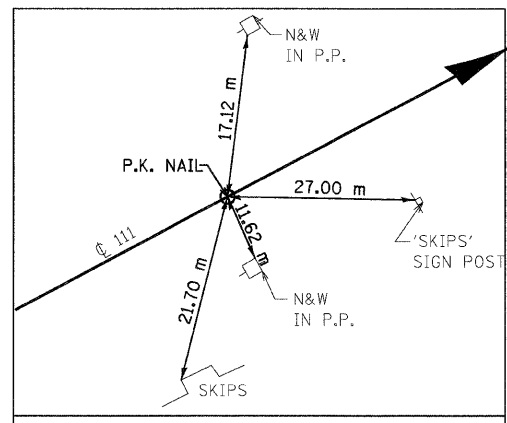

IL 111 @ FAP 310  
POT STA 30+000.000  
N 255,695.9215 E 698,086.7876

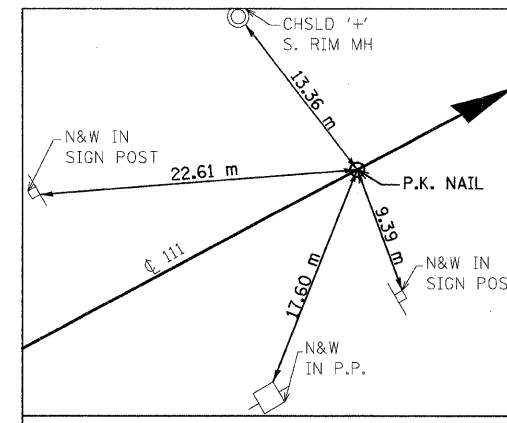

IL 111 @ RAMP E & RAMP D  
POT STA 30+097.336  
N 255,741.7385 E 698,172.6663

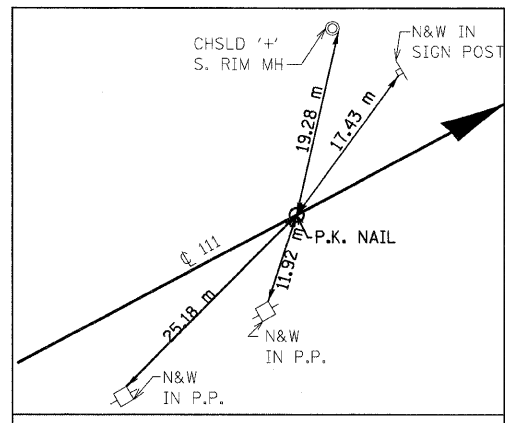

IL 111 @ SERVICE DRIVE 1  
STA 30+246.919  
N 255,812.1484 E 698,304.6415

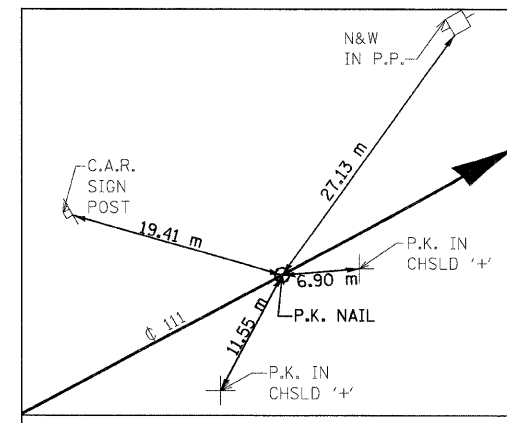

IL 111 PC STA 30+385.868  
N 255,877.5527 E 698,427.2344

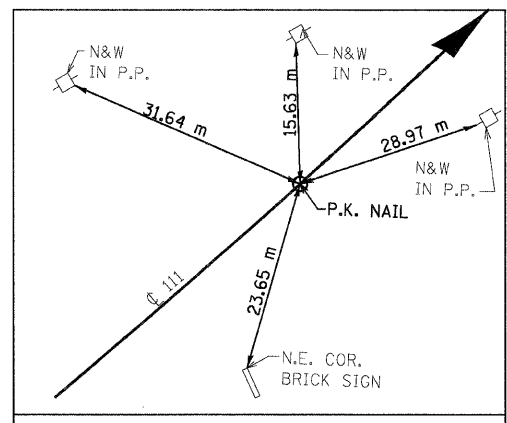

IL 111 POT STA 30+550.000  
N 255,971.6482 E 698,561.2183

NOTES:

- 1) DIMENSIONS LABELED "HORIZ" ARE HORIZONTAL PULLS.
- 2) DIMENSIONS NOT LABELED "HORIZ" ARE DIRECT PULLS.



(TYP ALL TIES THIS DWG)

REVISIONS	
NAME	DATE

ILLINOIS DEPARTMENT OF TRANSPORTATION  
HORIZONTAL CONTROL TIES  
FAP 310 (IL 255)  
SECTION 60-15-2 & 60-15HB-2  
MADISON COUNTY  
DRAWN BY KAH  
CHECKED BY  
DATE

12/7/2007

p:\00files\000024\dll111\Details\Misc\ties.dgn