

FILE #

1/13/2009

FILE #

DATE	
BY	
SURVEYED	
PLOTTED	
APPROVATE	
NOTE BOOK	
AREAS CHECKED	
NO.	

DATE	
BY	
SURVEYED	
PLOTTED	
APPROVATE	
NOTE BOOK	
AREAS CHECKED	
NO.	

FAP RTE	SECTION	COUNTY	TOTAL SHEETS	SHEET NO.
310	60-15-2 60-15HB-2	MADISON	272	245
STA.		TO STA.		
FED. ROAD DIST. NO.		ILLINOIS FED. AID PROJECT		
CONTRACT NO. 76624				

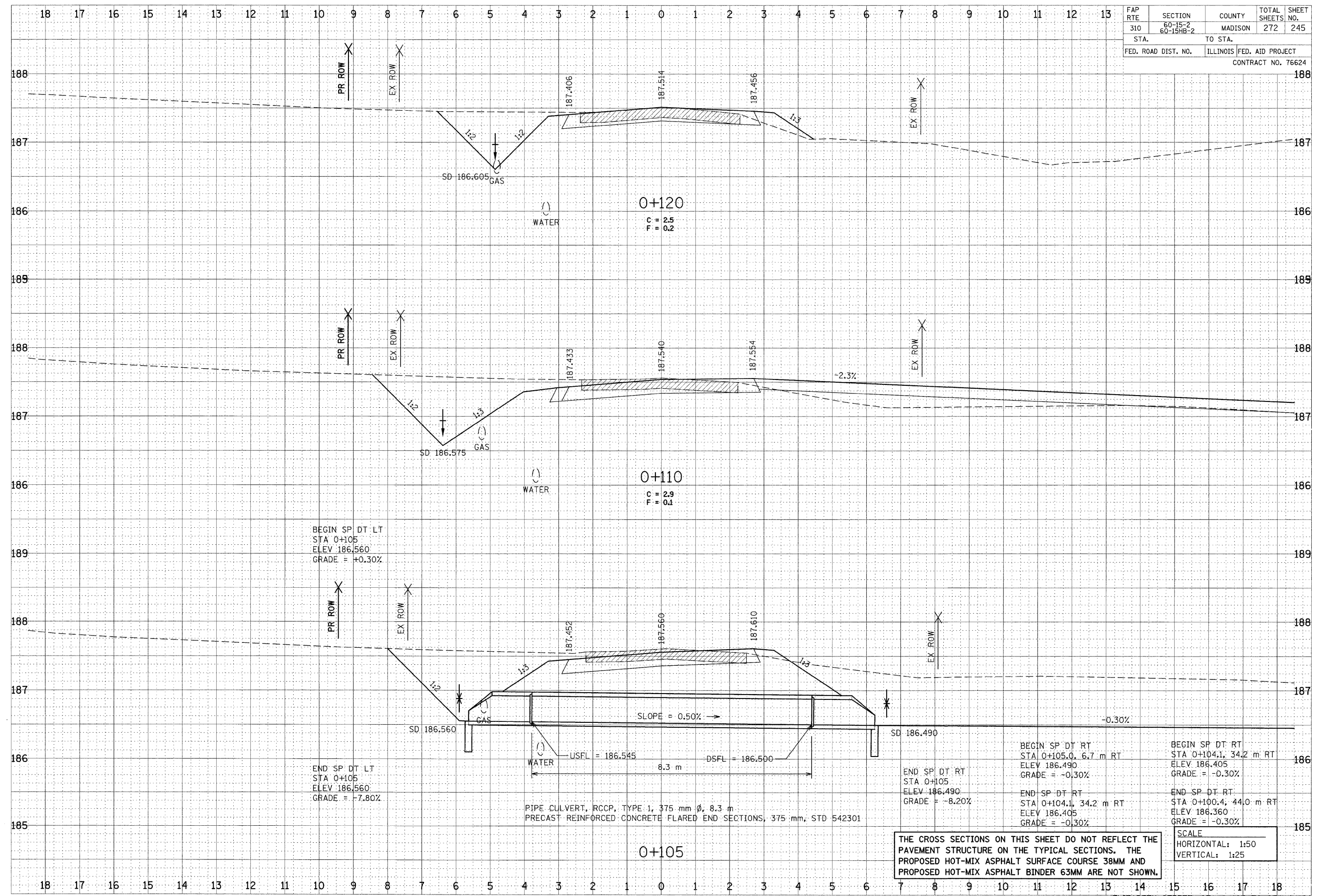

THE CROSS SECTIONS ON THIS SHEET DO NOT REFLECT THE PAVEMENT STRUCTURE ON THE TYPICAL SECTIONS. THE PROPOSED HOT-MIX ASPHALT SURFACE COURSE 38MM AND PROPOSED HOT-MIX ASPHALT BINDER 63MM ARE NOT SHOWN.

SCALE
HORIZONTAL: 1:50
VERTICAL: 1:25