

NOTE: EXISTING CONCRETE MEDIAN REMOVAL AND REPLACEMENT FROM STATION 19+415 TO STATION 19+605 REQUIRED FOR STAGE CONSTRUCTION AND TRAFFIC CONTROL.

F.A.P. RTE.	SECTION	COUNTY	TOTAL SHEETS	SHEET NO.
310	60-15-1, 60-15HB-1	MADISON	238	31
STA.		TO STA.		
FED. ROAD DIST. NO.		ILLINOIS FED. AID PROJECT		
CONTRACT NO. 76635				

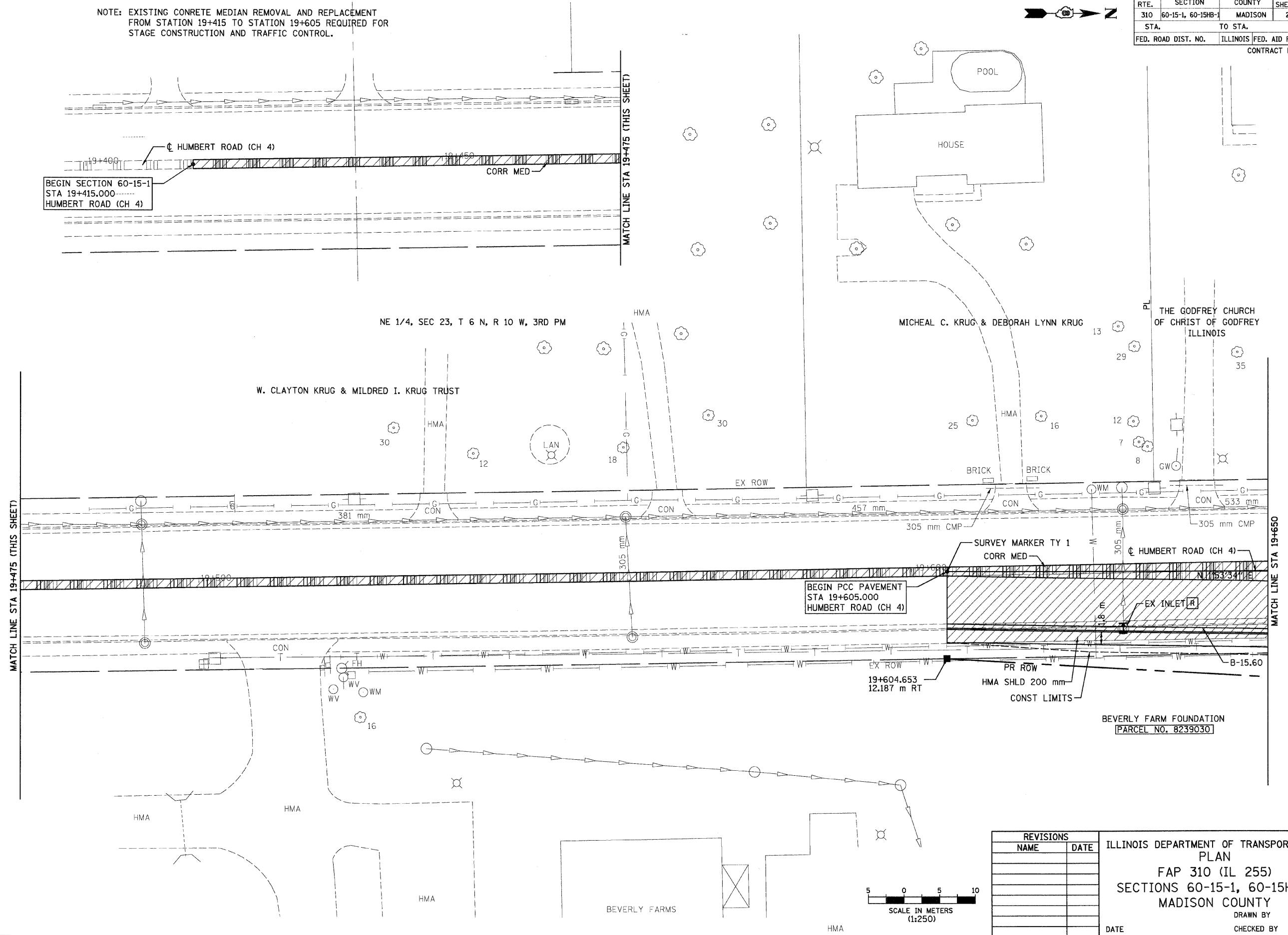

p:\00f.iles\00024\dhumbert\planprof.iles\plan015b01.dgn

REVISIONS	
NAME	DATE

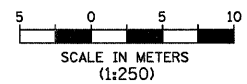

ILLINOIS DEPARTMENT OF TRANSPORTATION
 PLAN
 FAP 310 (IL 255)
 SECTIONS 60-15-1, 60-15HB-1
 MADISON COUNTY
 DRAWN BY
 CHECKED BY
 DATE

HUMBERT ROAD STA 19+605 TO STA 19+650