

F.A.P. RTE.	SECTION	COUNTY	TOTAL SHEETS	SHEET NO.
310	60-15-1, 60-15HB-1	MADISON	238	49
STA.		TO STA.		
FED. ROAD DIST. NO.		ILLINOIS FED. AID PROJECT		
CONTRACT NO. 76635				

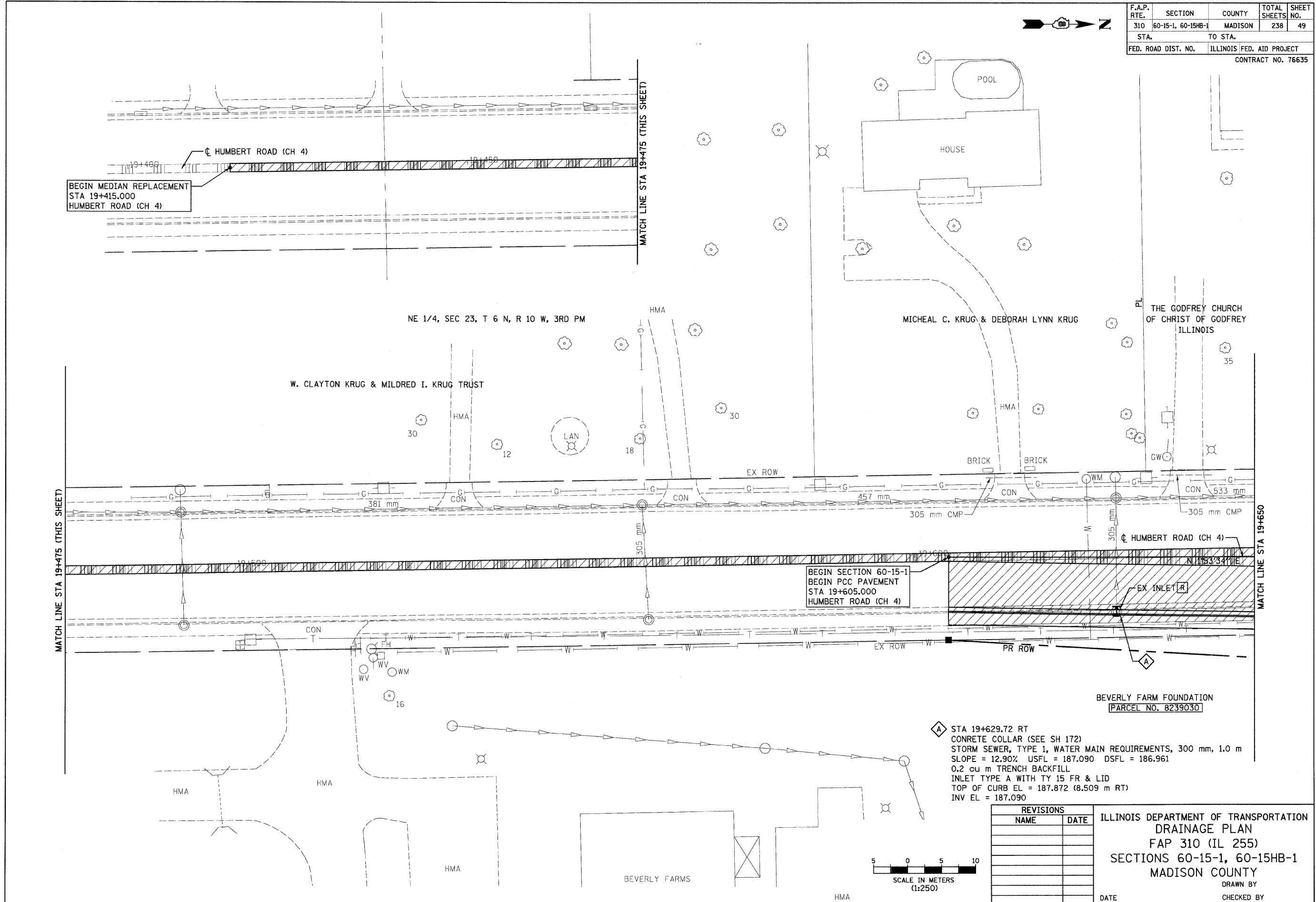

A STA 19+629.72 RT  
 CONCRETE COLLAR (SEE SH 172)  
 STORM SEWER, TYPE 1, WATER MAIN REQUIREMENTS, 300 mm, 1.0 m  
 SLOPE = 12.90% USFL = 187.090 DSFL = 186.961  
 0.2 cu m TRENCH BACKFILL  
 INLET TYPE A WITH TY 15 FR & LID  
 TOP OF CURB EL = 187.872 (8.509 m RT)  
 INV EL = 187.090

REVISIONS	
NAME	DATE

ILLINOIS DEPARTMENT OF TRANSPORTATION  
 DRAINAGE PLAN  
 FAP 310 (IL 255)  
 SECTIONS 60-15-1, 60-15HB-1  
 MADISON COUNTY  
 DRAWN BY  
 CHECKED BY  
 DATE

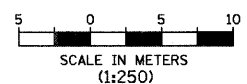

p:\00f\1es\00024\dhumbert\pl\omprof\1es\drp\lan\015b01.dgn

HUMBERT ROAD STA 19+605 TO STA 19+650