

FILE NO.	SECTION	COUNTY	TOTAL SHEETS	SHEET NO.
70		MADISON	420	47
STA. 482+50		TO STA. 494+00		
CONTRACT NO.: 76709				
• 60-10K-1, 60-10HB				

PROP. CURVE 162PR1
 PI STA. = 493+92.86
 $\Delta = 28^\circ 58' 09''$ (LT)
 $D = 4^\circ 07' 29''$
 $R = 1,389.08'$
 $T = 358.84'$
 $L = 702.33'$
 $E = 45.60'$
 $e = NC$
 $T.R. = N/A$
 $S.E. RUN = N/A$
 $P.C. STA. = 490+34.02$
 $P.T. STA. = 497+36.34$

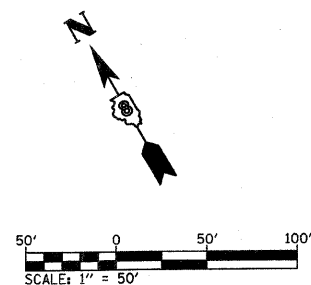

- NOTES:
- FOR MORE DETAILS SEE INTERSECTION LAYOUT DETAIL SHEETS.
 - ALL DIMENSIONS, STATIONS AND OFFSETS ARE TO THE EDGE OF PAVEMENT UNLESS OTHERWISE NOTED.

BENCHMARK:
 CONTROL POINT #34
 IRON PIN WITH CAP
 STA 493+09.47
 OFFSET 43.26' RT, EL 574.25

PLAN	DATE
BY	
NO.	
NO.	
NO.	
NO.	

PROFILE	DATE
BY	
NO.	
NO.	
NO.	
NO.	

•DGN-SPEC*
 •REF: 236c1p01.dgn
 •REF: 236c1w01.dgn
 •REF: 236c1v01.dgn
 •REF: 236c1h01.dgn
 •REF: 236c1s01.dgn

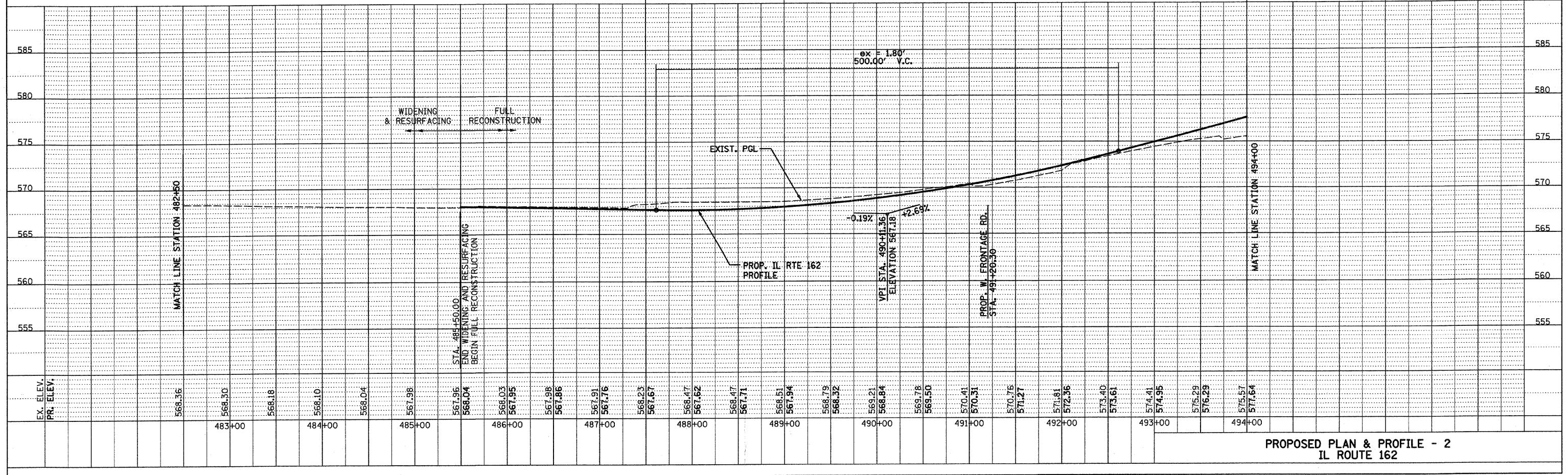
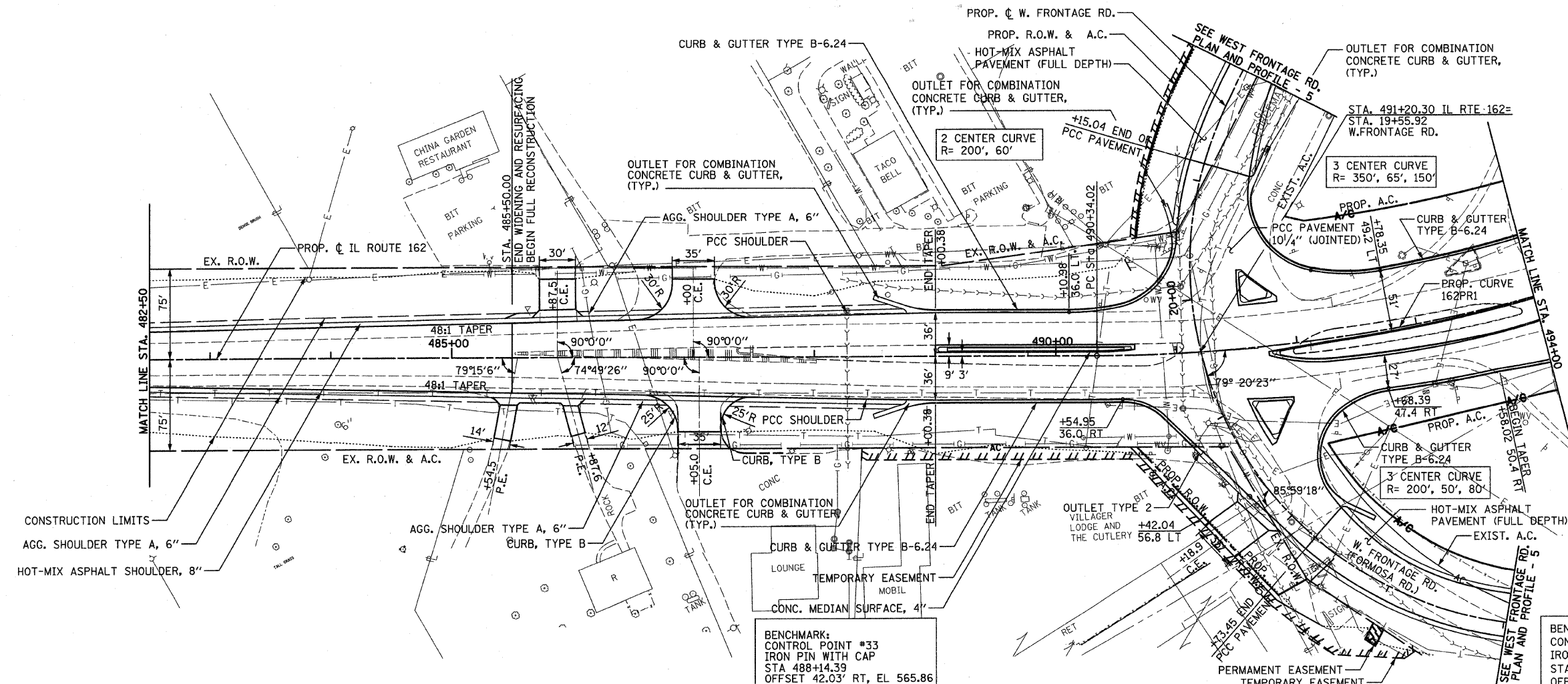

PROPOSED PLAN & PROFILE - 2
 IL ROUTE 162

PLOT DATE: *DATE-TIME*