

FBI ROUTE	SECTION	COUNTY	TOTAL SHEETS	SHEET NO
70	*	MADISON	420	58
STA. 10+00		TO STA. 14+00		
CONTRACT NO.: 76709				
• 60-10K-1, 60-10HB				

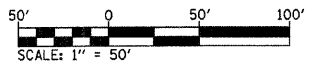

PLAN	SURVEYED	DATE
	PLOTTED	
	NOTED	
	BY	
	NO.	

PROFILE	SURVEYED	DATE
	PLOTTED	
	NOTED	
	BY	
	NO.	

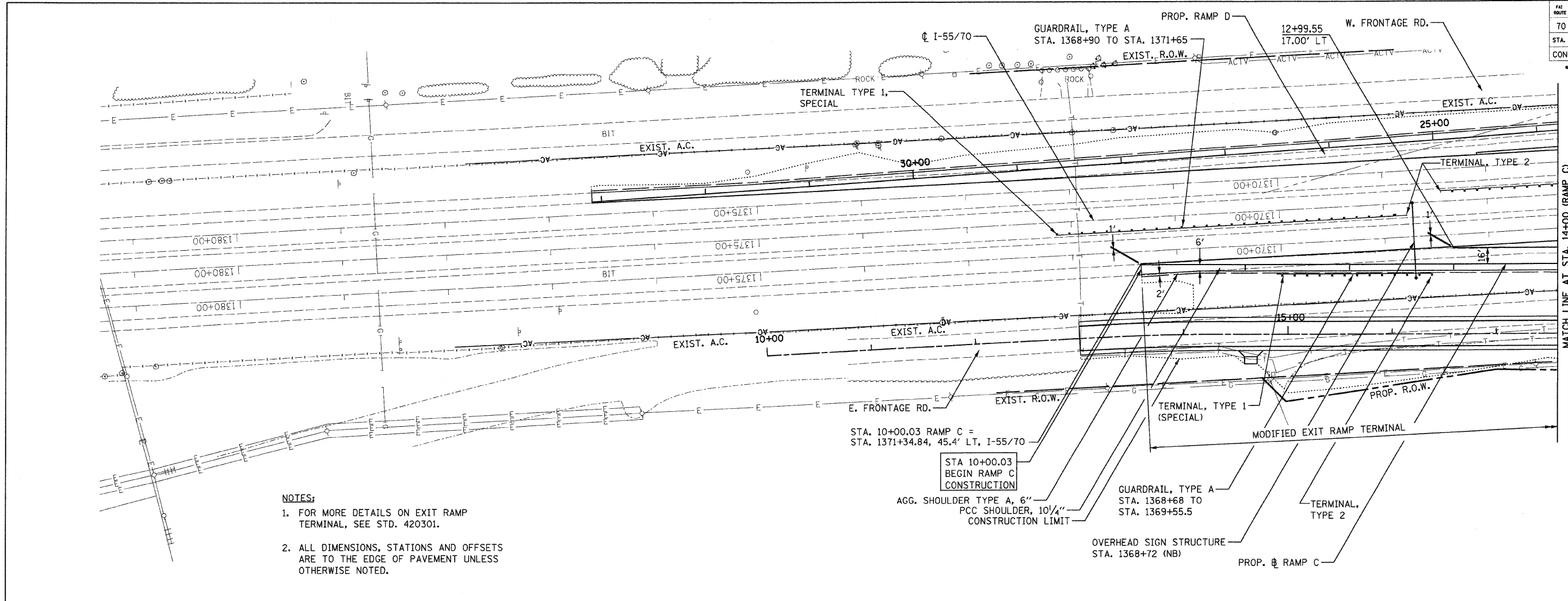

- NOTES:**
- FOR MORE DETAILS ON EXIT RAMP TERMINAL, SEE STD. 420301.
 - ALL DIMENSIONS, STATIONS AND OFFSETS ARE TO THE EDGE OF PAVEMENT UNLESS OTHERWISE NOTED.

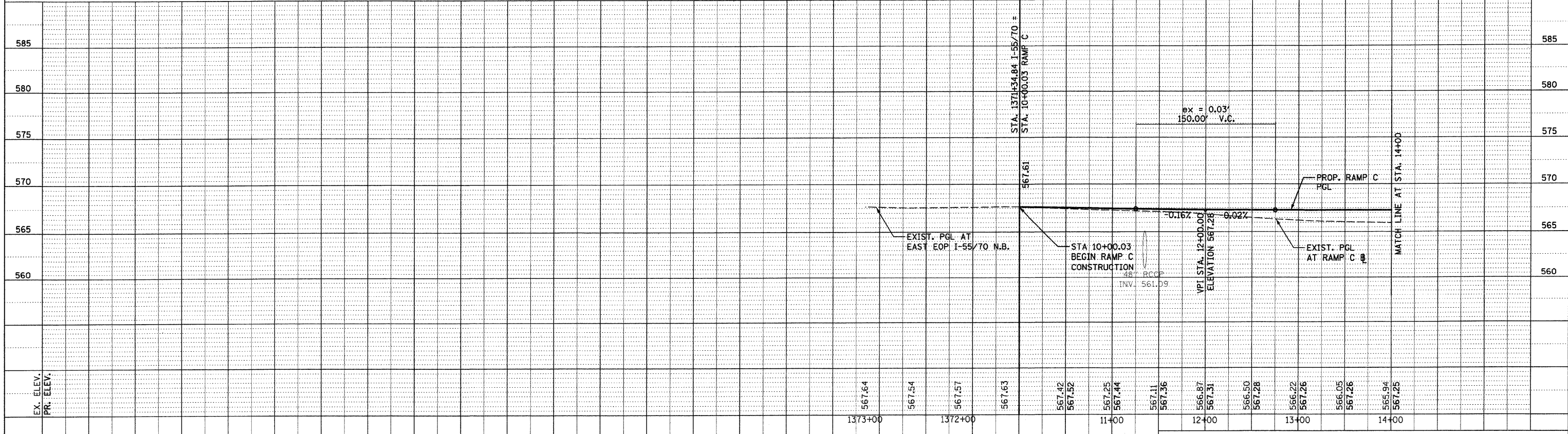

PROPOSED PLAN & PROFILE - 13
RAMP C

DATE-TIME
 DGN-SPEC
 *REF- 23sec01.dgn
 *REF- 23sec01.dgn
 *REF- 23sec01.dgn
 *REF- 23sec01.dgn
 *REF- 23sec01.dgn