

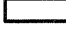

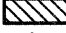
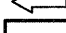

SECTION	COUNTY	TOTAL SHEETS	SHEET NO.
70	MADISON	420	71
STA.	TO STA.		
CONTRACT NO.: 76709			
60-10K-1,60-10HB			

LEGEND:

-  EXISTING OR NEW PAVEMENT USED FOR MAINTENANCE OF TRAFFIC
-  CONSTRUCTION LIMITS DURING STAGE
-  DIRECTION OF TRAFFIC ARROW
-  NEW PAVEMENT
-  TEMPORARY PAVEMENT
-  TEMPORARY TRAFFIC SIGN

NOTE 1:
THIS DETAIL IS A SUBSTAGE TO SHOW THE TRAFFIC ROUTING AND WORK AREA FOR IL 162 FROM STA. 493+20 TO STA. 497+50 AT THE END OF STAGE II WHEN THE EASTBOUND LANES ON IL 162 ARE OPEN WEST OF STA. 490+00.

PLAN	DATE
NO.	
BY	
CHECKED	
APPROVED	
DATE	

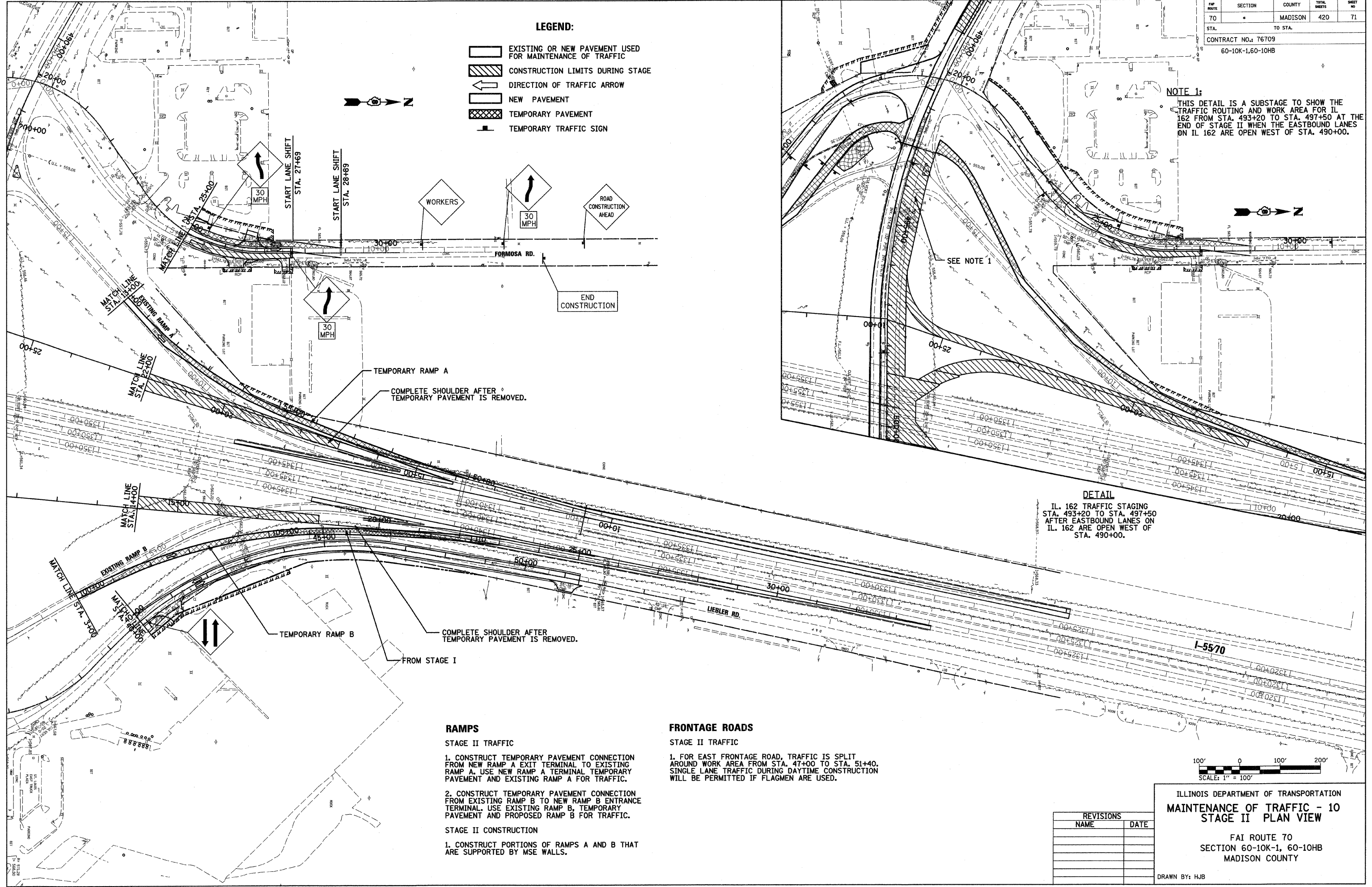

DETAIL
IL 162 TRAFFIC STAGING
STA. 493+20 TO STA. 497+50
AFTER EASTBOUND LANES ON
IL 162 ARE OPEN WEST OF
STA. 490+00.

RAMP

STAGE II TRAFFIC

1. CONSTRUCT TEMPORARY PAVEMENT CONNECTION FROM NEW RAMP A EXIT TERMINAL TO EXISTING RAMP A. USE NEW RAMP A TERMINAL TEMPORARY PAVEMENT AND EXISTING RAMP A FOR TRAFFIC.
2. CONSTRUCT TEMPORARY PAVEMENT CONNECTION FROM EXISTING RAMP B TO NEW RAMP B ENTRANCE TERMINAL. USE EXISTING RAMP B, TEMPORARY PAVEMENT AND PROPOSED RAMP B FOR TRAFFIC.

STAGE II CONSTRUCTION

1. CONSTRUCT PORTIONS OF RAMPS A AND B THAT ARE SUPPORTED BY MSE WALLS.

FRONTAGE ROADS

STAGE II TRAFFIC

1. FOR EAST FRONTAGE ROAD, TRAFFIC IS SPLIT AROUND WORK AREA FROM STA. 47+00 TO STA. 51+40. SINGLE LANE TRAFFIC DURING DAYTIME CONSTRUCTION WILL BE PERMITTED IF FLAGMEN ARE USED.

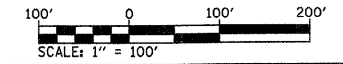

REVISIONS	
NAME	DATE

ILLINOIS DEPARTMENT OF TRANSPORTATION
MAINTENANCE OF TRAFFIC - 10
STAGE II PLAN VIEW

FAI ROUTE 70
SECTION 60-10K-1, 60-10HB
MADISON COUNTY

DRAWN BY: HJB
PLOT DATE: *DATE-TIME*

DON-SPEC
REF-