

FAI ROUTE	SECTION	COUNTY	TOTAL SHEETS	SHEET NO
70		MADISON	420	97
STA. 494+00		TO STA. 518+00		
CONTRACT NO.: 76709				
• 60-10K-1, 60-10HB				

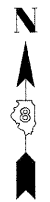

PLAN	SURVEYED	BY	DATE
	ADJUSTED		
	CHECKED		
	NO. OF WAY CHECKED		
	PAID FILE NAME		
	NO.		

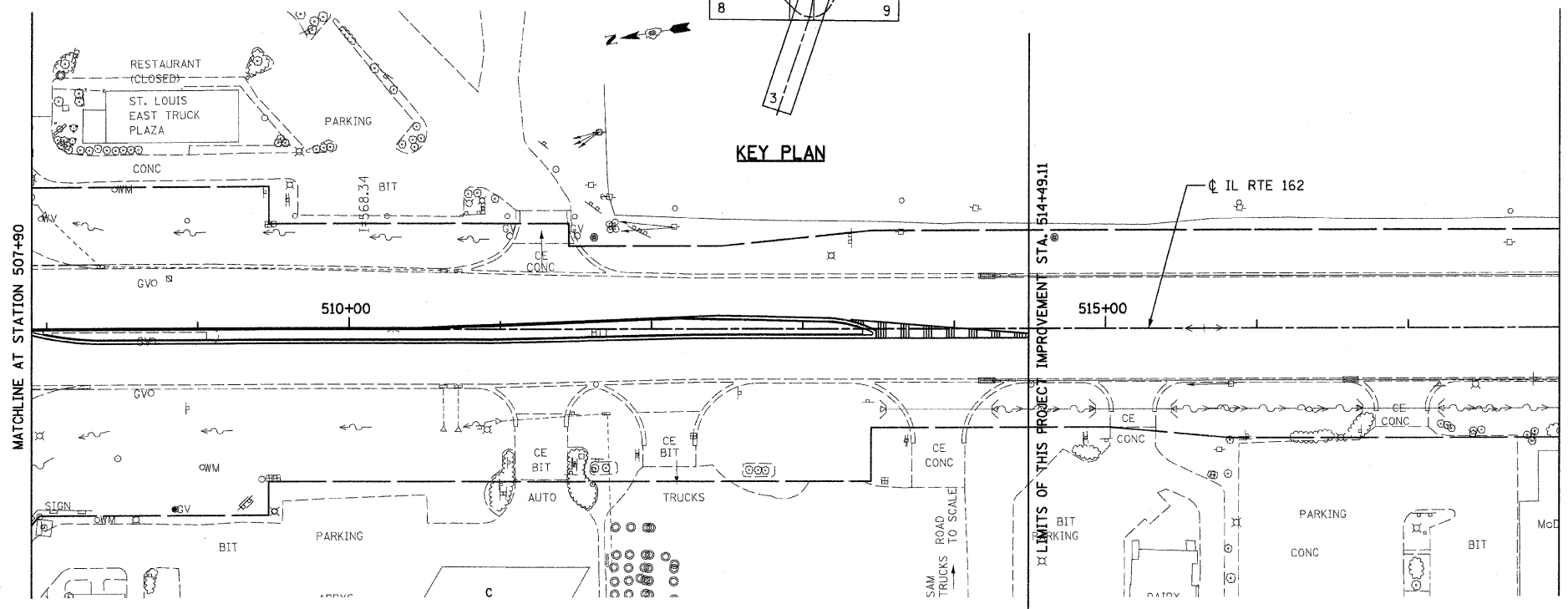
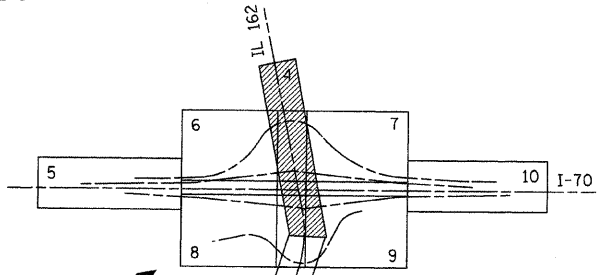
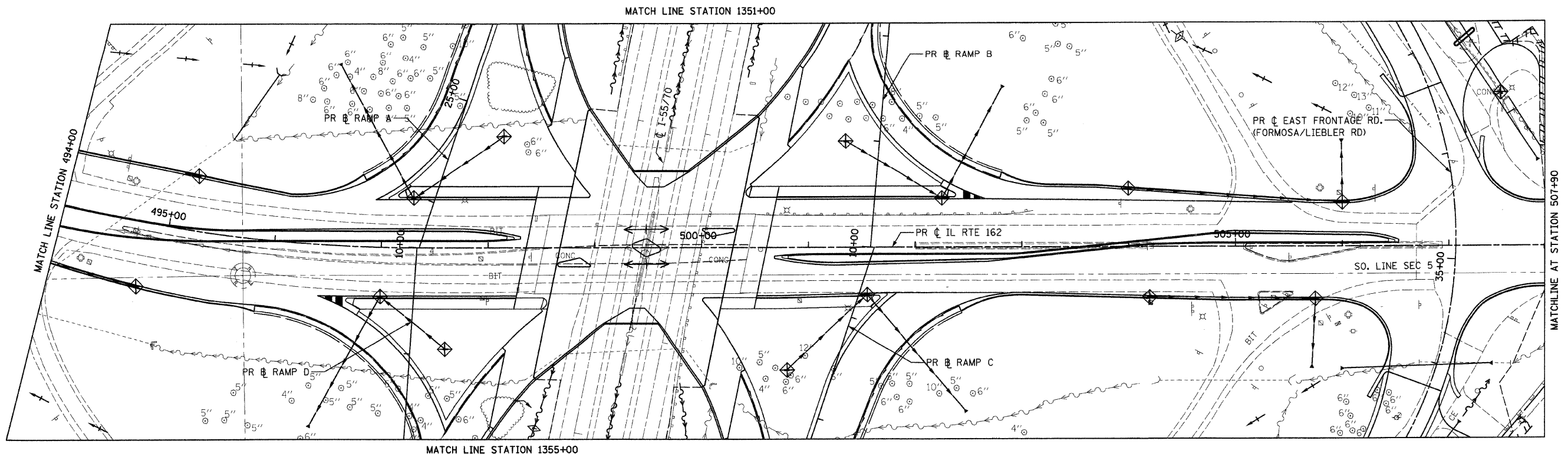

LEGEND

	TEMPORARY DITCH CHECK
	EROSION CONTROL BLANKET
	PERIMETER EROSION BARRIER
	INLET AND PIPE PROTECTION

- NOTES:**
1. FOR DRAINAGE INFORMATION, SEE DRAINAGE PLANS.
 2. PERIMETER EROSION BARRIER IS LOCATED ON TEMPORARY EASEMENT/PERMANENT EASEMENT/R.O.W. LINE, AS SHOWN ON THE PLANS.
 3. FOR PERMANENT EROSION CONTROL INFORMATION, SEE SEEDING PLANS.
 4. FOR EROSION CONTROL DURING STAGED CONSTRUCTION, SEE EROSION CONTROL AND TEMPORARY DRAINAGE PLAN.

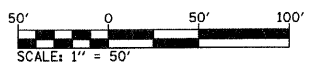

ILLINOIS DEPARTMENT OF TRANSPORTATION
STORM WATER POLLUTION PREVENTION PLAN - 4
 FAI ROUTE 70
 SECTION 60-10K-1, 60-10HB
 MADISON COUNTY

REVISIONS	
NAME	DATE

DRAWN BY: GRH
 PLOT DATE: *DATE-TIME*

DATE-TIME
 DGN-SPEC
 *REF- 236001.dgn
 *REF- 236001.dgn
 *REF- 236001.dgn
 *REF- 236001.dgn
 *REF- 236001.dgn
 *REF- 236001.dgn