

ALL TIES ARE TAPERED
DIRECT MEASUREMENTS
STA. 108+07.97

STATIONING IS APPROXIMATELY
450' WEST OF RT 100

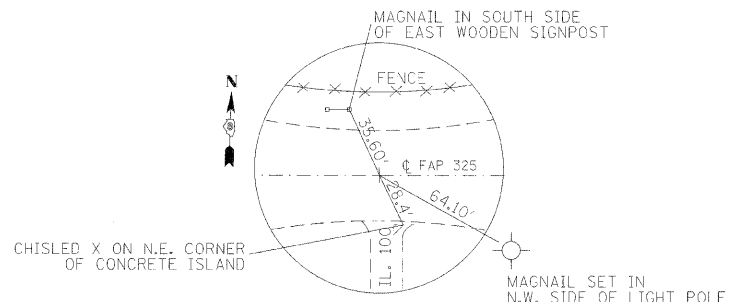

P.I. STA. 112+81.53
MAGNAIL

ALL TIES ARE TAPERED
DIRECT MEASUREMENTS

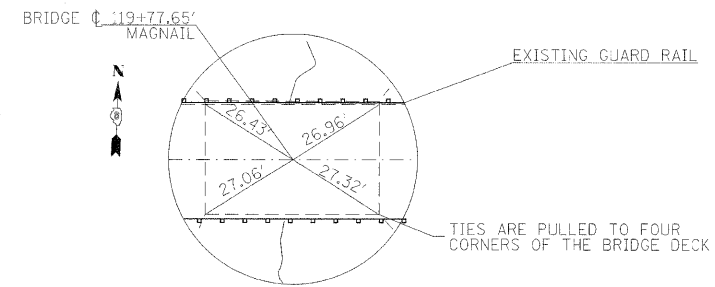

S.N. 042-0006
BAUM BRANCH CREEK
BRIDGE STA. 119+77.65

NOTE:
ALL TIES ARE TAPERED
DIRECT NTC

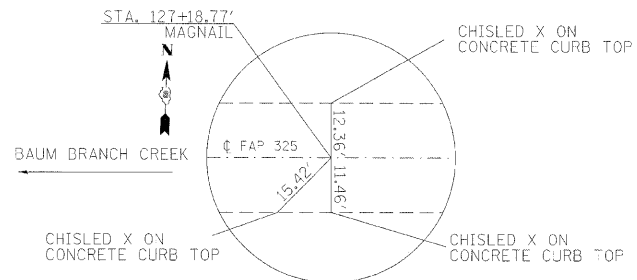

STA. 127+18.77
MAG NAIL

NOTE:
ALL TIES ARE TAPERED
DIRECT NTC

SITE BENCH MARKS

BM 303
EL. = 451.895
APPROX. STA. = 120+50.75' LT.
IL 16

BM U241 RESET
EL. = 441.433
APPROX. STA. / OFFSET =
504+08.20' RT.
ON IL RT. 100

BENCH MARK
RR SPIKE DRIVEN 14" ABOVE GROUND IN SOUTH SIDE OF POWER POLE, 100'
N.E. OF RT 16

FILE NAME =	USER NAME = mannta	DESIGNED -	REVISED -	STATE OF ILLINOIS DEPARTMENT OF TRANSPORTATION	TIE POINTS & BENCH MARKS			F.A.P. RTE.	SECTION	COUNTY	TOTAL SHEETS	SHEET NO.
c:\pw_work\pwidot\mannta\dms51935\pin0206a.dgn		DRAWN -	REVISED -		325	3BR-2	JERSEY	90	9			
PLOT SCALE = 20.0000' / IN.		CHECKED -	REVISED -		CONTRACT NO. 76B01							
PLOT DATE = 12/11/2008		DATE -	REVISED -		SCALE:	SHEET NO. OF SHEETS	STA. TO STA.	FED. ROAD DIST. NO.	ILLINOIS FED. AID PROJECT			