

- ⑨ STA. 849+68, 28.2' LT  
EXISTING FRAMES AND GRATES  
TO BE ADJUSTED
- ⑩ STA. 849+91, 15.4' LT  
EXISTING VALVE BOX  
TO BE ADJUSTED

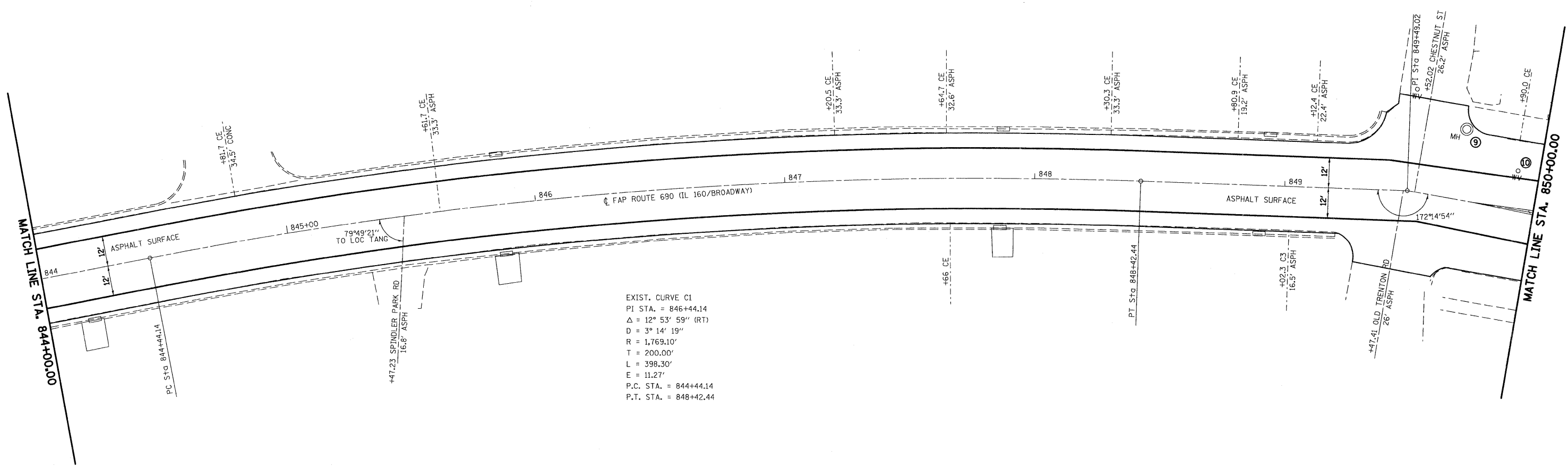

EXIST. CURVE C1  
 PI STA. = 846+44.14  
 $\Delta = 12^\circ 53' 59''$  (RT)  
 D =  $3^\circ 14' 19''$   
 R = 1,769.10'  
 T = 200.00'  
 L = 398.30'  
 E = 11.27'  
 P.C. STA. = 844+44.14  
 P.T. STA. = 848+42.44

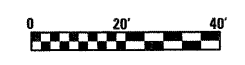

|   |                            |                |           |   |                                 |                    |                         |                                  |                     |                           |                    |
|---|----------------------------|----------------|-----------|---|---------------------------------|--------------------|-------------------------|----------------------------------|---------------------|---------------------------|--------------------|
| FILE NAME =   | USER NAME = paul           | DESIGNED - ESW | REVISED - | <b>STATE OF ILLINOIS<br/>DEPARTMENT OF TRANSPORTATION</b> | <b>PLAN SHEET, IL ROUTE 160</b> | F.A.P. RTE.<br>690 | SECTION<br>41X-RS-1     | COUNTY<br>MADISON                | TOTAL SHEETS<br>58  | SHEET NO.<br>21           |                    |
| S:\Projects\407-0029-RTY IL 160 0902LAND\dm\CA00 Sheet\A\0876C35-ah1-plan.dgn | PLOT SCALE = 28,000' / IN. | DRAWN - WJS    | REVISED - |   |                                 | SCALE: 1" = 20'    | SHEET NO. 3 OF 9 SHEETS | STA. 844+00.00 TO STA. 850+00.00 | FED. ROAD DIST. NO. | ILLINOIS FED. AID PROJECT | CONTRACT NO. 76C35 |
|   | PLOT DATE = 1/13/2009      | CHECKED - BRM  | REVISED - |   |                                 |                    |                         |                                  |                     |                           |                    |
|   |                            | DATE - 9-29-08 | REVISED - |   |                                 |                    |                         |                                  |                     |                           |                    |