

EXISTING IL 242 CENTERLINE CONTROL POINT TABLE

POINT DESCRIPTION	STATION	BEARING	DISTANCE	NORTHING	EASTING
POB	455+00.00			572862.6466	925404.2616
POE	485+00.00	S 0° 10' 31.35" W	3000.00'	569862.6606	925395.0790

NOTES:
 1. SEE STAGE 1 CONSTRUCTION PLANS FOR HOT-MIX ASPHALT BASE COURSE WIDENING, 10" CALLOUTS.

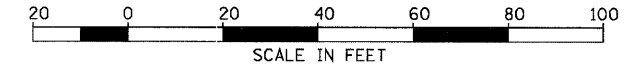

CONTROL POINTS				
POINT	NORTHING	EASTING	ELEVATION	DESCRIPTION
1	571260.73	925452.85	379.83	REBAR WITH CAP
2	571517.37	925473.49	394.56	REBAR WITH CAP
1006	571219.94	925378.8	390.15	REBAR WITH CAP
1007	571359.67	925420.3	389.74	REBAR WITH CAP

PLAN	SURVEYED	DATE
	ALIGNED	
	RT. OF WAY CHECKED	
	NO. OF WAY CHECKED	
	NO. FILE NAME	

PROFILE	SURVEYED	DATE
	GRADES CHECKED	
	B.M. NOTED	
	STRUCTURE NOTATIONS CHECKED	

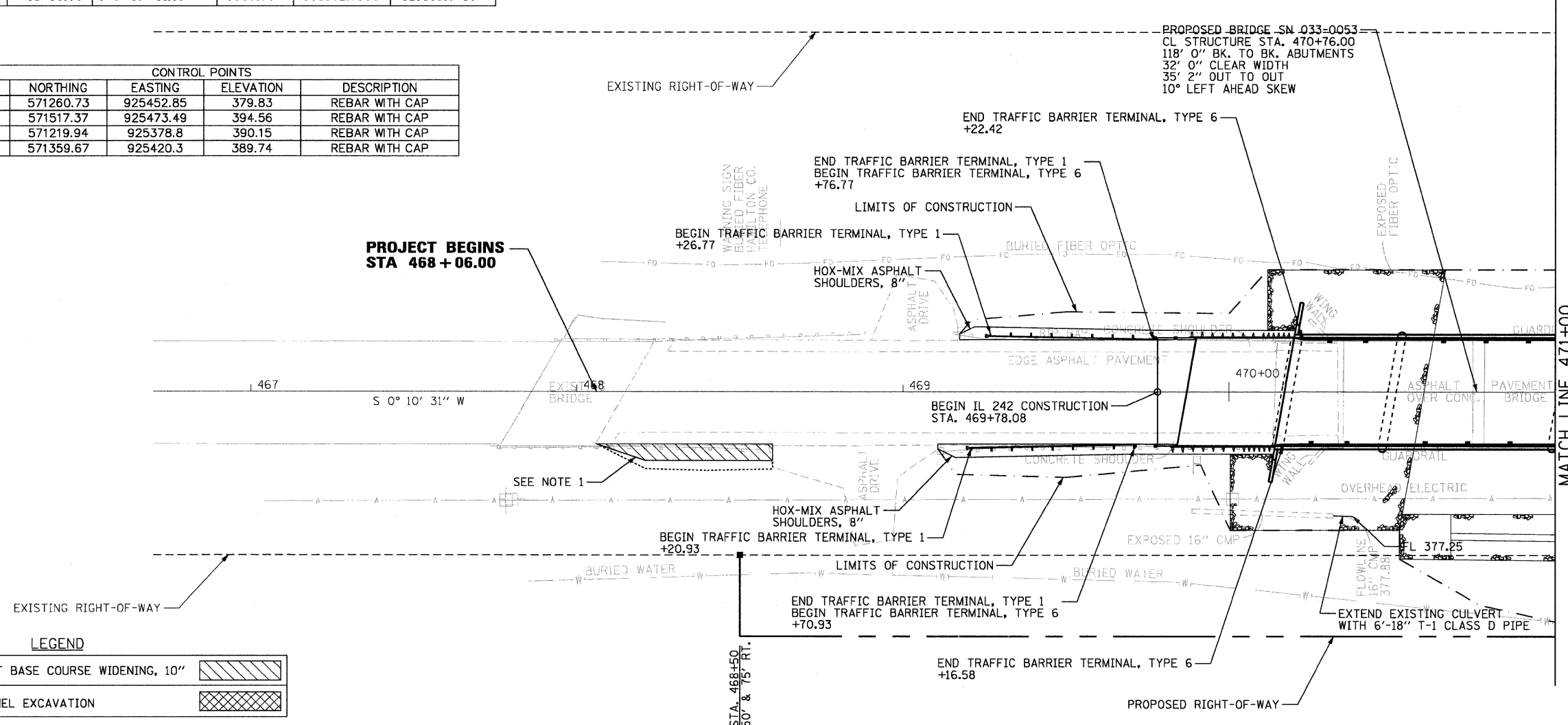

LEGEND

HOT-MIX ASPHALT BASE COURSE WIDENING, 10"	
LIMITS OF CHANNEL EXCAVATION	

