

ROUTE No.	SECTION	COUNTY	TOTAL SHEETS	SHEET NO.
F.A.P. 331	(8X-1)B	SALINE CO.	220	140
STA.		TO STA.		
F.H.W.A. REGION		ILLINOIS	PROJECT	

Contract # 78058

NORTH TOE OF MEDIAN BARRIER

Location	Station	Offset	Theoretical Grade Elevations
West End E. Appr. Pvmnt	1014+21.71	-1.33	372.13
C	1014+31.61	-1.33	372.11
D	1014+41.50	-1.33	372.08
East End E. Appr. Pvmnt	1014+51.38	-1.33	372.06

Proposed ϕ Ill. 13 Relocation & P.G.

Location	Station	Offset	Theoretical Grade Elevations
West End E. Appr. Pvmnt	1014+20.61	0.00	372.09
C	1014+30.52	0.00	372.07
D	1014+40.41	0.00	372.05
East End E. Appr. Pvmnt	1014+50.30	0.00	372.03

SOUTH TOE OF MEDIAN BARRIER

Location	Station	Offset	Theoretical Grade Elevations
West End E. Appr. Pvmnt	1014+19.52	1.33	372.06
C	1014+29.43	1.33	372.04
D	1014+39.33	1.33	372.02
East End E. Appr. Pvmnt	1014+49.21	1.33	371.99

NORTH EDGE OF EB PAVEMENT

Location	Station	Offset	Theoretical Grade Elevations
West End E. Appr. Pvmnt	1014+11.56	11.00	371.83
C	1014+21.49	11.00	371.81
D	1014+31.41	11.00	371.79
East End E. Appr. Pvmnt	1014+41.32	11.00	371.76

SOUTH EDGE OF EB PAVEMENT

Location	Station	Offset	Theoretical Grade Elevations
West End E. Appr. Pvmnt	1013+91.70	35.00	371.23
C	1014+01.68	35.00	371.22
D	1014+11.66	35.00	371.20
East End E. Appr. Pvmnt	1014+21.62	35.00	371.18

SOUTH EDGE OF SHOULDER

Location	Station	Offset	Theoretical Grade Elevations
West End E. Appr. Pvmnt	1013+82.65	45.87	370.96
C	1013+92.71	45.81	370.95
D	1014+02.42	46.15	370.93
East End E. Appr. Pvmnt	1014+12.83	45.64	370.92

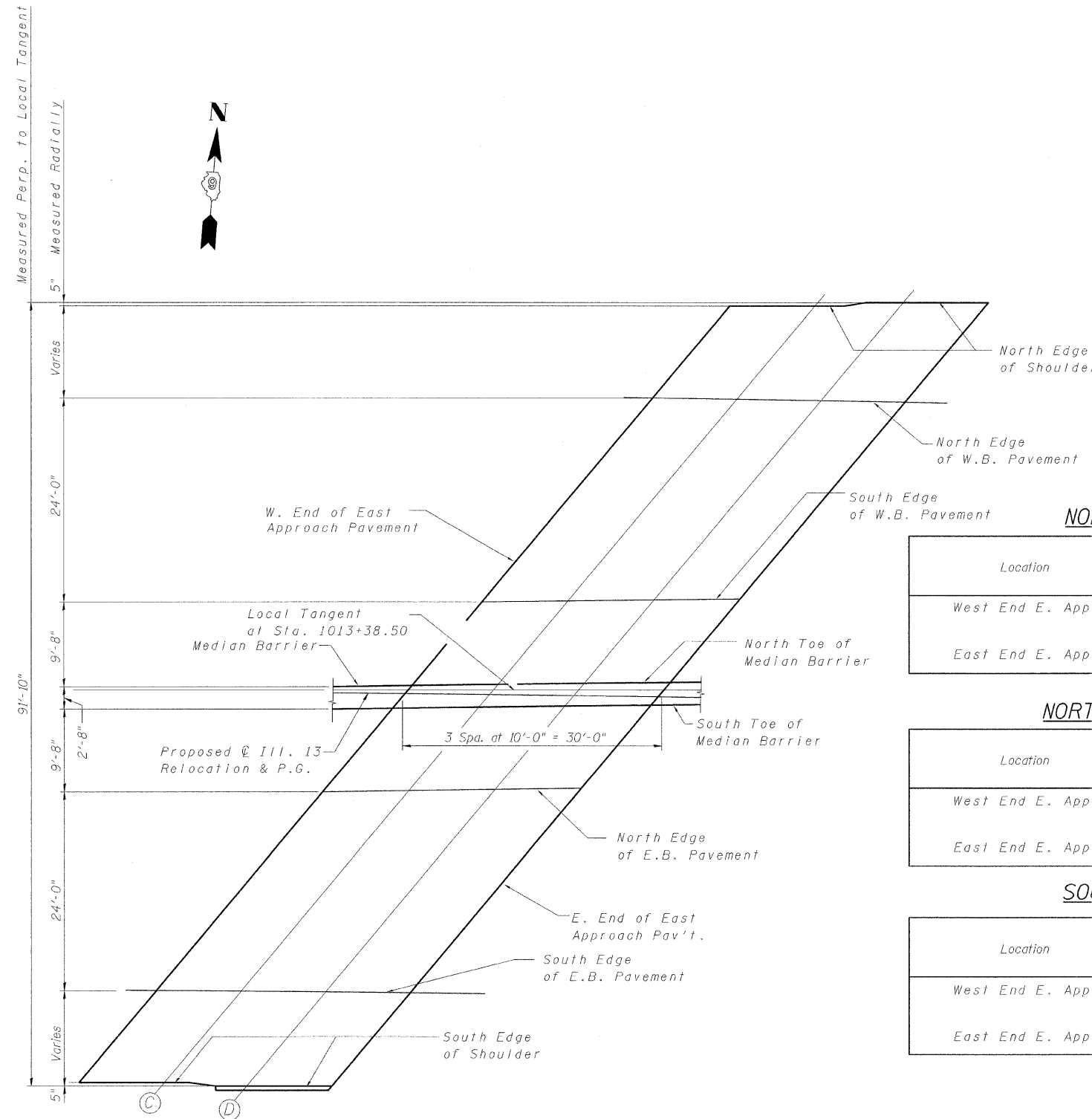

PLAN

NORTH EDGE OF SHOULDER

Location	Station	Offset	Theoretical Grade Elevations
West End E. Appr. Pvmnt	1014+58.03	-45.94	373.20
C	1014+67.97	-46.10	373.18
D	1014+78.24	-46.70	373.16
East End E. Appr. Pvmnt	1014+88.18	-46.89	373.13

NORTH EDGE OF WB PAVEMENT

Location	Station	Offset	Theoretical Grade Elevations
West End E. Appr. Pvmnt	1014+49.17	-35.00	372.94
C	1014+59.00	-35.00	372.91
D	1014+68.82	-35.00	372.88
East End E. Appr. Pvmnt	1014+78.63	-35.00	372.85

SOUTH EDGE OF WB PAVEMENT

Location	Station	Offset	Theoretical Grade Elevations
West End E. Appr. Pvmnt	1014+29.63	-11.00	372.36
C	1014+39.51	-11.00	372.34
D	1014+49.38	-11.00	372.31
East End E. Appr. Pvmnt	1014+59.24	-11.00	372.29

Notes:
1. For approach slab details, see sheets S24 and S25.

DESIGNED	KMP
CHECKED	AJK
DRAWN	KMP
CHECKED	AJK

benesch

alfred benesch & company
Engineers • Surveyors • Planners
205 North Michigan Avenue, Suite 2400
Chicago, Illinois 60601
312-566-0460

ILLINOIS DEPARTMENT OF TRANSPORTATION
RELOCATED ILLINOIS ROUTE 13 OVER
HARRISBURG DITCH
F.A.P. 331 SECTION (8X-1)B
TOP OF EAST APPROACH
SLAB ELEVATIONS

SN: 083-0060
SALINE CO., IL.

STA. 1013+38.50
DATE: FEB 4, 2009