

BY	DATE
SURVEYED	
PLOTTED	
NOTE BOOK	
AREAS CHECKED	
NO.	

BY	DATE
SURVEYED	
PLOTTED	
NOTE BOOK	
AREAS CHECKED	
NO.	

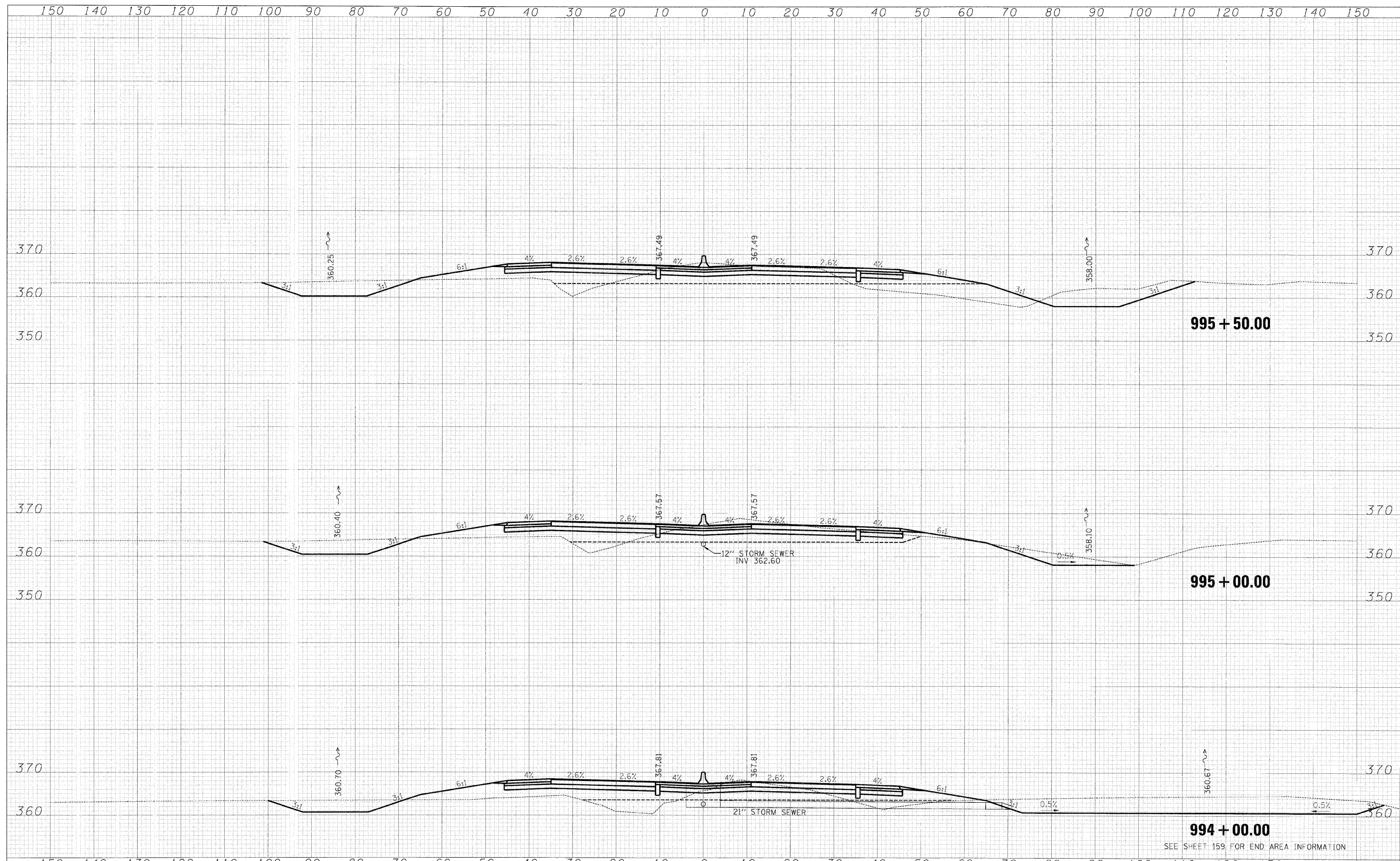

FILE NAME - IL13_west_xsec_sheets.dgn	USER NAME - bweigand	DESIGNER - BJW	REVISOR -	SCALE: 1" = 10'	SHEET NO. OF SHEETS	STA. 994+00.00 TO STA. 995+50.00	F.A. RTE. 331	SECTION 3-2, 8X-1, (8X-1)B, 4-2	COUNTY SALINE	TOTAL SHEETS 176	SHEET NO. 220
	PLLOT SCALE = 1:10	CHECKED - JPN	REVISOR -								
	PLLOT DATE = 2/2/2009	DATE - 02-02-09	REVISOR -								

**STATE OF ILLINOIS  
DEPARTMENT OF TRANSPORTATION**

**CROSS SECTIONS-ILL 13 RELOCATION**

SEE SHEET 159 FOR END AREA INFORMATION

CONTRACT NO. 78058	
FED. ROAD DIST. NO.	ILLINOIS FED. AID PROJECT