

DATE	
BY	
FINAL SURVEY	
SURVEYED	
PLOTTED	
NOTE BOOK	
AREAS CHECKED	
NO.	

DATE	
BY	
ORIGINAL SURVEY	
SURVEYED	
PLOTTED	
NOTE BOOK	
AREAS CHECKED	
NO.	

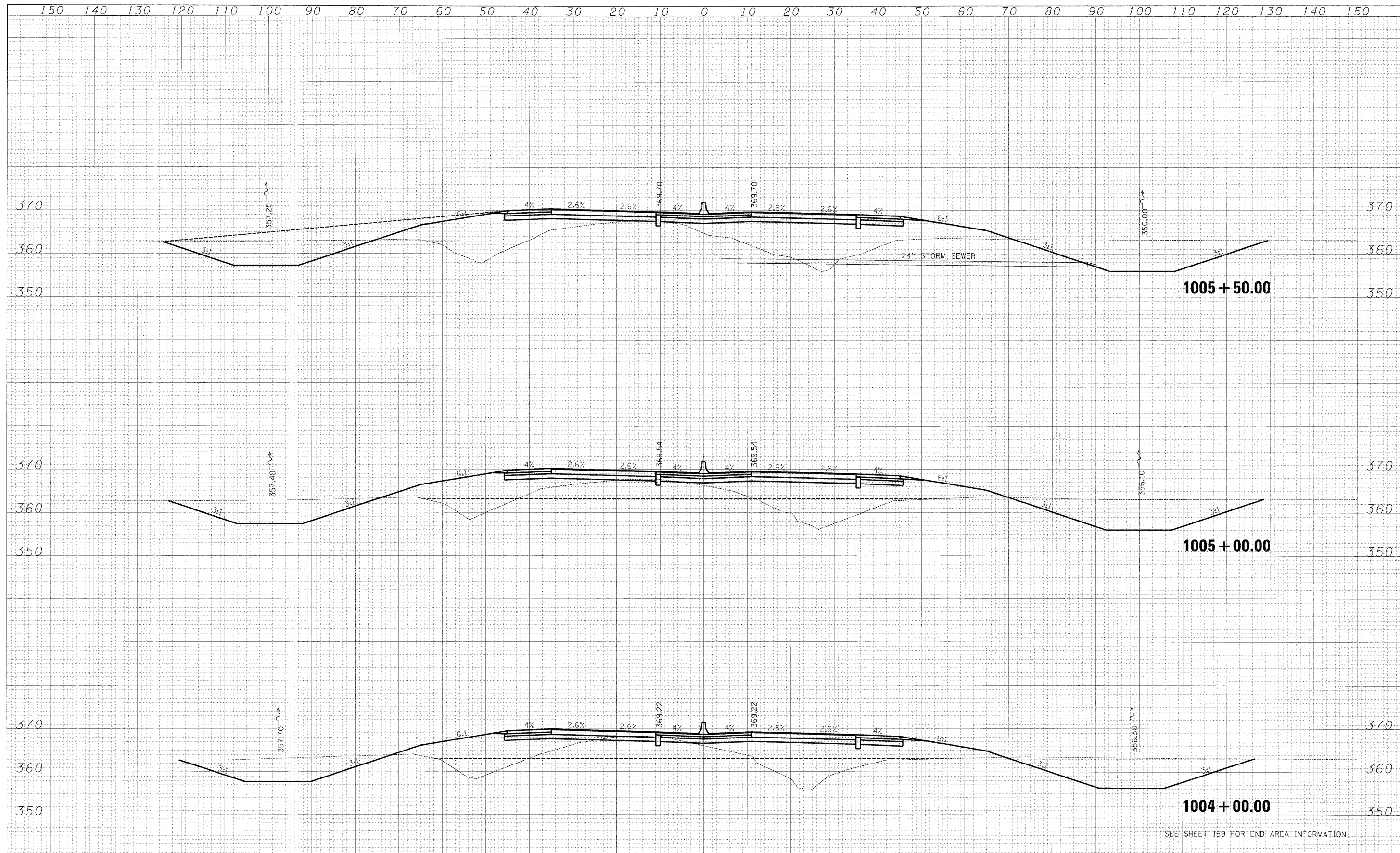

SEE SHEET 159 FOR END AREA INFORMATION

FILE NAME = ILL13_west_xsec_sheets.dgn	USER NAME = bweigand	DESIGNED - BJW	REVISED -	<p align="center">STATE OF ILLINOIS DEPARTMENT OF TRANSPORTATION</p> <p align="center">CROSS SECTIONS-ILL 13 RELOCATION</p>	F.A. RTE. 331	SECTION 3-2, 8X-1, (8X-1)B, 4-2	COUNTY SALINE	TOTAL SHEETS 180	SHEET NO. 220	
	PLOT SCALE = 1:10	DRAWN - DMS	REVISED -		SCALE:	SHEET NO.	OF	SHEETS	STA. 1004+00.00 TO STA. 1005+50.00	FED. ROAD D.S.T. NO.
	PLOT DATE = 2/2/2009	CHECKED - JPN	REVISED -							ILLINOIS FED. AID PROJECT
		DATE - 02-02-09	REVISED -							CONTRACT NO. 78058