

DATE	BY
SURVEYED	PLOTTED
NOTE BOOK	AREAS CHECKED
NO.	NO.

DATE	BY
SURVEYED	PLOTTED
NOTE BOOK	AREAS CHECKED
NO.	NO.

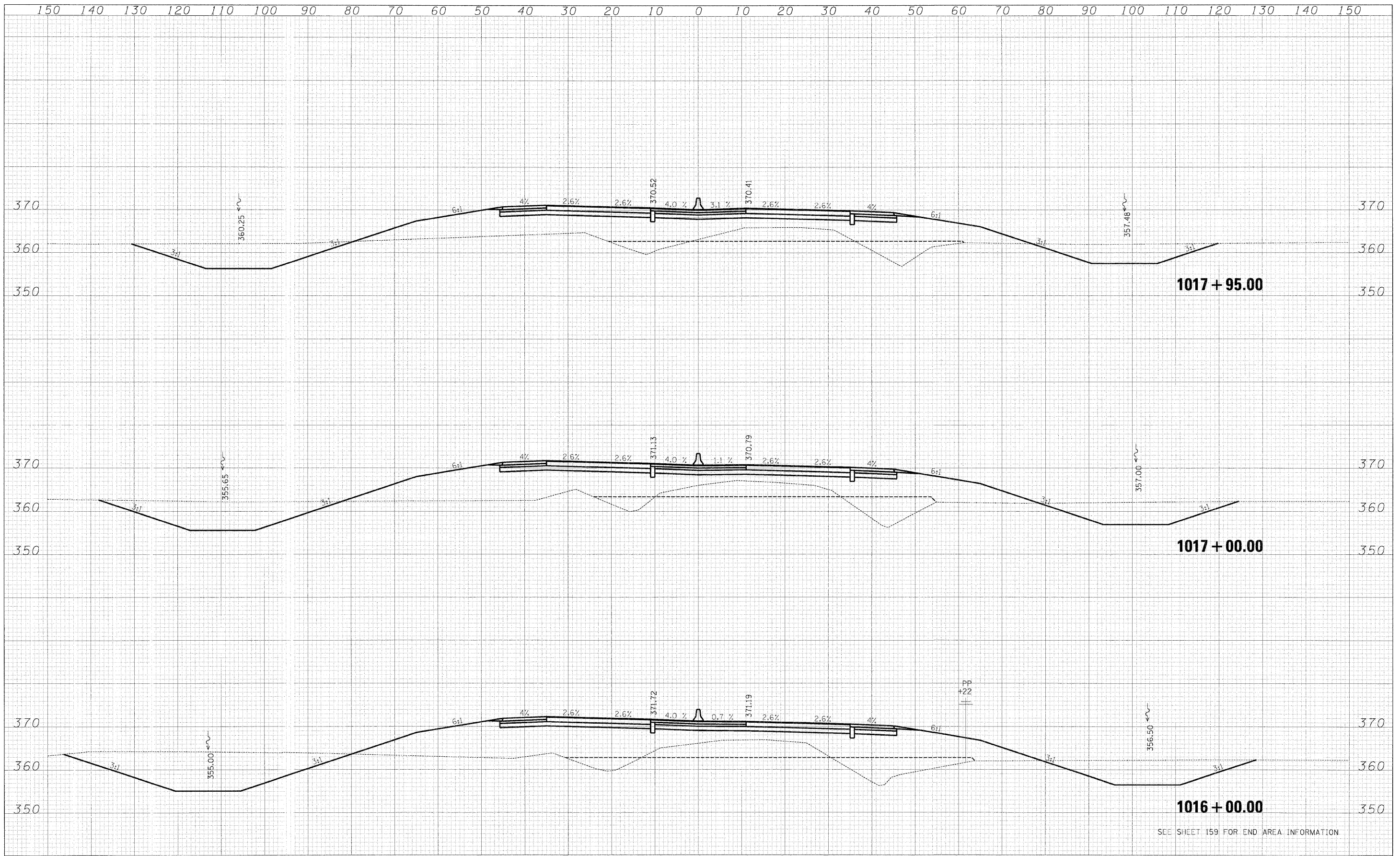

FILE NAME = IL13_west_xsec_sheets.dgn	USER NAME = bweigand	DESIGNED - BJW	REVISÉD -	STATE OF ILLINOIS DEPARTMENT OF TRANSPORTATION	CROSS SECTIONS-ILL 13 RELOCATION	SCALE: _____	SHEET NO. _____	OF _____	SHEETS _____	STA. 1016+00.00	TO STA. 1017+95.00	FILE RTE. 331	SECTION 3-2, 8X-1, (8X-1)B, 4-2	COUNTY SALINE	TOTAL SHEETS 185	SHEET NO. 220
PLOT SCALE = 1:10	CHECKED - JPN	REVISÉD -	FED. ROAD DIST. NO. _____			ILLINOIS FED. AID PROJECT _____	CONTRACT NO. 78058									
PLOT DATE = 2/2/2009	DATE - 02-02-09	REVISÉD -														
SEE SHEET 159 FOR END AREA INFORMATION																