

BY	DATE

BY	DATE

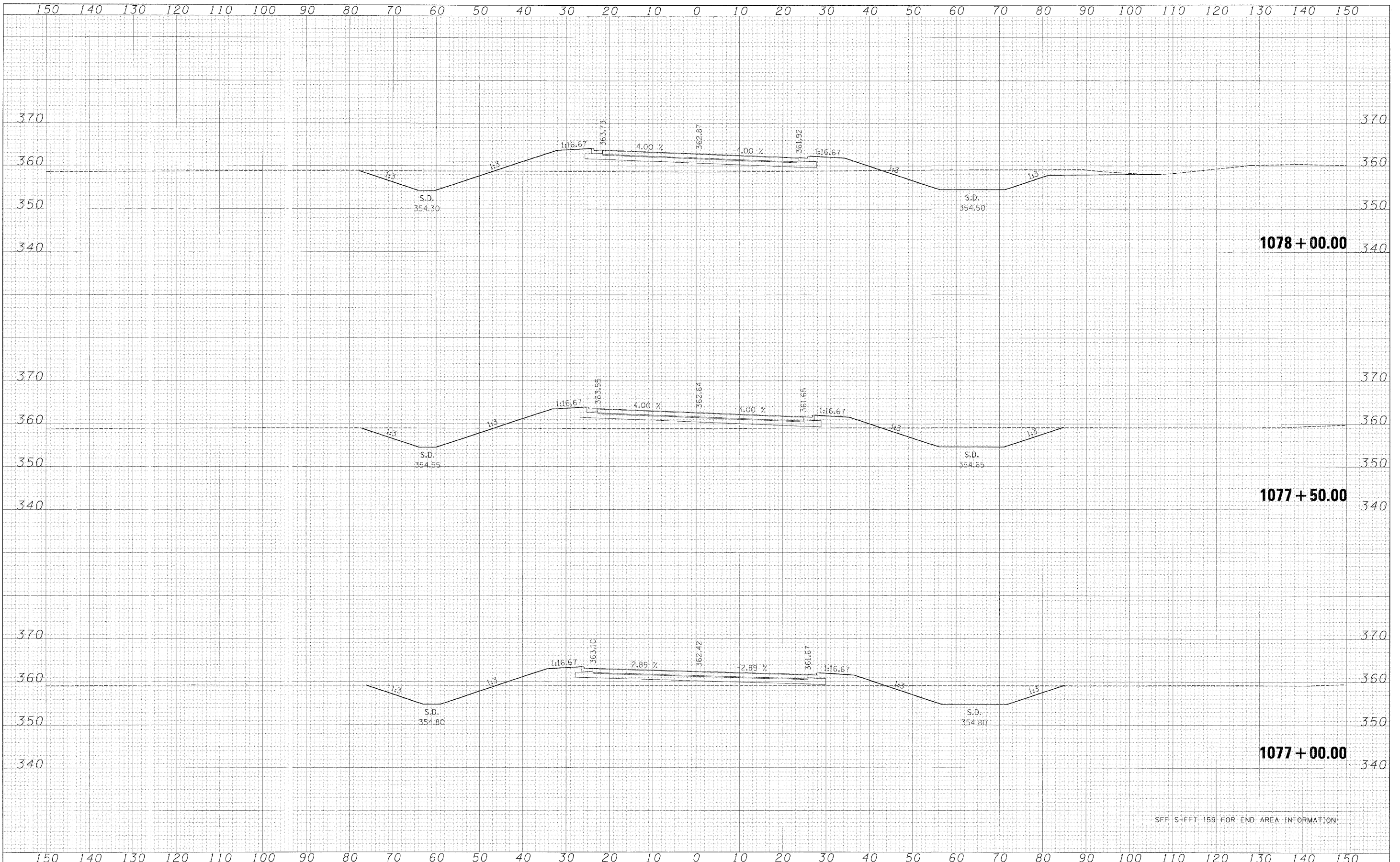

SEE SHEET 159 FOR END AREA INFORMATION

FILE NAME = IL13_east_xsec_sheets.dgn	USER NAME = bweigand	DESIGNED - BJW	REVISED -	STATE OF ILLINOIS DEPARTMENT OF TRANSPORTATION	CROSS SECTIONS-ILL 13 RELOCATION			F.A. RTE. = 331	SECTION = 3-2, 8X-1, (8X-1)B, 4-2	COUNTY = SALINE	TOTAL SHEETS = 193	SHEET NO. = 220	
PLOT SCALE = 1:12	CHECKED - JPN	DATE = 02-02-09	REVISED -		SCALE:	SHEET NO. OF SHEETS =	STA. 1077+00.00 TO STA. 1078-00.00	FED. ROAD DIST. NO. =		ILLINOIS FED. AID PROJECT =	CONTRACT NO. 78058		
PLOT DATE = 2/2/2009	DATE = 02-02-09	REVISED -	REVISED -										