

DATE	
BY	
FINAL SURVEY	
SURVEYED	
PLOTTED	
NOTE BOOK	
AREAS CHECKED	
NO.	

DATE	
BY	
ORIGINAL SURVEY	
SURVEYED	
PLOTTED	
NOTE BOOK	
AREAS CHECKED	
NO.	

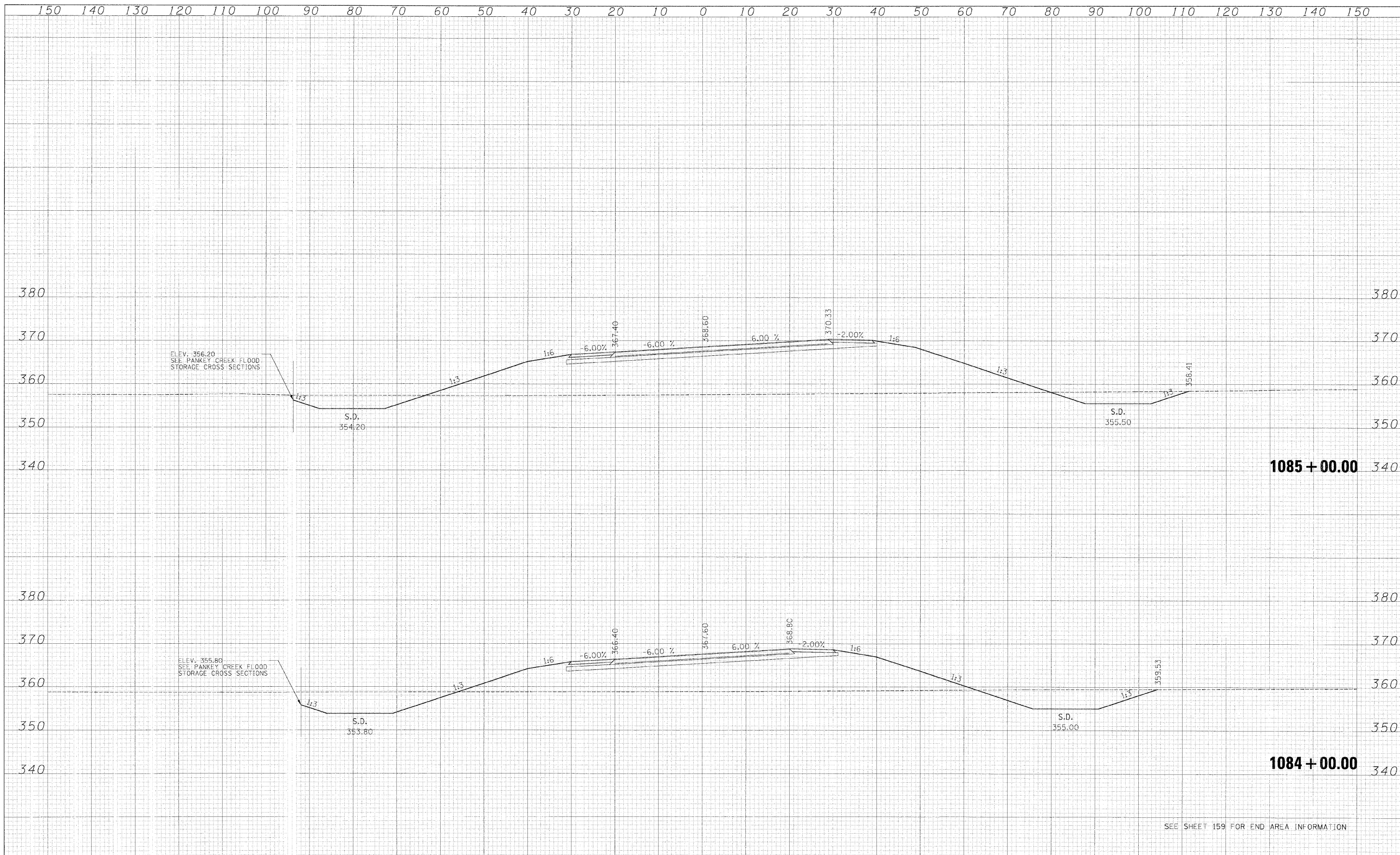

SEE SHEET 159 FOR END AREA INFORMATION

FILE NAME = IL13_east_xsec_sheets.dgn	USER NAME = bweigand	DESIGNED - BJW	REVISED -	<p align="center"><b>STATE OF ILLINOIS</b> <b>DEPARTMENT OF TRANSPORTATION</b></p> <p align="center"><b>CROSS SECTIONS-ILL 13 RELOCATION</b></p>	SCALE: STA. 1084+00.00 TO STA. 1085+00.00
PLOT SCALE = 1:10	CHECKED - JPN	DATE - 02-02-09	REVISED -		SHEET NO. OF SHEETS
PLOT DATE = 2/2/2009					STA. 1084+00.00 TO STA. 1085+00.00
					FED. ROAD DIST. NO. ILLINOIS FED. AID PROJECT

F.A. RTE.	SECTION	COUNTY	TOTAL SHEETS	SHEET NO.
331	3-2, 8X-1, (8X-1)B, 4-2	SALINE	197	220
CONTRACT NO. 78058				