

LOCAL R.T.E.	SECTION	COUNTY	TOTAL SHEETS	SHEET NO.
M.S. 1040	05-00010-00-PV	HENRY	136	12
STA. 5+00		TO STA. 20+15		
FED. ROAD DIST. NO. 2 ILLINOIS FED. AID PROJECT				

SHIVE-HATTERY
 Cedar Rapids, IA • Iowa City, IA • Des Moines, IA
 Moline, IL • Bloomington, IL • Chicago, IL

SHIVE-HATTERY, INC. 1701 RIVER DRIVE, SUITE 200 Moline, IL 61265
 PHONE (309) 764-7650 FAX (309) 764-8616
 http://www.shive-hattery.com
 ILLINOIS FIRM NUMBER: 184-000214

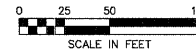

DATE	BY

DATE	BY

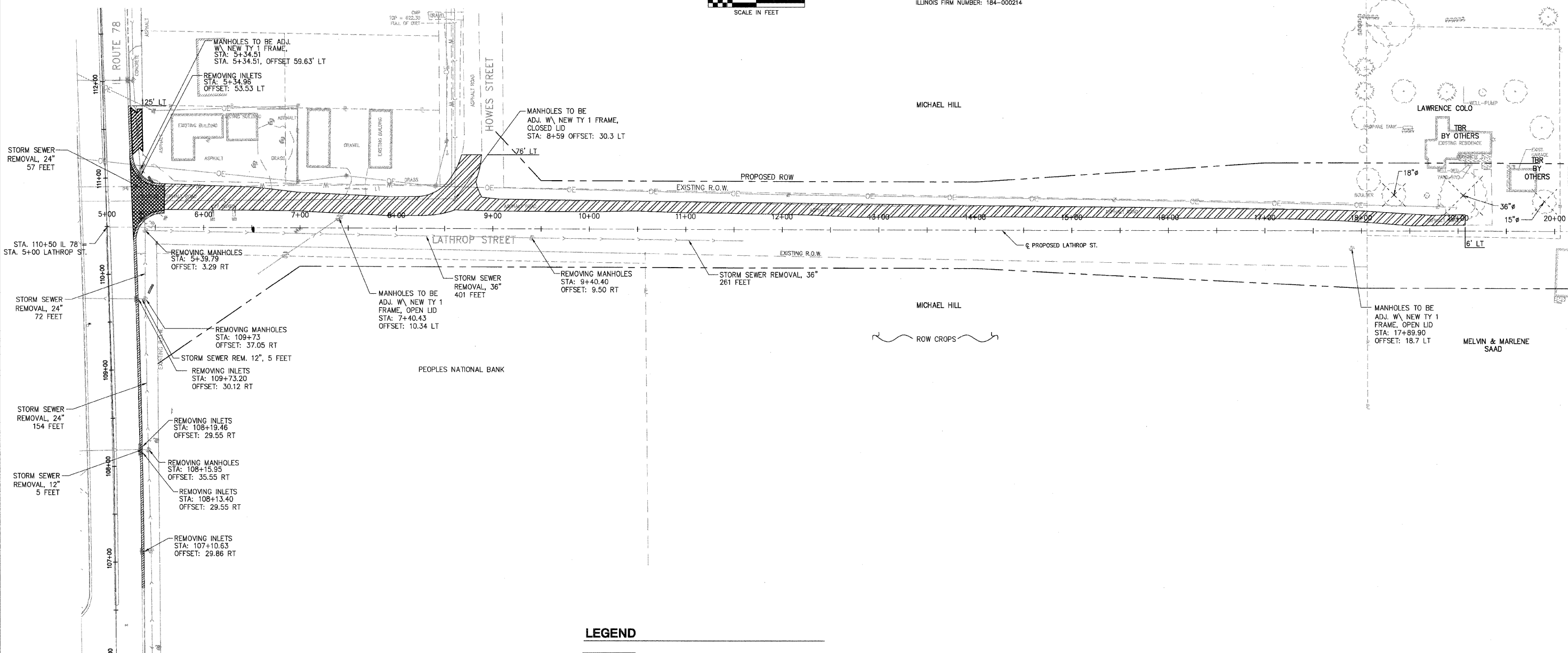

LEGEND

- COMBINATION CURB AND GUTTER REMOVAL
- PCC PAVEMENT REMOVAL
- PCC DRIVEWAY PAVEMENT REMOVAL
- HMA PAVEMENT REMOVAL
- TBR TO BE REMOVED
- TREE REMOVAL

REVISIONS	
NAME	DATE

ILLINOIS DEPARTMENT OF TRANSPORTATION

DEMOLITION SHEET
1 OF 6

SCALE: VERT. DRAWN BY MAC
 HORIZ. CHECKED BY PMH
 DATE: 03-11-09

PLOT DATE * * * * *
 FILE NAME * * * * *
 PLOT SCALE * * * * *
 USER NAME * * * * *