

CONTRACT NO. 85428				
LOCAL RTE.	SECTION	COUNTY	TOTAL SHEETS	SHEET NO.
M.S. 1040	05-00010-00-PV	HENRY	136	21
STA. 52+00		TO STA. 65+00		
FED. ROAD DIST. NO. 2 ILLINOIS FED. AID PROJECT				

SHIVE HATTERY
 Cedar Rapids, IA · Iowa City, IA · Des Moines, IA
 Moline, IL · Bloomington, IL · Chicago, IL
 SHIVE-HATTERY, INC. 1701 RIVER DRIVE, SUITE 200 MOLINE, IL 61265
 PHONE (309) 764-7650 FAX (309) 764-8616
 http://www.shive-hattery.com
 ILLINOIS FIRM NUMBER: 184-000214

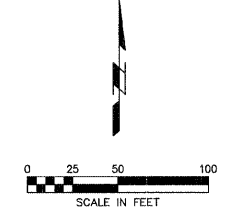

PLAN	DATE	BY
SURVEYED		
PLOTTED		
ALIGNED		
CHECKED		
CADD FILE NAME		

PROFILE	DATE	BY
SURVEYED		
PLOTTED		
CHECKED		
STRUCTURE NOTATIONS CHRD		

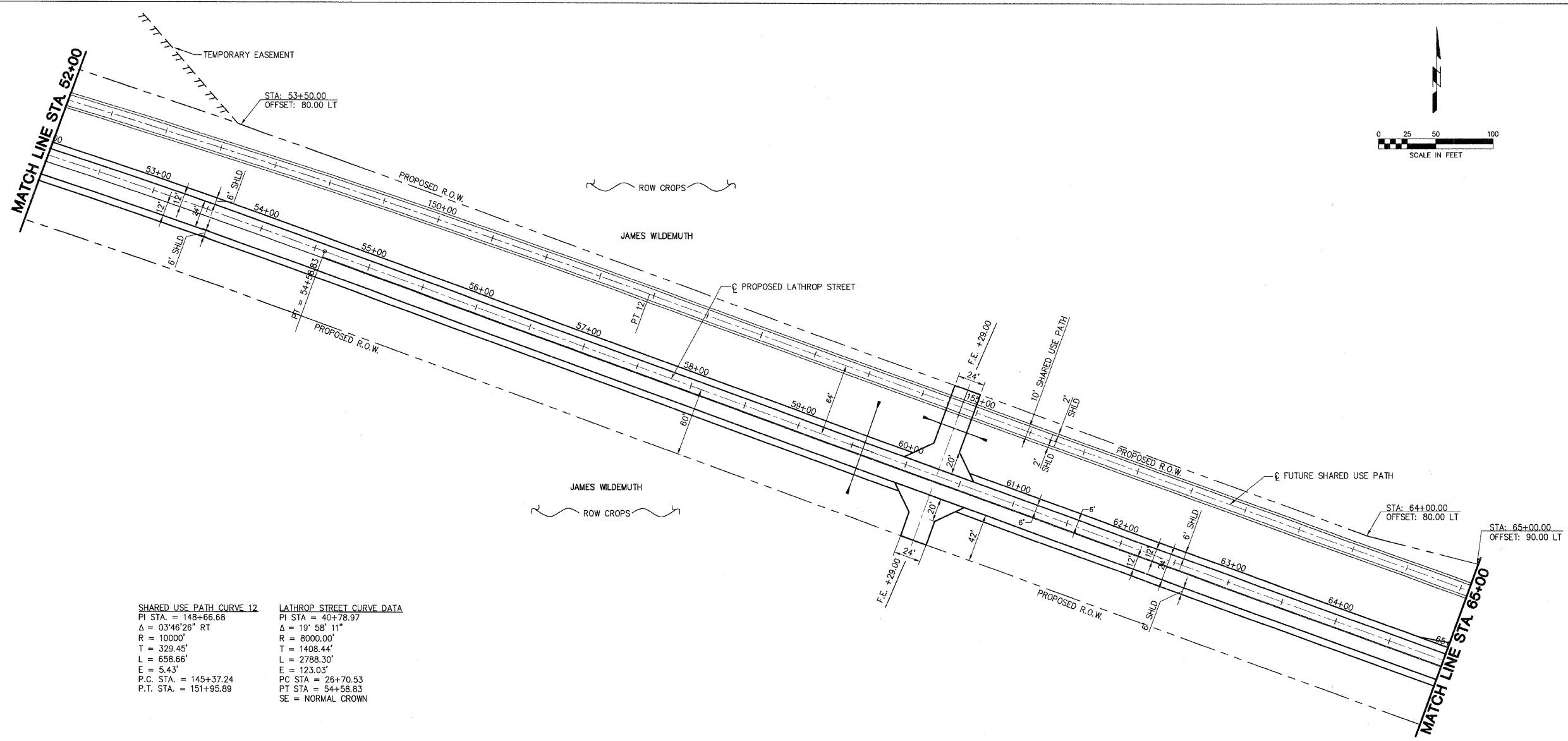

SHARED USE PATH CURVE 12
 PI STA = 148+66.66
 $\Delta = 03^{\circ}46'26''$ RT
 R = 10000'
 T = 329.45'
 L = 658.66'
 E = 5.43'
 P.C. STA = 145+37.24
 P.T. STA = 151+95.89

LATHROP STREET CURVE DATA
 PI STA = 40+78.97
 $\Delta = 19^{\circ}58'11''$
 R = 8000.00'
 T = 1408.44'
 L = 2788.30'
 E = 123.03'
 PC STA = 26+70.53
 PT STA = 54+58.83
 SE = NORMAL CROWN

LOW POINT ELEV = 625.50
 LOW POINT STA = 64+12.50
 PW STA = 62+00
 PVI ELEV = 625.50
 A.D. = 0.58
 K = 728.57
 425.00' VC

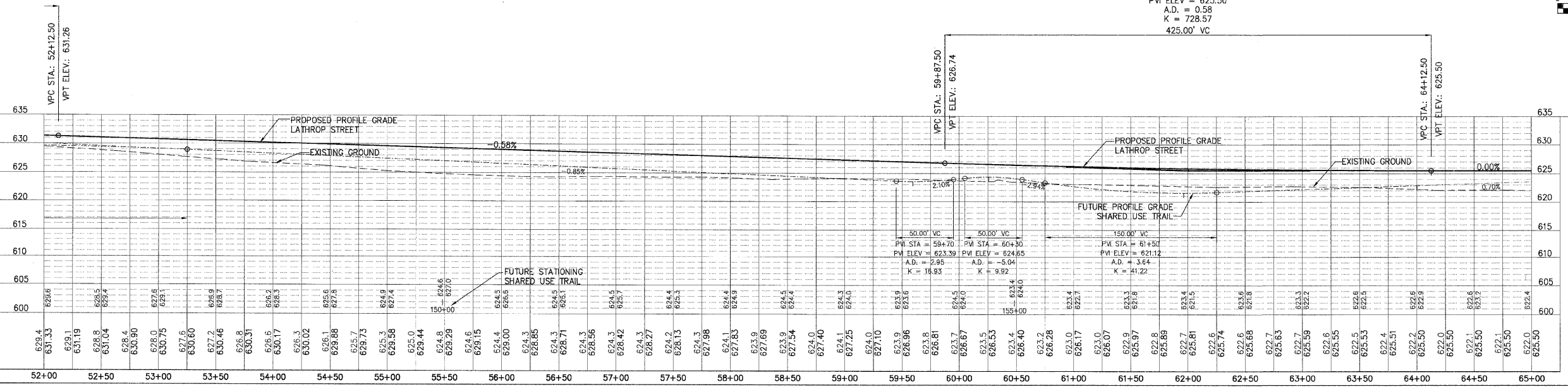
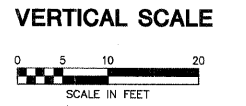
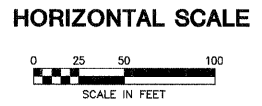

PLOT DATE = 4/20/15
 FILE NAME = 441E115
 PLOT SCALE = 1/4"=1'-0"
 USER NAME = JUSERS