

LOCAL R.T.E.	SECTION	COUNTY	TOTAL SHEETS	SHEET NO.
M.S. 1040	05-00010-00-PV	HENRY	136	43
STA. 65+00		TO STA. 81+00		
FED. ROAD DIST. NO. 2 ILLINOIS FED. AID PROJECT				

**SHIVE HATTERY**  
 Cedar Rapids, IA · Iowa City, IA · Des Moines, IA  
 Moline, IL · Bloomington, IL · Chicago, IL  
 SHIVE-HATTERY, INC. 1701 RIVER DRIVE, SUITE 200 MOLINE, IL 61265  
 PHONE (309) 764-7850 FAX (309) 764-8616  
 http://www.shive-hattery.com  
 ILLINOIS FIRM NUMBER: 184-000214

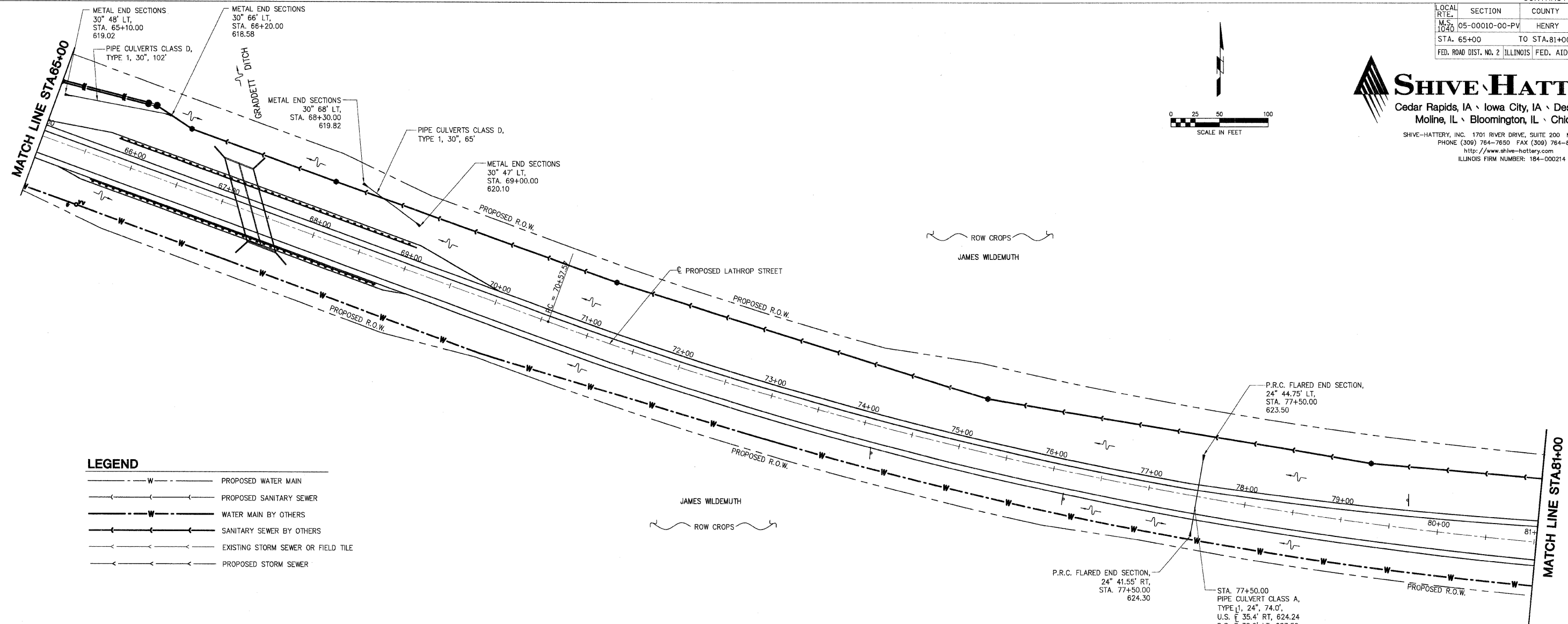
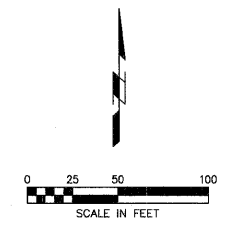

**LEGEND**

- W — PROPOSED WATER MAIN
- S — PROPOSED SANITARY SEWER
- W — WATER MAIN BY OTHERS
- S — SANITARY SEWER BY OTHERS
- ST — EXISTING STORM SEWER OR FIELD TILE
- ST — PROPOSED STORM SEWER

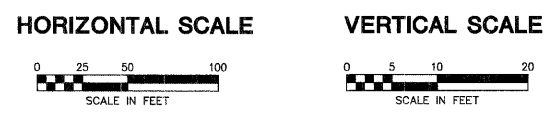

PLAN

DATE	
BY	
REVISIONS	
NO.	
DESCRIPTION	
DATE	
BY	
NO.	
DESCRIPTION	
DATE	
BY	
NO.	
DESCRIPTION	

PROFILE

DATE	
BY	
REVISIONS	
NO.	
DESCRIPTION	
DATE	
BY	
NO.	
DESCRIPTION	
DATE	
BY	
NO.	
DESCRIPTION	

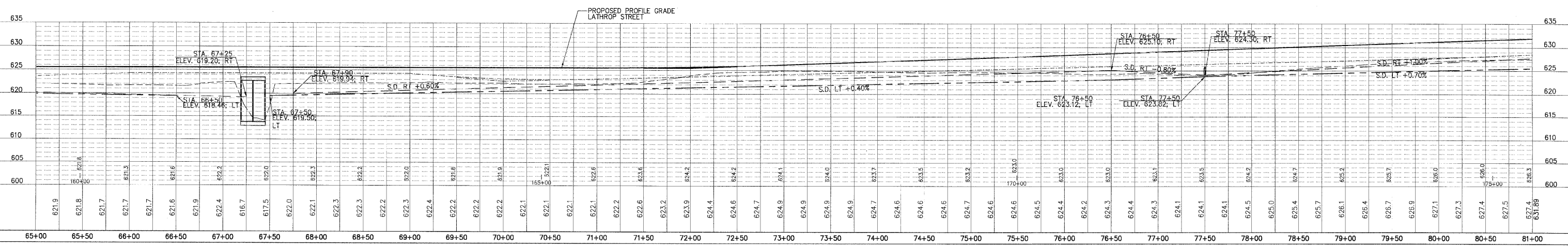

PLOT DATE = 04/15/04  
 FILE NAME = 85428.PV  
 PLOT SCALE = 1/4"=1'-0"  
 USER NAME = BUSHER