

P:\07193193-02\Drawings\CH\07193-02_off ramp & wall.dwg, 10/11, 3/8/2009 2:10:14 PM

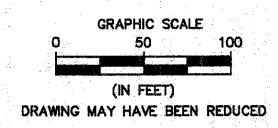

PLAN VIEW

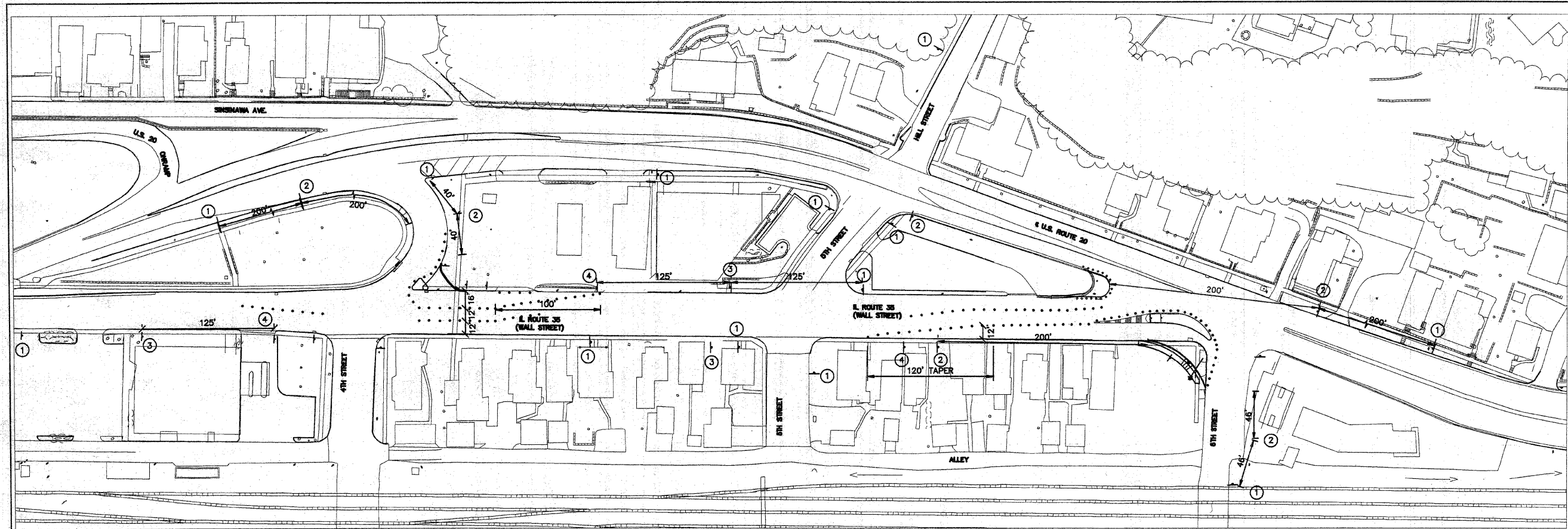
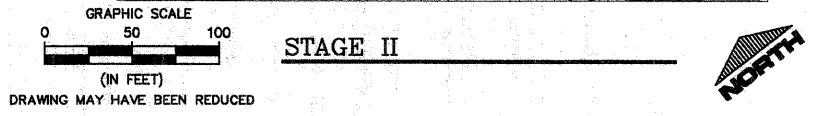
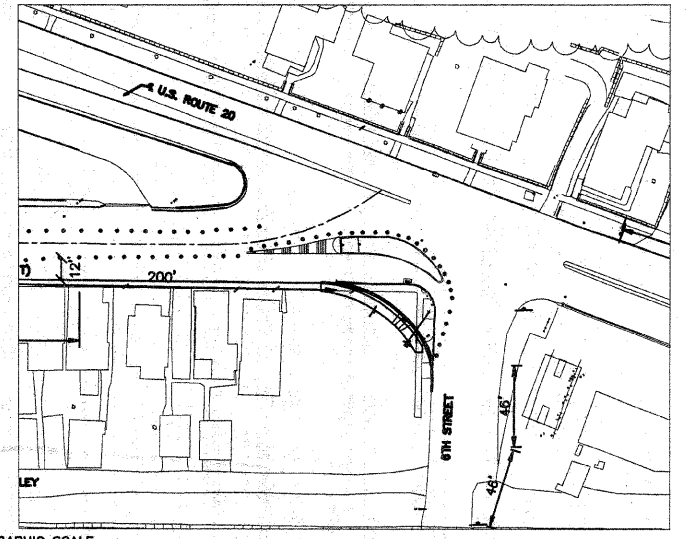
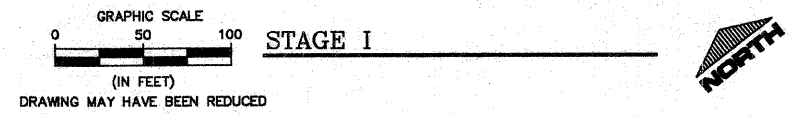
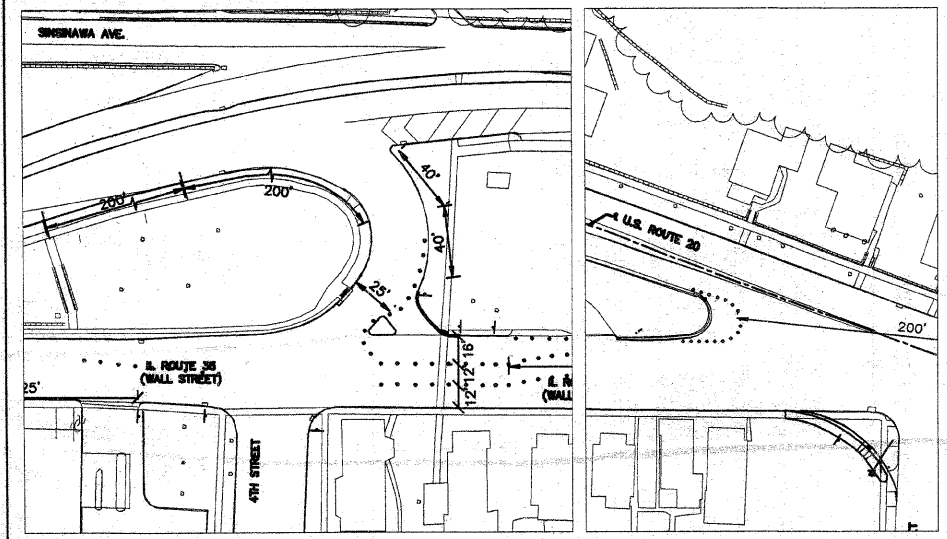

SYMBOLS AND NOTES			
①		③	
	W20-1(0)-48	④	
	OR		
②			DRUM OR BARRICADE WITH MONODIRECTIONAL STEADY BURNING LIGHT
			WORK AREA
			NOTES: 1. DRUMS OR BARRICADES AT 25' CENTERS.

SEE ILLINOIS D.O.T. STANDARDS - 701301, 701331, 701501, 701502, 701801, 701901
NOTE: SAWCUT ALL CONCRETE REMOVAL AREAS.

Rev: Issued For:	DOT SUBMITTAL	Issued Date:	02-28-08	Rev By:	LEN
Rev: Issued For:	DOT SUBMITTAL	Issued Date:	02-05-09	Rev By:	LEN
Rev: Issued For:	DOT SUBMITTAL	Issued Date:	11-13-08	Rev By:	LEN
Rev: Issued For:	DOT SUBMITTAL	Issued Date:	08-25-08	Rev By:	LEN
Rev: Issued For:	DOT SUBMITTAL	Issued Date:	07-10-08	Rev By:	LEN
Rev: Issued For:	DOT SUBMITTAL	Issued Date:	03-19-08	Rev By:	LEN

Sheet Title: TRAFFIC CONTROL

Project Description: CITY OF EAST DUBUQUE, IL
WALL STREET/6TH STREET AND
WALL STREET/US 20 RAMP
INTERSECTIONS

IIV ENGINEERS & SURVEYORS, P.C.
1100 N. WASHINGTON ST., SUITE 200
DUBUQUE, IOWA 52001
PHONE: 563-201-1111 FAX: 563-201-1112
WWW.IIVENGINEERS.COM

Project Mgr: MCI
Project Number: 07193-02

10 of 11