

STATE OF ILLINOIS  
DEPARTMENT OF TRANSPORTATION  
BUREAU OF LOCAL ROADS & STREETS

F.A. - RTE.	SECTION	COUNTY	TOTAL SHEETS	SHEET NO.
09-00033-00-CH	JD DAVIESS	11	1	1

# WALL STREET/6TH STREET AND WALL STREET/US 20 RAMP INTERSECTIONS

JO DAVIESS COUNTY  
CITY OF EAST DUBUQUE, ILLINOIS  
FAP 306 (IL35 - WALL ST.)  
SECTION NO. 09-00033-00-CH  
PROJECT ARA-M-5206 (003)  
JOB NO. C-92-088-09  
CONTRACT 85450

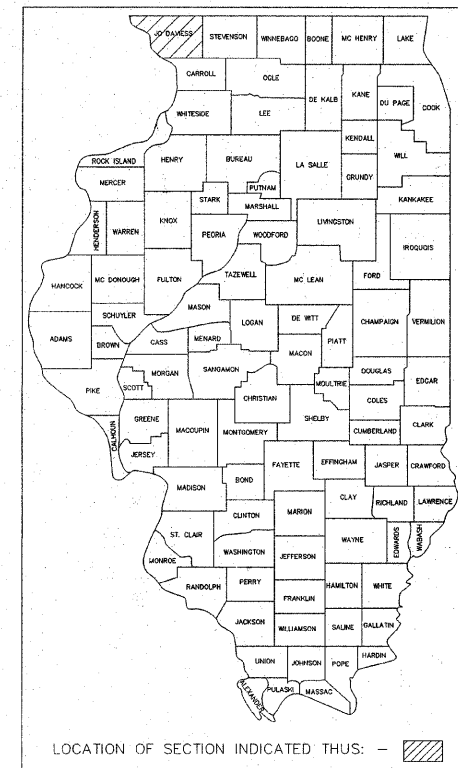

## SHEET INDEX

SHEET NUMBER	SHEET TITLE
1	COVER SHEET
2	ABBREVIATIONS, LEGEND AND GEN. NOTES
3	QUANTITIES AND NOTES
4	DETAILS
5	WALL STREET/US 20 RAMP
6	STRIPING AND SIGNAGE WALL STREET/US 20 RAMP
7	WALL STREET/6TH STREET
8	INTERSECTION PLAN WALL STREET/6TH STREET
9	STRIPING AND SIGNAGE WALL STREET/6TH STREET
10	TRAFFIC CONTROL
11	DISTRICT STANDARD 10.2 (11-10-94), 60.2 (09-19-05)

## TRAFFIC CONTROL PLAN

THIS ROAD WILL BE MAINTAINED OPEN TO THROUGH TRAFFIC DURING CONSTRUCTION AS LONG AS POSSIBLE. CONTRACTOR SHALL SUBMIT ROAD CLOSURE PLAN AND SCHEDULE TO CITY MANAGER FOR REVIEW AND APPROVAL PRIOR TO CLOSING ROAD. LOCAL TRAFFIC TO ADJACENT PROPERTIES WILL BE MAINTAINED AS PROVIDED FOR IN ARTICLE 1107.08 OF THE CURRENT STANDARD SPECIFICATIONS. TRAFFIC CONTROL DEVICES, PROCEDURES, AND LAYOUTS SHALL BE AS PER CURRENT PART VI OF THE MANUAL OF UNIFORM TRAFFIC CONTROL DEVICES (MUTCD).

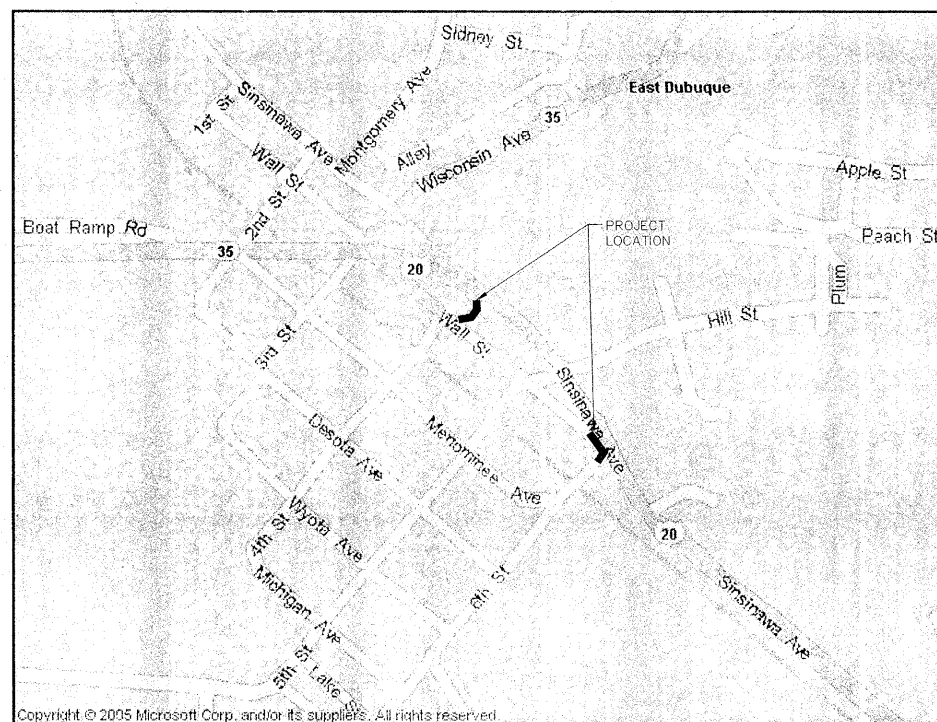

STANDARDS	
280001-04	701501-05
420001-07	701701-06
424001-05	701801-04
606001-04	701901-01
606301-04	720011-01
606306-03	728001-01
701006-03	729001-01
701301-03	

NET PROJECT LENGTH = 0.05 MI

LOCATION MAP  
NO SCALE



### SCALES:

PLAN AND PROFILE

HORIZONTAL 0 20' 40' 60' 1" = 20'

VERTICAL 0 5' 10' 15' 1" = 5'

FULL SIZE PLANS HAVE BEEN PREPARED USING STANDARD ENGINEERING SCALES. REDUCED SIZED PLANS WILL NOT CONFORM TO STANDARD SCALES. IN MAKING MEASUREMENTS ON REDUCED PLANS, THE ABOVE SCALES MAY BE USED.

J.U.L.I.E.  
JOINT UTILITY LOCATION INFORMATION FOR EXCAVATION  
1-800-892-0123

ADT = 1300 (2028) WALL ST. 10% TRUCKS  
ARTERIAL

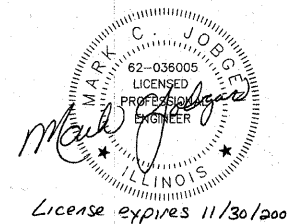

STATE OF ILLINOIS DEPARTMENT OF TRANSPORTATION DIVISION OF HIGHWAYS	
APPROVED	<i>Feb 25 2009</i> <i>[Signature]</i> EAST DUBUQUE CITY MANAGER
PASSED	<i>Feb 27 2009</i> <i>[Signature]</i> DISTRICT ENGINEER OF LOCAL ROADS & STREETS
RELEASING FOR BID BASED ON LIMITED REVIEW	<i>Feb 27 2009</i> <i>[Signature]</i> DEPUTY DIRECTOR OF HIGHWAYS, REGION 2

CIVIL ABBREVIATIONS

Table of Civil Abbreviations with columns for symbol, description, and units. Includes terms like CENTRAL ANGLE, ACRES, ALGEBRAIC DIFFERENCE, etc.

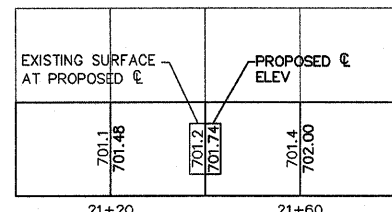

PROFILE LEGEND

VERTICAL CONTROL

THE ELEVATIONS ON THIS PROJECT ARE BASED ON NGVD 29.

UTILITY NOTE

THE LOCATIONS OF THE EXISTING UTILITIES SHOWN ARE APPROXIMATE ONLY. THE UTILITIES PRESENT MAY NOT EXIST AS SHOWN.

UTILITY PROVIDERS:

- WATER & SEWER: CITY OF EAST DUBUQUE (815) - 747-3416
GAS: PEOPLES NATURAL GAS (800) - 772-1112
ELECTRICAL POWER: ALLIANT UTILITIES (319) - 875 - 7471
TELEPHONE: G.T.E. (800) - 336-3144
CABLE TELEVISION: TCI CABLEVISION (800) - 747-8021
CALL JULIE (800) - 892-0123 OR 811

Legend table with columns for EXISTING, LEGEND, and PROPOSED symbols. Includes symbols for PROPERTY LINE, EASEMENT, CENTERLINE, STORM SEWER, etc.

Project Description: CITY OF EAST DUBUQUE, IL WALL STREET/6TH STREET AND WALL STREET/US 20 RAMP INTERSECTIONS

IW ENGINEERS & SURVEYORS, P.C. 4150 UNIVERSITY BLVD. SUITE 200 WASHINGTON, DC 20057-1143



Project Mgr: MCJ Project Number: 07193-02

SUMMARY OF QUANTITIES - CONSTRUCTION TYPE CODE : IOOO

PAY ITEM	PAY ITEM NAME	UNITS	US 20 RAMP	WALL/6TH	TOTAL
20200410	EARTH EXCAVATION (SPECIAL)	CU YD	30	90	120
20800150	TRENCH BACKFILL	CU YD	85	60	145
21101615	TOPSOIL, FURNISH AND PLACE, 4"	SQ YD	30	25	55
25000110	SEEDING, CLASS 1A	ACRE	.005	.005	.01
35100100	AGGREGATE BASE COURSE, TYPE A	TON	35	100	135
40603085	HOT-MIX ASPHALT BINDER COURSE, IL 19.0 N70	TON	25	75	100
40603340	HOT MIX ASPHALT SURFACE COURSE MIX, D N70	TON	10	20	30
42400200	PORTLAND CEMENT CONCRETE SIDEWALK 5 INCH	SQ FT	135	450	585
42400800	DETECTABLE WARNING	SQ FT	25	10	35
44000100	PAVEMENT REMOVAL	SQ YD	0	100	100
44000500	COMBINATION CURB AND GUTTER REMOVAL	FOOT	80	240	320
44000600	SIDEWALK REMOVAL	SQ FT	190	500	690
44213200	SAW CUTS	FOOT	100	230	330
50100100	REMOVAL OF EXISTING STRUCTURES	EACH	1	2	3
55019500	STORM SEWERS,TYPE 1 REINFORCED CONCRETE CULVERT STORM DRAIN AND SEWER PIPE, CLASS IV, 12"	FOOT	34	33	67
* 56109210	WATER VALVES TO BE ADJUSTED	EACH	0	2	2
* 56400400	FIRE HYDRANT TO BE RELOCATED	EACH	0	1	1
60242400	INLET, SPECIAL	EACH	1	2	3
60605000	COMBINATION CONC. CURB AND GUTTER, TYPE B-6.24	FOOT	50	180	230
60621600	CONCRETE MEDIAN, TYPE SM	SQ FT	0	650	650
60624600	CORRUGATED MEDIAN	SQ FT	0	200	200
67100100	MOBILIZATION	L SUM	0.3	0.7	1
70101700	TRAFFIC CONTROL AND PROTECTION	L SUM	0.3	0.7	1
72000100	SIGN PANEL-TYPE 1	SQ FT	18	14	32
72900100	METAL POST-TYPE A	FOOT	32	32	64
* 78000100	THERMOPLASTIC PAVEMENT MARKING-LETTERS & SYMBOLS	SQ FT	35	80	115
* 78000200	THERMOPLASTIC PAVEMENT MARKING-LINE 4"	FOOT	0	1200	1200
* 78000400	THERMOPLASTIC PAVEMENT MARKING-LINE 6"	FOOT	110	0	110
* 78000500	THERMOPLASTIC PAVEMENT MARKING-LINE 8"	FOOT	310	80	390
* 78000600	THERMOPLASTIC PAVEMENT MARKING-LINE 12"	FOOT	180	80	260
* 78000650	THERMOPLASTIC PAVEMENT MARKING-LINE 24"	FOOT	45	60	105
78300500	PAINT PAVEMENT MARKING REMOVAL	FOOT	0	58	58

\* SPECIALTY ITEMS

GENERAL NOTES:

- EARTH EXCAVATION (SPECIAL) - CONTRACTOR SHALL BE RESPONSIBLE FOR DISPOSAL OF ALL WASTE MATERIAL. SUITABLE MATERIAL SHALL BE SALVAGED AND PLACED BEHIND CURBS TO AN ELEVATION THAT IS 4" BELOW THE FINAL GRADE. EXCAVATION INCLUDES THE REMOVAL OF ALL MATERIAL, ASPHALT, CONCRETE, STONE, AND EARTH NECESSARY TO COMPLETE THE PROJECT UNLESS SPECIFICALLY IDENTIFIED AS A REMOVAL ITEM.
- INLET SPECIAL - UNIT PRICE INCLUDES FRAME AND GRATE.
- REMOVAL OF EXISTING STRUCTURES - CONTRACTOR SHALL REMOVE EXISTING CATCH BASINS AND CONNECT NEW STORM SEWER TO EXISTING STORM SEWER. THE CONTRACTOR SHALL BE RESPONSIBLE FOR DISPOSAL OF EXCESS MATERIAL.
- TRAFFIC CONTROL AND PROTECTION - CONTRACTOR SHALL BE RESPONSIBLE FOR MAINTAINING A SAFE CONSTRUCTION ZONE FOR PEDESTRIANS, TRAVELING PUBLIC, AND CONSTRUCTION PERSONNEL.
- NEW STOP SIGN TO BE LOCATED IN ISLAND. RELOCATE STOP SIGNS AT WALL STREET & OFF RAMP INTERSECTION AND WALL STREET AND 6TH STREET INTERSECTION AS PER 107.25 OF THE STANDARD SPECIFICATIONS FOR ROAD AND BRIDGE CONSTRUCTION.

SIGN PANEL				
SIGN	LEGEND	SIZE	POST	REMARK
R1-1	STOP	9 SQ. FT.	16'	WALL AND 4TH STREET MOUNTED BELOW STOP SIGN @ WALL & 4TH
W4-4p	TRAFFIC FROM LEFT DOES NOT STOP	3 SQ. FT.		MOUNT BELOW EX. STOP SIGN @ 4TH ST.
W4-4p	ONCOMING TRAFFIC DOES NOT STOP	3 SQ. FT.		MOUNT BELOW RELOCATED STOP SIGN @ WALL & OFF RAMP
W4-4p	TRAFFIC FROM RIGHT DOES NOT STOP	3 SQ. FT.		
R3-1	NO RIGHT TURN		16'	REMOVE FROM STOP SIGN & MOUNT AT WALL & OFF RAMP
R1-1	STOP	9 SQ. FT.	16'	MOUNT IN ISLAND
RA-7A	KEEP RIGHT	5 SQ. FT.	16'	MOUNT IN ISLAND

N70 (NORMAL)

MIXTURE USES(S):	SURFACE	BINDER
PG:	PG 64-22	PG 64-22
DESIGN AIR VOIDS	4.0 @ N70	4.0 @ N70
MIXTURE COMPOSITION (GRADATION MIXTURE)	IL 9.5 OR 12.5	IL 19.0
FRICTION AGGREGATE	D	N/A
20 YEAR ESAL	0.0	0.0
MIX UNIT WEIGHT	112 LBS/SY/IN	

Rev	Issued For	Issued Date	Rev By
	DOT SUBMITTAL	02-26-08	LEN
	DOT SUBMITTAL	02-06-08	LEN
	DOT SUBMITTAL	11-13-08	LEN
	DOT SUBMITTAL	09-29-08	LEN
	DOT SUBMITTAL	07-10-08	LEN
	DOT SUBMITTAL	03-10-08	LEN

Sheet Title:  
QUANTITIES AND NOTES

Project Description:  
CITY OF EAST DUBUQUE, IL  
WALL STREET/6TH STREET AND  
WALL STREET/US 20 RAMP  
INTERSECTIONS

IW ENGINEERS & SURVEYORS, P.C.  
INCORPORATED  
415 FRENCHMAN AVE. DUBUQUE, IA 52002  
PHONE: (562) 244-4444 FAX: (562) 244-4441  
www.iw-engineers.com



Project Mgr: MCJ  
Project Number:  
07193-02

P:\071831\02\Drawings\Civil\07183-02\_cff ramp & wall.dwg, 4c11, 2/25/2009 2:45:29 PM

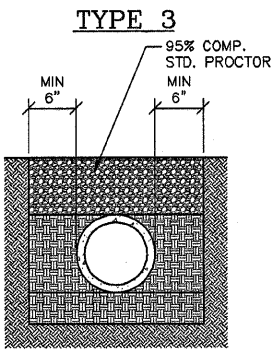

PIPE BEDDED ON 4" MIN FINELY DIVIDED NATIVE SOIL EXCAVATED FROM TRENCH, FREE OF ROCKS, FOREIGN MATERIALS, AND FROZEN EARTH. INITIAL BACKFILL CONSOLIDATED TO TOP OF PIPE (75% STANDARD PROCTOR - ASTM D698)

- EMBEDMENT
- TAMPED SOIL
- NATURAL SOIL
- ROCK
- FINAL BACKFILL

1 PIPE BEDDING DETAIL  
4 STMS NOT TO SCALE

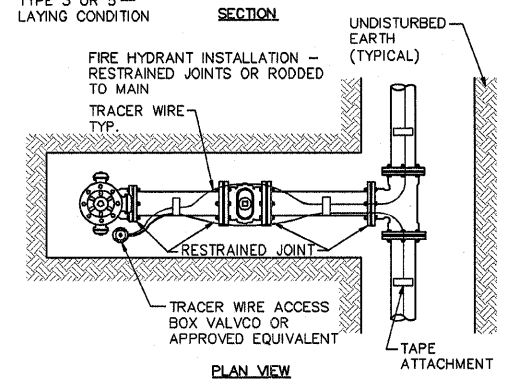
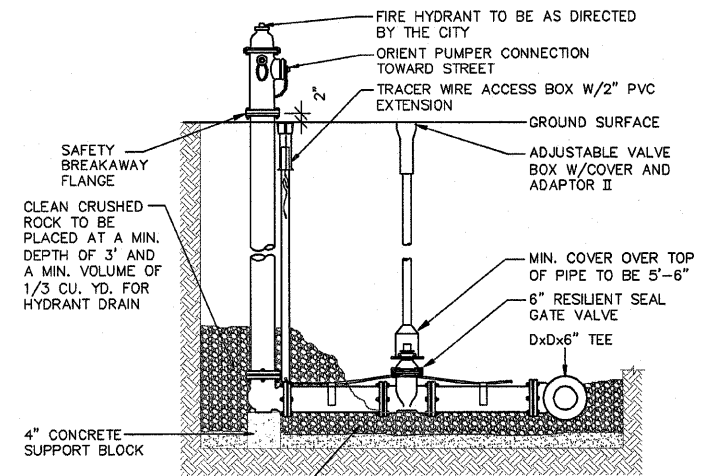

2 HYDRANT DETAIL  
4 NOT TO SCALE

GENERAL NOTES:  
ILLINOIS SPECIAL PROVISIONS FOR CONSTRUCTION OF WATER MAIN WITHIN THE ROW SHALL APPLY.

Rev:	Issued For:	Issued Date:	Rev By:
	DOT SUBMITTAL	02-26-08	LEN
	DOT SUBMITTAL	02-05-08	LEN
	DOT SUBMITTAL	11-13-08	LEN
	DOT SUBMITTAL	08-25-08	LEN
	DOT SUBMITTAL	07-10-08	LEN
	DOT SUBMITTAL	03-19-08	LEN

Project Description:  
CITY OF EAST DUBUQUE, ILL.  
WALL STREET/6TH STREET AND  
WALL STREET/US 20 RAMP  
INTERSECTIONS

Sheet Title:  
DETAILS

IW ENGINEERS & SURVEYORS, P.C.  
ENGINEERING, SURVEYING, SOLUTIONS  
1000 N. WASHINGTON AVE. SUITE 200  
DUBUQUE, ILLINOIS 62002  
PH: 314.281.1111 FAX: 314.281.1111



Project Mgr: MCJ  
Project Number:  
07183-02

4of11

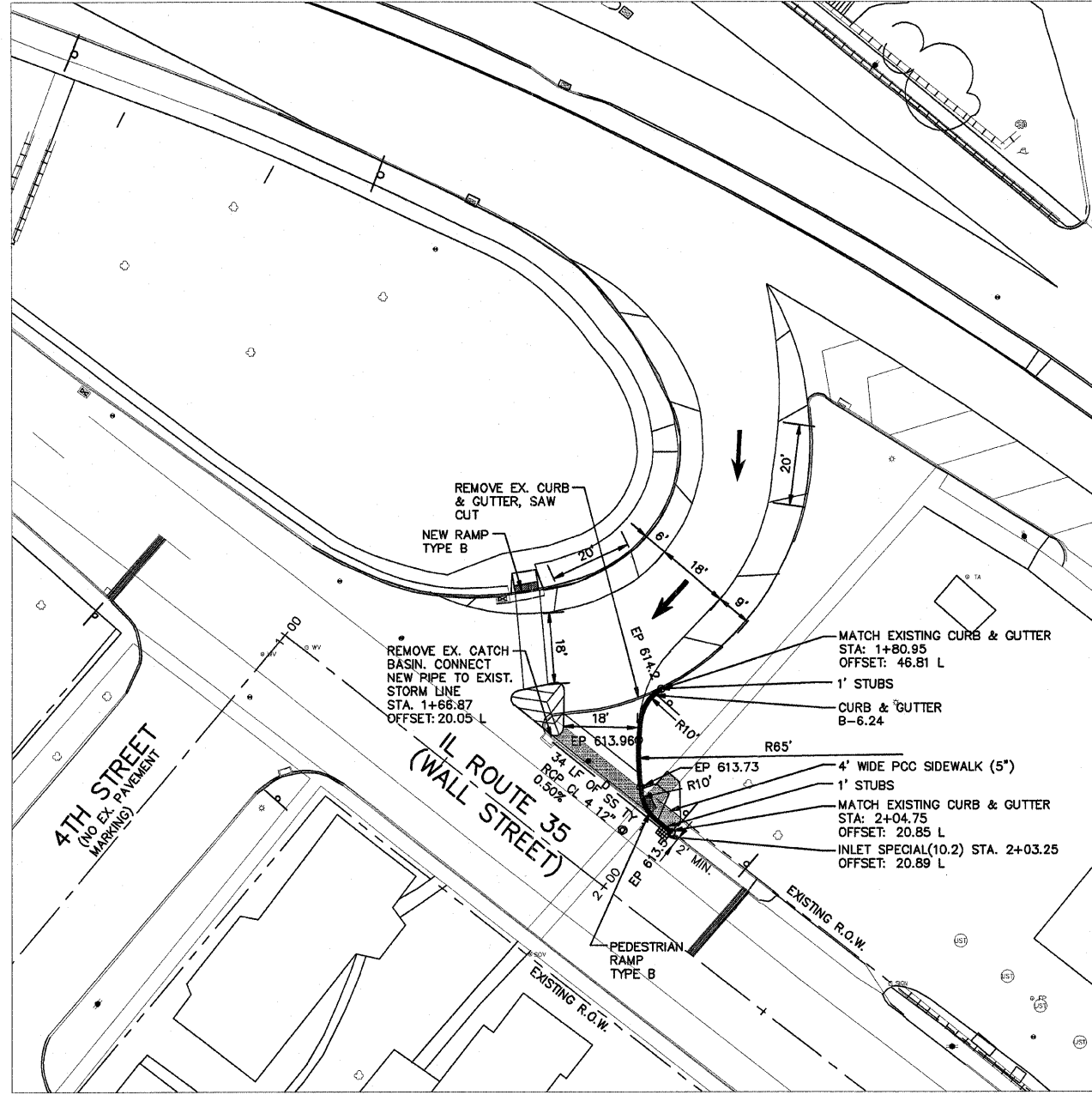

GENERAL NOTES

1. ALL DIMENSIONS ARE SHOWN EDGE OF PAVEMENT TO EDGE OF PAVEMENT UNLESS NOTED.
2. TURNING MOVEMENTS CHECKED WITH AUTOTURN.
3. STOP SIGNS AND SUPPLEMENTARY PLAQUES WILL BE PLACED BY OTHERS
4. TRAFFIC FROM BRIDGE WILL BE FREE FLOW ON TO WALL STREET.
5. FIELD VERIFY ELEVATIONS OF FLOWLINE IN EXISTING CATCH BASIN.
6. REMOVE CATCH BASIN @ STA. 1+66.87. MAINTAIN EXISTING GRADES.

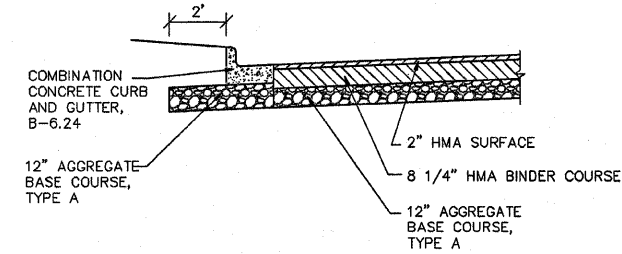

1  
5

TYPICAL SECTION HMA PAVING

FULL DEPTH LOCATIONS

NOT TO SCALE

EXCEPT FOR THE TOP 75 MM (3"), ALL AGGREGATE BASES AND SUBBASES 300 MM (12") IN THICKNESS SHALL BE CONSTRUCTED OF AGGREGATE GRADATION CA-2. IF THE SPECIFIED THICKNESS EXCEEDS 300 MM (12"), THE BASES OR SUBBASES SHALL BE CONSTRUCTED OF TOPSIZE 150 MM (6") BREAKER-RUN CRUSHED STONE WITH 70% TO 90% BY WEIGHT, PASSING THE 4" SIEVE AND 15% TO 40% BY WEIGHT, PASSING THE 50 MM (2") SIZE SIEVE, EXCEPT FOR THE TOP 75 MM (3"). THE BREAKER-RUN CRUSHED STONE SHALL BE REASONABLY UNIFORMLY GRADED FROM COARSE TO FINE AND BE TAKEN FROM A QUARRY LEDGE CAPABLE OF PRODUCING CLASS "D" QUALITY AGGREGATE. THE TOP 75 MM (3") SHALL BE GRADATION CA-6 OR CA-10 REGARDLESS OF THICKNESS. THE WATER NECESSARY TO ACHIEVE COMPACTION IN ALL BUT THE TOP 75 MM (3") LAYER MAY BE ADDED AFTER THE SUBBASE OR BASE COURSE IS PLACED ON THE GRADE.

PREVIOUSLY PUGMILLED STOCKPILES OF "TYPE A" OLDER THAN 1 MONTH WILL NOT BE APPROVED FOR USE UNTIL A MOISTURE CHECK IS RUN TO VERIFY MOISTURE CONTENT. MATERIAL SHIPPED TO PROJECTS WITHOUT BEING TESTED WILL NOT BE ACCEPTED.

Rev:	Issued For:	Issued Date:	Rev By:	LEN
	DOT SUBMITTAL	02-26-08		LEN
	DOT SUBMITTAL	02-06-09		LEN
	DOT SUBMITTAL	11-19-08		LEN
	DOT SUBMITTAL	08-25-08		LEN
	DOT SUBMITTAL	07-10-08		LEN
	DOT SUBMITTAL	03-19-08		LEN

Sheet Title: WALL ST./US 20 RAMP

Project Description: CITY OF EAST DUBUQUE, IL WALL STREET/6TH STREET AND WALL STREET/US 20 RAMP INTERSECTIONS

IW ENGINEERS & SURVEYORS, P.C.  
ENGINEERING, SURVEYING, ARCHITECTURE  
1000 W. UNIVERSITY AVENUE, DUBUQUE, IA 52002  
415 FRENCH AVENUE, DUBUQUE, IA 52001  
VOCATIONAL/TECHNICAL SKILLS CENTER



Project Mgr: MCF  
Project Number: 07193-02

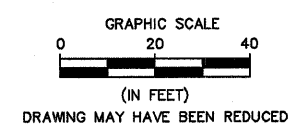
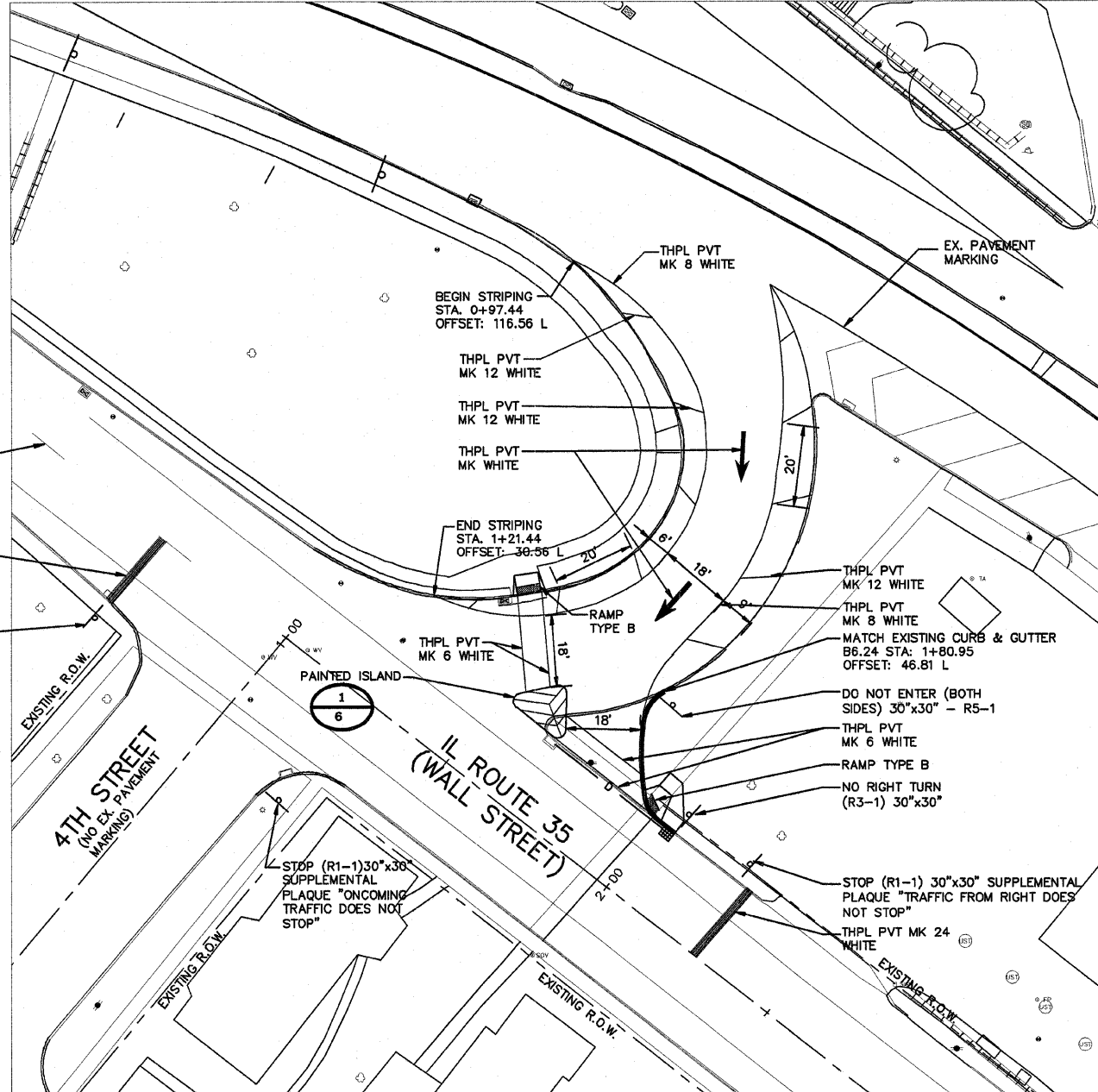

PLAN VIEW



GENERAL NOTES  
ALL PAVEMENT MARKINGS SHALL CONFORM TO ILLINOIS MUTCD

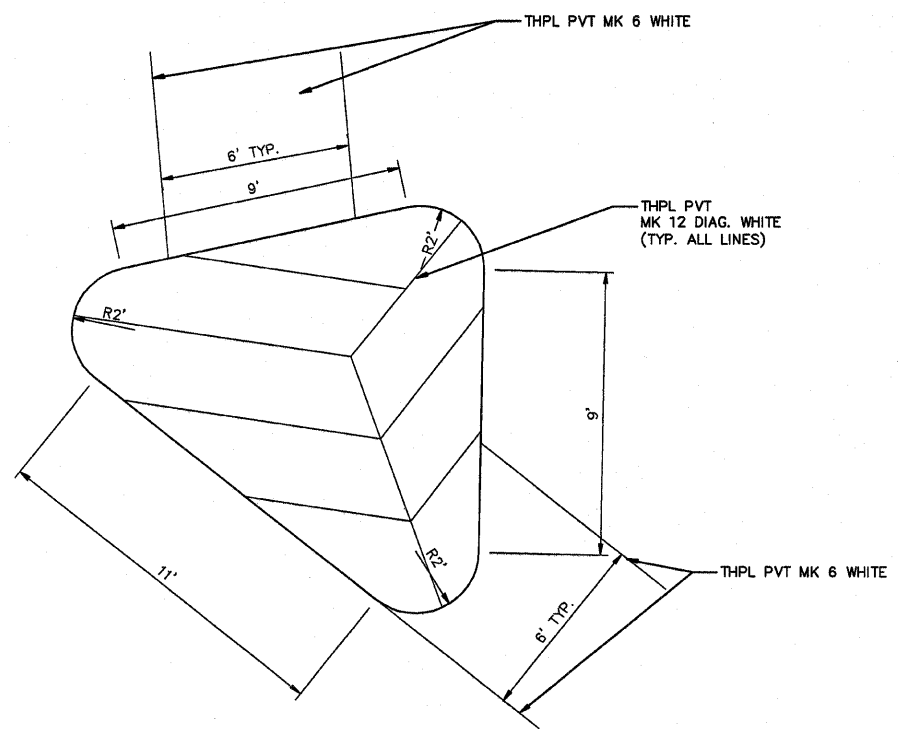

PAINTED ISLAND DETAIL  
NOT TO SCALE

Rev.	Issued For:	Issued Date:	Rev. By:	LEN
	DOT SUBMITTAL	02-26-08		LEN
	DOT SUBMITTAL	02-05-08		LEN
	DOT SUBMITTAL	11-13-08		LEN
	DOT SUBMITTAL	08-25-08		LEN
	DOT SUBMITTAL	07-10-08		LEN
	DOT SUBMITTAL	03-19-08		LEN

Sheet Title:  
STRIPING AND SIGNAGE  
WALL ST./US 20 RAMP

Project Description:  
CITY OF EAST DUBUQUE, IL  
WALL STREET/6TH STREET AND  
WALL STREET/US 20 RAMP  
INTERSECTIONS

**I/W ENGINEERS & SURVEYORS, P.C.**  
ENGINEERING, SURVEYING, MEASURING  
4150 UNIVERSITY BLVD., SUITE 200  
DUBUQUE, IOWA 52002  
PHONE: 319.261.1111 FAX: 319.261.1111  
www.iwsurveyors.com



Project Mgr: MCJ  
Project Number:  
07183-02

**6of11**



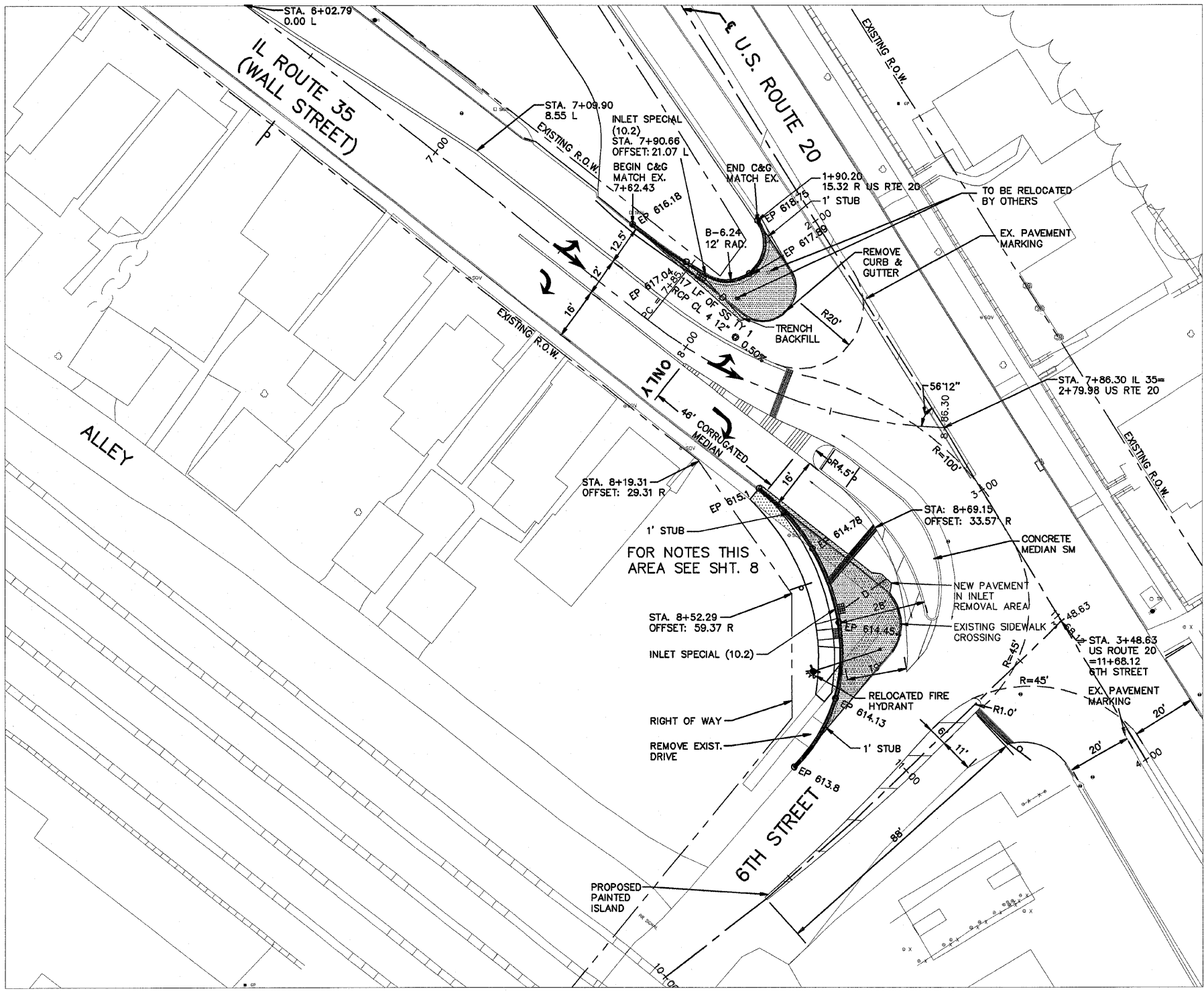

- GENERAL NOTES**
1. ALL DIMENSIONS ARE SHOWN EDGE OF PAVEMENT TO EDGE OF PAVEMENT UNLESS NOTED.
  2. FIELD VERIFY ELEVATIONS OF FLOWLINE IN EXISTING CATCH BASINS.
  3. REMOVE CATCH BASIN @ STA. 8+09.22, OFFSET 17.31 L AND 11+36.29, OFFSET 48'. BACKFILL AND PLACE NEW PAVEMENT IN REMOVAL AREAS.
  4. MAINTAIN EXISTING GRADES.
  5. ADJUST ALL WATER VALVES IN PROJECT AREA.

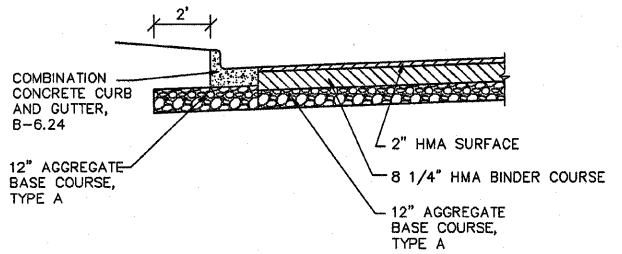

**1**  
**7**

**TYPICAL SECTION HMA PAVING**  
FULL DEPTH LOCATIONS  
NOT TO SCALE

EXCEPT FOR THE TOP 75 MM (3"), ALL AGGREGATE BASES AND SUBBASES 300 MM (12") IN THICKNESS SHALL BE CONSTRUCTED OF AGGREGATE GRADATION CA-2. IF THE SPECIFIED THICKNESS EXCEEDS 300 MM (12"), THE BASES OR SUBBASES SHALL BE CONSTRUCTED OF TOPSIZE 150 MM (6") BREAKER-RUN CRUSHED STONE WITH 70% TO 90% BY WEIGHT, PASSING THE 4" SIEVE AND 15% TO 40% BY WEIGHT, PASSING THE 50 MM (2") SIZE SIEVE, EXCEPT FOR THE TOP 75 MM (3"). THE BREAKER-RUN CRUSHED STONE SHALL BE REASONABLY UNIFORMLY GRADED FROM COARSE TO FINE AND BE TAKEN FROM A QUARRY LEDGE CAPABLE OF PRODUCING CLASS "D" QUALITY AGGREGATE. THE TOP 75 MM (3") SHALL BE GRADATION CA-6 OR CA-10 REGARDLESS OF THICKNESS. THE WATER NECESSARY TO ACHIEVE COMPACTION IN ALL BUT THE TOP 75 MM (3") LAYER MAY BE ADDED AFTER THE SUBBASE OR BASE COURSE IS PLACED ON THE GRADE.

PREVIOUSLY PUGMILLED STOCKPILES OF "TYPE A" OLDER THAN 1 MONTH WILL NOT BE APPROVED FOR USE UNTIL A MOISTURE CHECK IS RUN TO VERIFY MOISTURE CONTENT. MATERIAL SHIPPED TO PROJECTS WITHOUT BEING TESTED WILL NOT BE ACCEPTED.

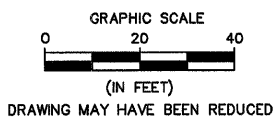

**PLAN VIEW**



 HOT MIX ASPHALT PAVING

Rev:	Issued For:	Issued Date:	Rev By:
	DOT SUBMITTAL	02-26-08	JEN
	DOT SUBMITTAL	02-05-08	JEN
	DOT SUBMITTAL	11-19-08	JEN
	DOT SUBMITTAL	08-28-08	JEN
	DOT SUBMITTAL	07-10-08	JEN
	DOT SUBMITTAL	03-19-08	JEN

Project Description:  
CITY OF EAST DUBUQUE, IL  
WALL STREET/6TH STREET AND  
WALL STREET/US 20 RAMP  
INTERSECTIONS

Sheet Title:  
WALL STREET/6TH STREET

**IW ENGINEERS & SURVEYORS, P.C.**  
ENGINEERING, SURVEYING, CONSULTING  
415 FRENCHMAN AVE. DUBUQUE, IA 52002  
PHONE: (562) 244-1111 FAX: (562) 244-1111  
www.iw-engineers.com



Project Mgr: MCJ  
Project Number:  
07193-02

**7of11**

P:\07183183-02\Drawings\Civil\183-02\_off ramp & wall.dwg, 8/11, 2/25/2009 2:44:29 PM

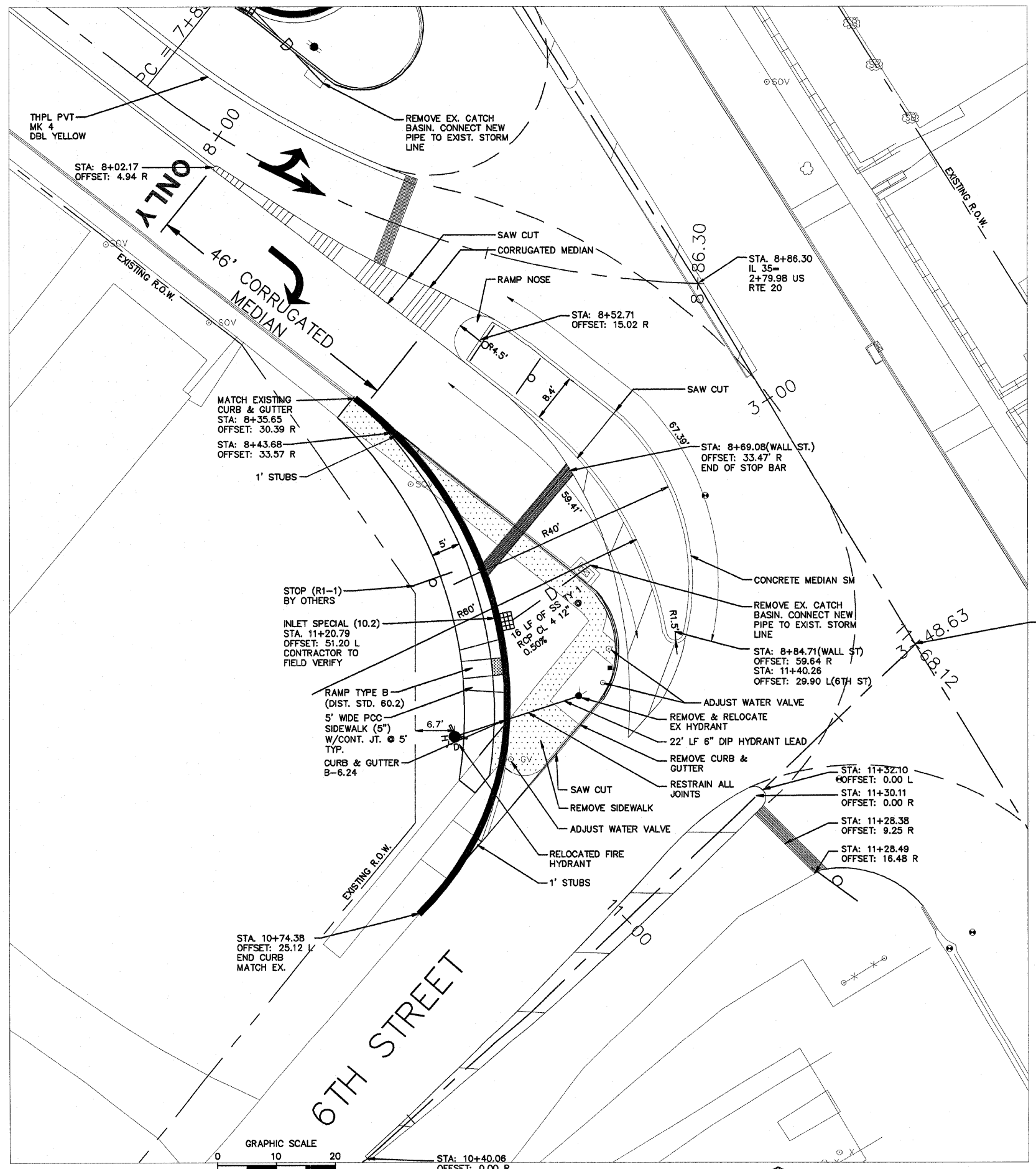

Rev:	Issued For:	Issued Date:	Rev By:	LEN
	DOT SUBMITTAL	02-26-09		LEN
	DOT SUBMITTAL	02-05-09		LEN
	DOT SUBMITTAL	11-13-08		LEN
	DOT SUBMITTAL	08-25-08		LEN
	DOT SUBMITTAL	07-10-08		LEN
	DOT SUBMITTAL	09-19-08		LEN

Sheet Title:  
**INTERSECTION PLAN  
 WALL STREET/6TH STREET**

Project Description:  
**CITY OF EAST DUBUQUE, IL  
 WALL STREET/6TH STREET AND  
 WALL STREET/US 20 RAMP  
 INTERSECTIONS**

**IIV ENGINEERS &  
 SURVEYORS, P.C.**  
 PROFESSIONAL ENGINEERS, ARCHITECTS  
 418 HUNTERMAN AVE. FARMER IN  
 VINCENNES, INDIANA 47591  
 WWW.IIVENGINEERS.COM



Project Mgr: MCJ  
 Project Number:  
 07183-02



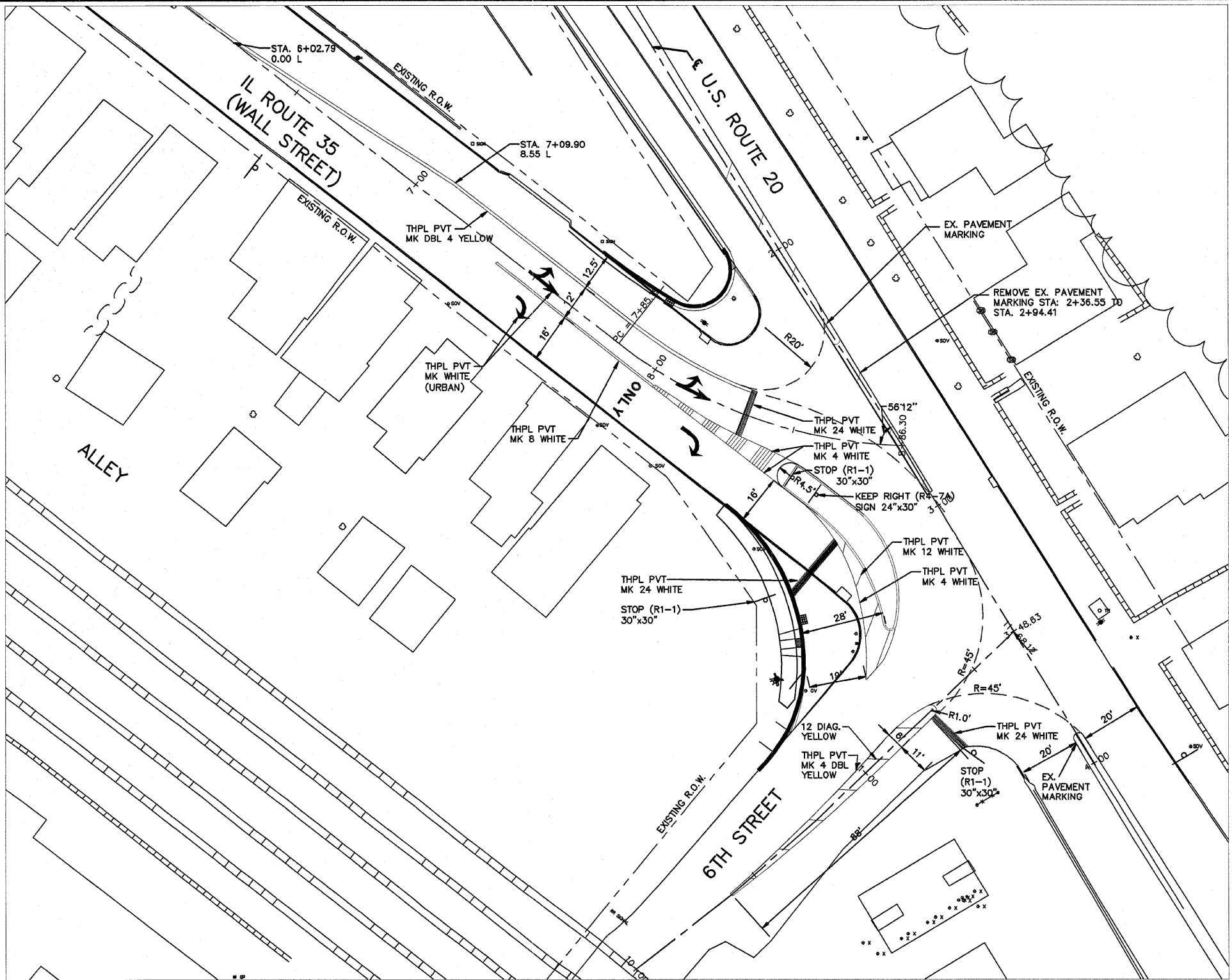

GENERAL NOTES  
 ALL PAVEMENT MARKINGS SHALL CONFORM TO MUTCD

P:\071831183-02\Drawings\Civil\07183-02\_off ramp & wall.dwg, 9/11, 2/25/2009 2:44:15 PM

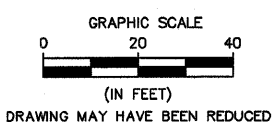

PLAN VIEW



Rev	Issued For	Issued Date	Rev By
	DOT SUBMITTAL	02-26-09	JEN
	DOT SUBMITTAL	02-05-09	JEN
	DOT SUBMITTAL	11-19-08	JEN
	DOT SUBMITTAL	08-25-08	JEN
	DOT SUBMITTAL	07-10-08	JEN
	DOT SUBMITTAL	03-19-08	JEN

Sheet Title:  
 STRIPING AND SIGNAGE  
 WALL STREET/6TH STREET

Project Description:  
 CITY OF EAST DUBUQUE, IL  
 WALL STREET/6TH STREET AND  
 WALL STREET/US 20 RAMP  
 INTERSECTIONS

**IIV ENGINEERS & SURVEYORS, P.C.**  
 PROFESSIONAL ENGINEERS, SURVEYORS, GEOTECHNICAL ENGINEERS  
 415 FRANKLIN AVENUE, FRANKLIN, IL 62424  
 (618) 451-1111 FAX (618) 451-1111  
 www.iiv-engineers.com



Project Mgr: MCI  
 Project Number:  
 07183-02

9 of 11

P:\07193193-02\Drawings\CH\07193-02\_off ramp & wall.dwg, 10/11, 3/8/2009 2:10:14 PM

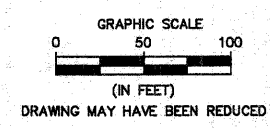
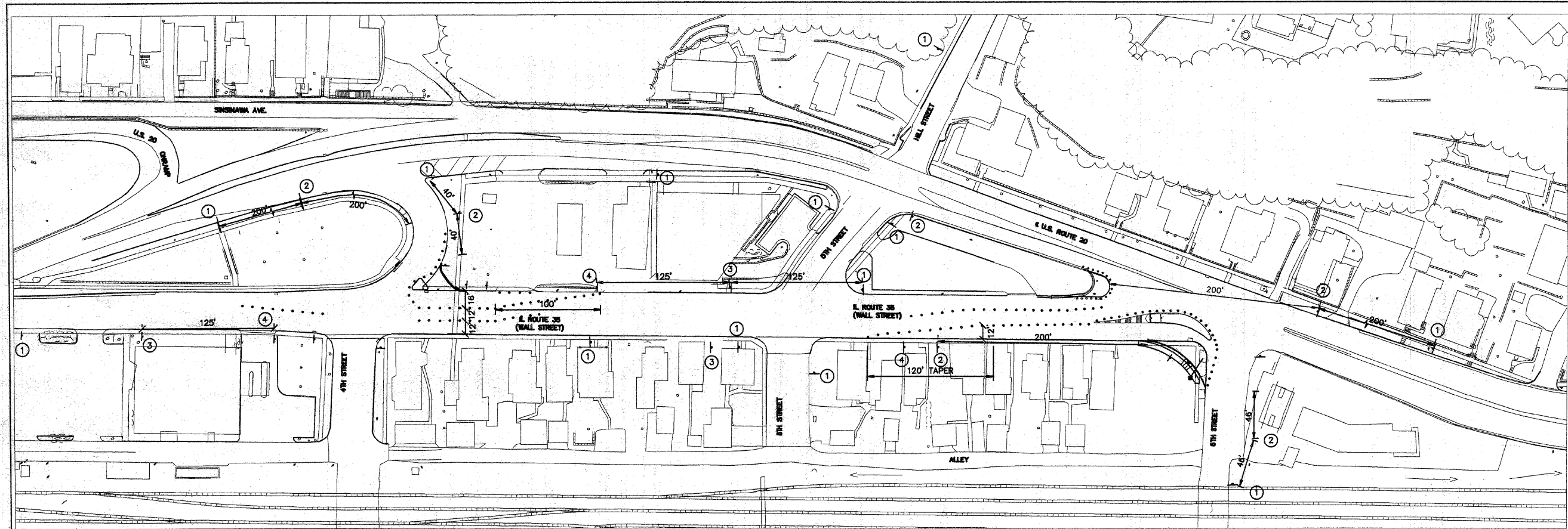

PLAN VIEW

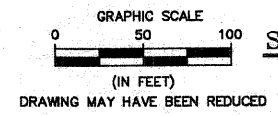
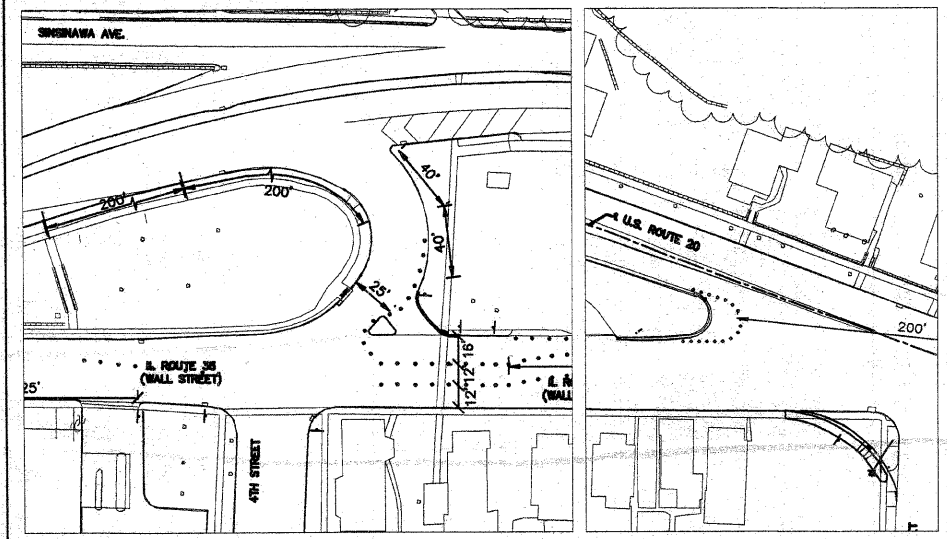

STAGE I

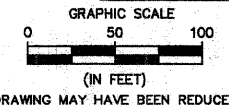
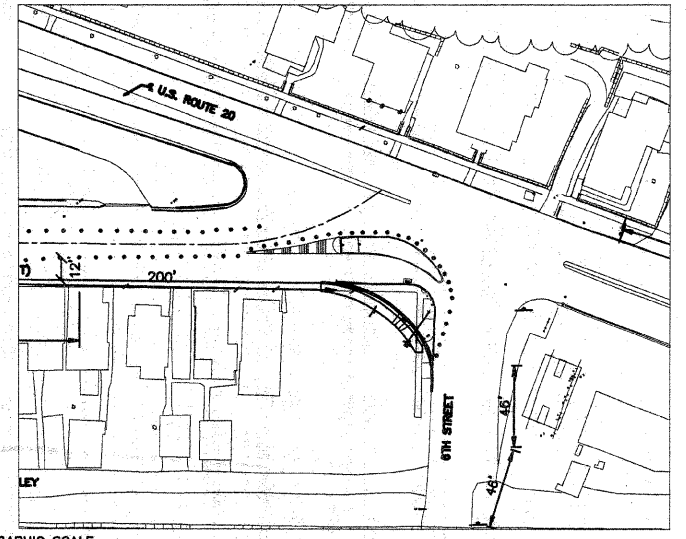

STAGE II



SYMBOLS AND NOTES			
①		③	
	W20-1(0)-48	④	
	OR		
②			DRUM OR BARRICADE WITH MONODIRECTIONAL STEADY BURNING LIGHT
			WORK AREA
			NOTES: 1. DRUMS OR BARRICADES AT 25' CENTERS.

SEE ILLINOIS D.O.T. STANDARDS - 701301, 701331, 701501, 701502, 701801, 701901  
NOTE: SAWCUT ALL CONCRETE REMOVAL AREAS.

Rev:	Issued For:	Issued Date:	Rev By:	LEN
	DOT SUBMITTAL			02-28-08
	DOT SUBMITTAL			02-05-09
	DOT SUBMITTAL			11-13-08
	DOT SUBMITTAL			08-25-08
	DOT SUBMITTAL			07-10-08
	DOT SUBMITTAL			08-19-08

Sheet Title:  
TRAFFIC CONTROL

Project Description:  
CITY OF EAST DUBUQUE, IL  
WALL STREET/6TH STREET AND  
WALL STREET/US 20 RAMP  
INTERSECTIONS

IIV ENGINEERS & SURVEYORS, P.C.  
INCORPORATED  
1000 N. UNIVERSITY AVENUE  
DUBUQUE, ILLINOIS 62002  
PHONE: (314) 241-1111 FAX: (314) 241-1112  
www.iiv-engineers.com



Project Mgr: MCI  
Project Number:  
07193-02

### INLET SPECIAL

CONTRACT NO.			
F.A. RTE.	SECTION	COUNTY	TOTAL SHEET NO.
STA.	TO STA.		
FED. ROAD DIST. NO.	ILLINOIS FED. AID PROJECT		

**SEC. A-A**

**SEC. B-B**

\* THE WALL ADJUSTMENTS SHALL BE MADE WITH CONCRETE BUILDING BRICK OR CLASS 51 CONCRETE.

THE HEIGHT OF THE BOX MAY BE CONSTRUCTED 150 (6) SHORT TO ALLOW FOR FIELD ADJUSTMENTS.

**DETAIL OF FRAME & GRATE**

**NOTES**

SEE STANDARD 602701 FOR DETAILS OF STEPS.

EXCEPT AS NOTED HEREON INLET SPECIAL SHALL BE CONSTRUCTED IN ACCORDANCE WITH SECTION 602 OF THE STANDARD SPECIFICATIONS.

THE SIDE WALLS MAY BE BUILT AS PRECAST SEGMENTED SECTIONS.

ALL VOIDS AROUND PIPE ENTRANCE, BOTH INSIDE AND OUTSIDE, SHALL BE SEALED WITH MORTAR.

WEIGHT OF CAST IRON FRAME & GRATE = 240 kg (530 lbs.) ± .

STEPS SHALL BE OMITTED WHEN DEPTH OF "H" IS LESS THAN 1.5 m (5 ft).

**NOTES**

CLASS 51 CONCRETE OR PRECAST CONCRETE SHALL BE USED THROUGHOUT. PRECAST CONCRETE SHALL BE IN ACCORDANCE WITH SECTION 504.01 THRU 504.05 OF THE STANDARD SPECIFICATIONS EXCEPT THAT CONCRETE STRENGTH SHALL BE 27.5 MPa (4,000 psi) AFTER 28 DAYS.

THE CONTRACT UNIT PRICE EACH FOR INLET SPECIAL SHALL INCLUDE THE COST OF CONSTRUCTING THE INLET BOX, FURNISHING AND INSTALLING THE FRAME AND GRATE, THE CAST IRON STEPS (IF USED), THE PRECAST FLOOR SLABS, SAND CUSHION (WHEN USED) AND REINFORCEMENT BARS.

**PLAN OF GRATE \***

**PLAN OF FRAME**

**PLAN OF GRATE**

**SECTION B-B**

**SECTION A-A**

\* THIS GRATE TO BE USED WITHOUT CURB BOX WHEN INLET IS IN DRIVEWAY.

ALL DIMENSIONS ARE IN MILLIMETERS (INCHES) UNLESS OTHERWISE NOTED.

**INLET SPECIAL 10.2**

### DISABLED RAMP DETAIL

CONTRACT NO.			
F.A. RTE.	SECTION	COUNTY	TOTAL SHEET NO.
STA.	TO STA.		
FED. ROAD DIST. NO.	ILLINOIS FED. AID PROJECT		

**SECTION A-A**

SEE STANDARD 424001 FOR SIDE FLARE DETAIL & SEE PLANS FOR RAMP TYPE.

ALL DIMENSIONS ARE IN MILLIMETERS (INCHES) UNLESS OTHERWISE NOTED.

**SECTION B-B**

**NOTES :** THIS DETAIL TO BE USED IN CONJUNCTION WITH STATE STANDARD 424001.

THE MAXIMUM ALLOWABLE CROSS SLOPE FOR SIDEWALK IS 2% (1/4"/FT).

THE MAXIMUM ALLOWABLE SIDEWALK GRADE IS 8% (1/2"/FT). IF SPACE LIMITATIONS PROHIBIT THE USE OF THE 1:12 SLOPE, THEN SLOPES BETWEEN 1:10 AND 1:12 ARE PERMITTED FOR A MAXIMUM RISE OF 150 (6). SLOPES 1:8 AND 1:10 ARE ALLOWED FOR A MAXIMUM RISE OF 75 (3). SLOPES STEEPER THAN 1:8 ARE NOT PERMITTED.

THE DEPRESSED CURB IS NOT STANDARD. THE RISE IS 130 (5) INSTEAD OF 40 (1 1/2).

**DISABLED RAMP DETAIL 60.2**

Rev. By:	Issued Date:	LEN	LEN	LEN
	02-05-08			
	11-13-08			
	08-25-08			
	07-10-08			
	03-19-08			
Rev. Issued For:				
DOT SUBMITTAL				
DOT SUBMITTAL				
DOT SUBMITTAL				
DOT SUBMITTAL				
DOT SUBMITTAL				
Sheet Title:	DISTRICT STANDARD PLANS			
Project Description:	CITY OF EAST DUBUQUE, IL WALL STREET/6TH STREET AND WALL STREET/US 20 RAMP INTERSECTIONS			
Prepared By:	IIV ENGINEERS & SURVEYORS, P.C.			
Checked By:	INTEGRITY, EXPERISE, SOLUTIONS.			
Drawn By:	HAZEL GREEN, WI			
Scale:	DUBUQUE, IA			
Project No.:	4155 PENNSYLVANIA AVE. DUBUQUE, IA 52002			
Project Name:	VOICE (563) 556-2464 FAX (563) 556-7811			
Project Mgr:	www.iiveng.com			
Project Number:	07193-02			
<b>11 of 11</b>				