

RTE. NO.	SECTION	COUNTY	TOTAL SHEETS	SHEET NO.
CH 20	06-00275-00-PV	LOGSALLE	218	117
STA. N/A		TO STA. N/A		
FED. ROAD DIST. NO. 3		ILLINOIS	FED. AID PROJECT	

CONTRACT NO. 87352

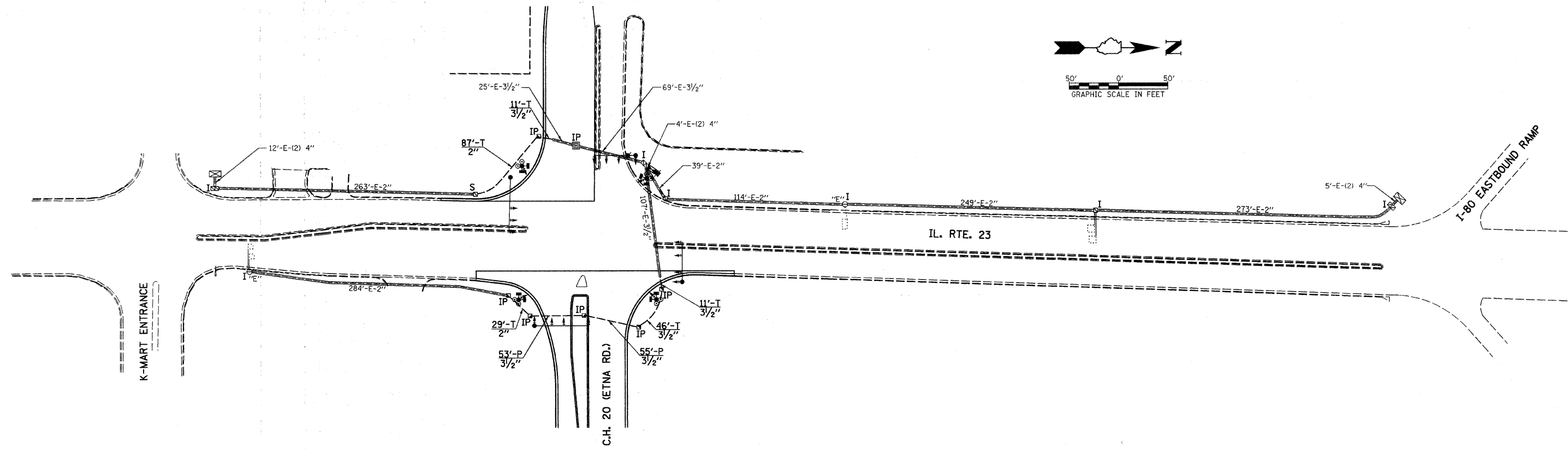

INTERCONNECT PLAN LEGEND

	PROPOSED	EXISTING
CONTROLLER	☒	☒
HANDHOLE	⊠	⊠
DOUBLE HANDHOLE	⊞	⊞
HEAVY-DUTY HANDHOLE	⊠	⊠
G.S. CONDUIT IN TRENCH (T) OR PUSHED (P)	---	---
DETECTOR LOOP	□	□
UNIT DUCT	UD	
SYSTEM	SP	S
INTERSECTION	IP	I
TELEPHONE	⊠	⊠
CAST IRON JUNCTION BOX	⊙	⊙

SUMMARY OF INTERCONNECT QUANTITIES - IL. RTE. 23 & C.H. 20 (ETNA RD.)

PAY ITEM	UNIT	ITEM	QUANTITY
81012600	FOOT	CONDUIT IN TRENCH, 2" DIA., PVC	87
81500200	FOOT	TRENCH AND BACKFILL FOR ELECTRICAL WORK	87
86400100	EACH	TRANSCEIVER - FIBER OPTIC	1
87100140	FOOT	FIBER OPTIC CABLE IN CONDUIT, NO. 62.5/125 12F	588
87900200	EACH	DRILL EXISTING HANDHOLE	1
89502300	FOOT	REMOVE ELECTRIC CABLE FROM CONDUIT	1068
X8730027	FOOT	ELECTRIC CABLE IN CONDUIT, TRACER, NO. 14 1C	588
XX002856	EACH	RE-OPTIMIZE TRAFFIC SIGNAL SYSTEM	1

THE TRAFFIC SIGNAL CONTROL EQUIPMENT ON THIS PROJECT IS "EAGLE" TO MATCH THE EXISTING ADJACENT SYSTEM.

RESTORATION OF WORK AREA

RESTORATION OF THE TRAFFIC SIGNAL WORK AREA SHALL BE INCIDENTAL TO THE RELATED PAY ITEM SUCH AS FOUNDATION, CONDUIT, HANDHOLE, TRENCH AND BACKFILL, ETC., AND NO EXTRA COMPENSATION SHALL BE ALLOWED.

ALL ROADWAY SURFACES SUCH AS SHOULDERS, MEDIANS, SIDEWALKS, PAVEMENT, ETC. SHALL BE REPLACED IN KIND.

ALL DAMAGE TO MOWED LAWNS SHALL BE REPLACED WITH AN APPROVED SOD, AND ALL DAMAGE TO UNMOWED FIELDS SHALL BE SEEDED IN ACCORDANCE WITH THE STANDARD SPECIFICATIONS 252 AND 250 RESPECTIVELY.