

LEGEND

- PROPOSED RIGHT OF WAY LINE
- EXISTING RIGHT OF WAY LINE
- PROPOSED TEMPORARY EASEMENT LINE
- PROPERTY LINE
- EXISTING CENTERLINE



NORTHEAST QUARTER SECTION 16,
TOWNSHIP 9 NORTH, RANGE 4 WEST
OF THE 4TH PRINCIPAL MERIDIAN

APPROVED BY _____ DISTRICT ENGINEER
DATE _____

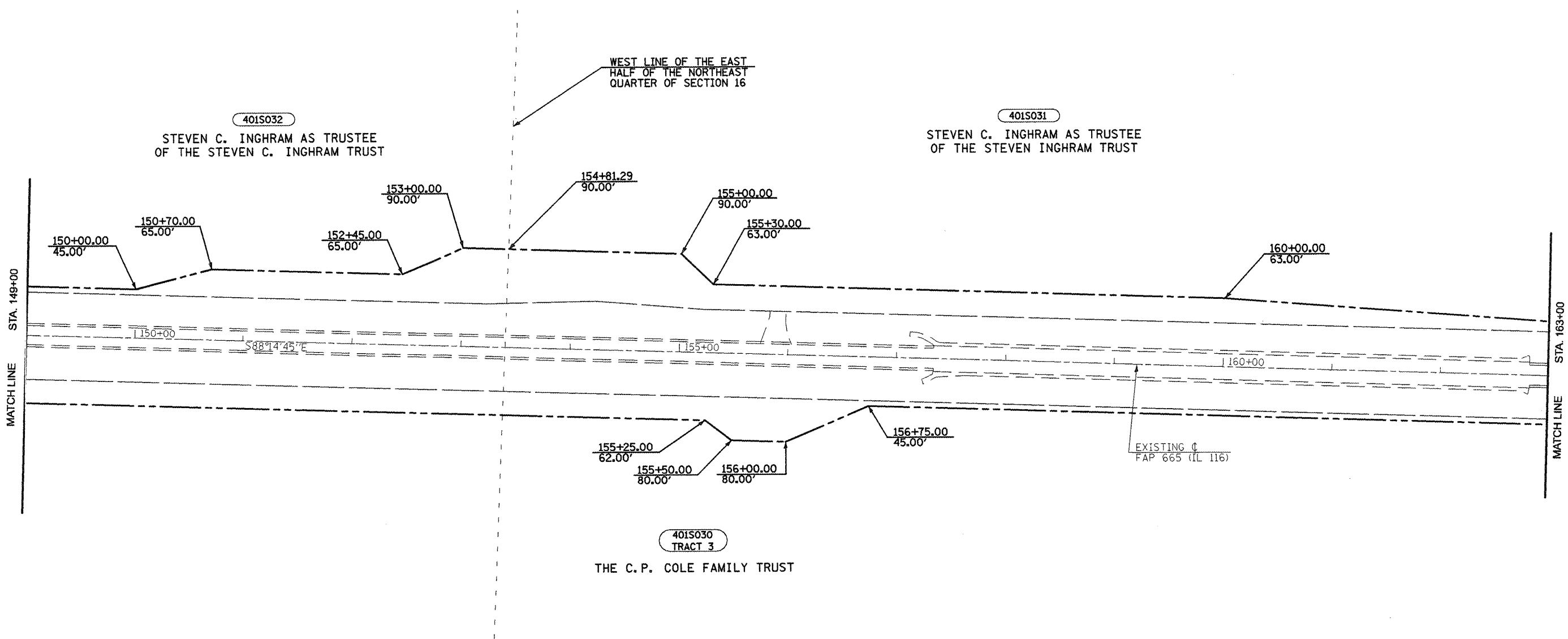

DRAWN BY _____
WRITTEN BY _____
CHECKED BY _____
INSPECTED BY _____

ALL SURVEY INFORMATION BASED ON THE
ILLINOIS STATE PLANE COORDINATE SYSTEM
NAD.83, ILLINOIS WEST ZONE, GEOID03
APPLICABLE GRID FACTOR = 0.999953199

JOB NO. R-94-001-01

RIGHT OF WAY PLANS
F.A.P. ROUTE 665(IL 116)

PROJECT _____ SECTION 136,137W&RS-3

STATION 149+00 _____ TO _____

STATION 163+00 _____

COUNTY HENDERSON

SCALE 1"=100' SHEET 65 OF 17