

WILLIAM & SHIRLEY GULLBERG TRUST

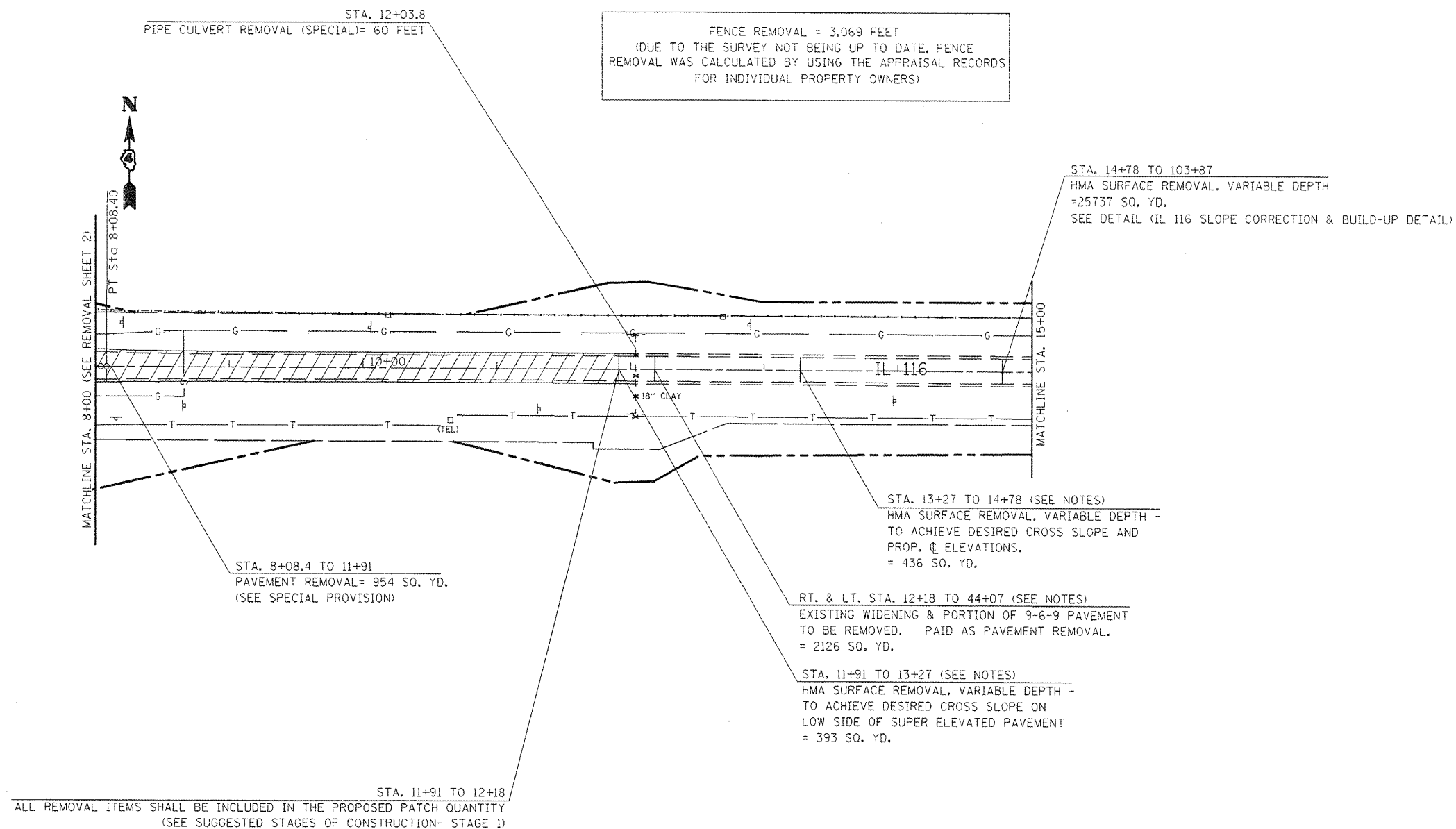

FENCE REMOVAL = 3,069 FEET
(DUE TO THE SURVEY NOT BEING UP TO DATE, FENCE
REMOVAL WAS CALCULATED BY USING THE APPRAISAL RECORDS
FOR INDIVIDUAL PROPERTY OWNERS)

LEGEND

	PAVEMENT REMOVAL
	PAVEMENT BREAKING
	HMA SURFACE REMOVAL-BUTT JOINT

PLAN NOTES

- REMOVAL OF SAPPLINGS, BUSHES AND ROOTS SHALL BE REMOVED AND DISPOSED OF AS REQUIRED BY ARTICLE 201
- SEE TREE REMOVAL TABLE FOR STATIONING AND QUANTITY
- REFER TO THE GENERAL NOTE AND/OR THE UNDERDRAIN, SPECIAL DETAIL IF ANY PIPE UNDERDRAINS OR FIELD TILE ARE ENCOUNTERED DURING CONSTRUCTION
- DUE TO THE POOR CONDITION OF THE EXISTING E.O.P ALONG BOTH SIDES OF IL ROUTE 116, QUANTITIES WERE INCLUDED FOR THE CONTRACTOR TO SAW CUT AND REMOVE PAVEMENT AT THE LOCATIONS AND WIDTHS SPECIFIED IN THE EXISTING TYPICALS. THIS WORK SHALL BE PAID FOR AS EITHER PAVEMENT REMOVAL AND/OR PAVEMENT REMOVAL, SPECIAL.

MIN. DEPTH	UTILITY	COMPANY
4'-0"	PETROLEUM	BUCKEYE PARTNERS, L.F.
4'-0"	OIL	BP AMOCO
2'-6"	TELEPHONE	FRONTIER COMMUNICATIONS
2'-0"	CABLE T.V.	MEDIACOM COMMUNICATIONS
3'-0"	ELECTRIC	AMEREN IP
2'-6"	NATURAL GAS	NICOR
4'-0"	WATER	DALLAS RURAL WATER DIST.