

RT STA. 20+00 (IL 116)
 PROP. CONC. GUTTER OUTLET
 PAID AS CLASS SI CONC. (OUTLET) = 5.8 CU. YD.

LT. STA. 307+65.00 (IL 94) TO
 RT. STA. 20+00.00 (IL 116)
 PROP. CCC & G M-6.24
 LENGTH = 160.3 FT
 INCLUDES 6 FT. TRANSITION

A. SMALL ISLAND
 PROP. ISLAND PAVEMENT 6" = 13.2 SQ YD
 SUB-BASE GRAN. MAT'L, TYP B, 4" = 26.1 SQ. YD.
 PROP. CCC & G TYPE M-4.24 = 32.7 FT
 PROP. CCC & G TYPE M-4.06 = 14.9 FT
 *EXTENDED PAN AREA SHALL BE INCLUDED
 IN THE COST OF THE CCC & G TYPE M-4.24

B. INTERMEDIATE ISLAND
 PROP. ISLAND PAVEMENT 6" = 87.3 SQ YD
 SUB-BASE GRAN. MAT'L, TYP B, 4" = 121.0 SQ YD.
 PROP. CCC & G TYPE M-4.24 = 81.6 FT
 PROP. CCC & G TYPE M-4.06 = 49.9 FT
 *EXTENDED PAN AREA SHALL BE INCLUDED
 IN THE COST OF THE CCC & G TYPE M-4.24

RT STA. 297+01.00
 PROP. CONC. GUTTER OUTLET
 PAID AS CLASS SI CONC. (OUTLET) = 6.7 CU. YD.

STA. 298+50.00
 MATCHLINE STATION
 SEE PLANS COMPLETED BY TWM, INC.

RT. STA. 296+70.00
 PROP. PIPE CULV. CL D, TYP 1 24"
 LENGTH = 121.4 FT.
 USFL = 610.67
 DSFL = 605.11
 PROP. END SECTION = 2 EACH

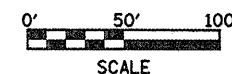
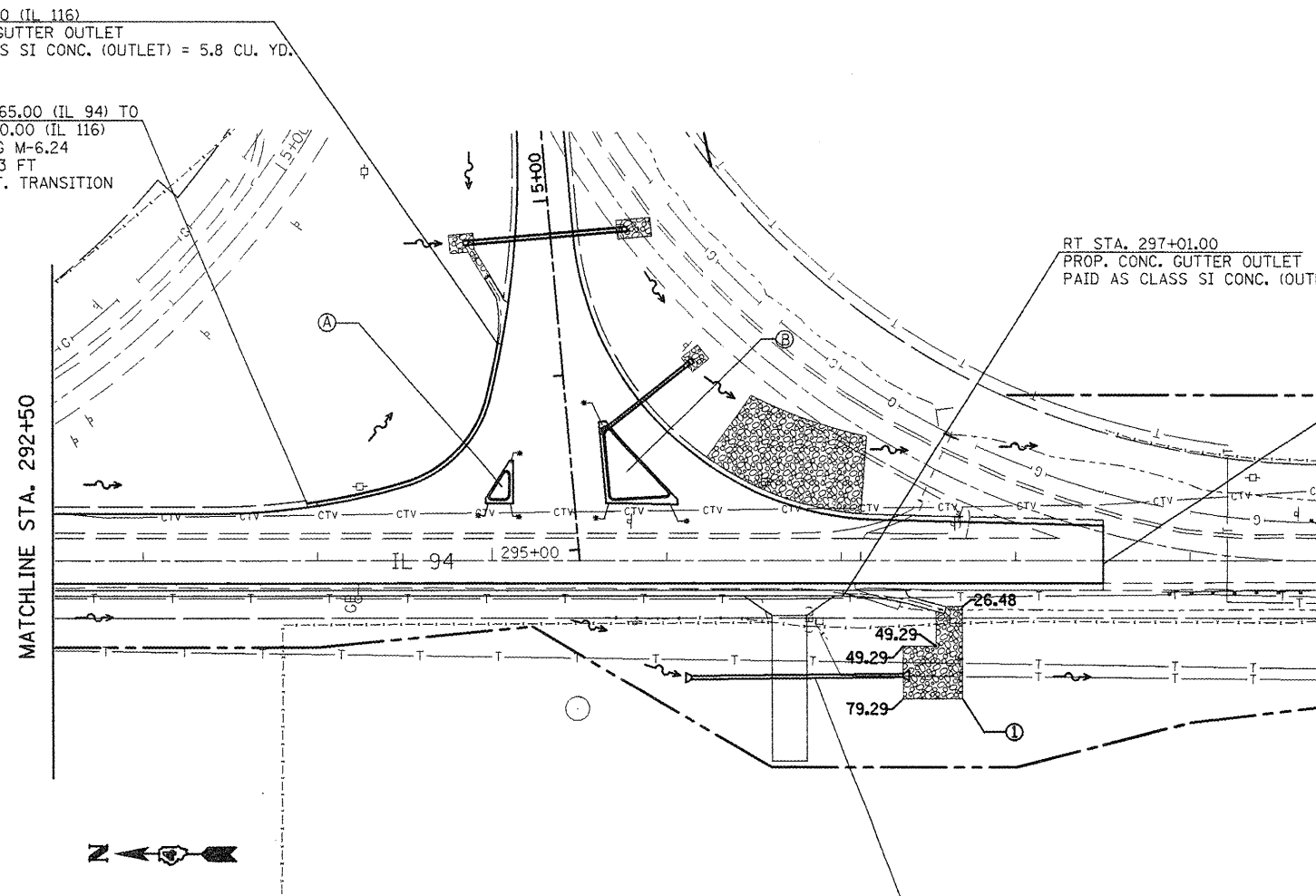

| | |
|---|------------------------------|
| | STONE RIPRAP |
| ① | CLASS B3 |
| ② | CLASS A5 |
| ③ | CLASS B5 |
| | FABRIC FORMED CONC. REV. MAT |

| | | | |
|--------------------------------|------------------------------|------------|-----------|
| FILE NAME = draindetail.dgn | USER NAME = ghdreem | DESIGNED - | REVISED - |
| | | DRAWN - | REVISED - |
| | PLOT SCALE = 100.0000' / IN. | CHECKED - | REVISED - |
| | PLOT DATE = 2/27/2009 | DATE - | REVISED - |

**STATE OF ILLINOIS
 DEPARTMENT OF TRANSPORTATION**

| | | | | |
|----------------------------------|-----------|-----------|------|---------|
| PROPOSED DRAINAGE - IL 94 | | | | |
| SCALE: | SHEET NO. | OF SHEETS | STA. | TO STA. |

| | | | | |
|---|-----------------------------|-----------|--------------------|-----------|
| F.A.P. RTE. | SECTION | COUNTY | TOTAL SHEETS | SHEET NO. |
| 665 | (136.137)W&RS-3d136R109BR-1 | HENDERSON | | 108 |
| FED. ROAD DIST. NO. ILLINOIS FED. AID PROJECT | | | CONTRACT NO. 88773 | |