

ROUTE NO.	SECTION	COUNTY	TOTAL SHEETS	SHEET NO.
FAS 495	95-00215-01-RS	PIATT	21	14
FED. ROAD DIST. NO. 7		ILLINOIS PROJECT	CONTRACT NO. 91383	

CURVE CURCH21
 PI STA. 267+06.19
 $\Delta = 13^\circ 12' 00''$ (LT)
 $D = 1^\circ 30' 00''$
 $T = 441.96'$
 $R = 3,819.72'$
 $L = 880.00'$
 $E = 25.48'$
 PC STA. 262+64.23
 PT STA. 271+44.23

CURVE CURCH22
 PI STA. 157+84.24
 $\Delta = 0^\circ 27' 17''$ (RT)
 $D = 0^\circ 02' 42''$
 $T = 506.27'$
 $R = 127,551.64'$
 $L = 1,012.54'$
 $E = 1.00'$
 PC STA. 152+77.97
 PT STA. 162+90.51

CURVE CURCH23
 PI STA. 180+40.70
 $\Delta = 0^\circ 24' 32''$ (LT)
 $D = 0^\circ 02' 38''$
 $T = 464.56'$
 $R = 130,228.04'$
 $L = 929.11'$
 $E = 0.83'$
 PC STA. 175+76.14
 PT STA. 185+05.25

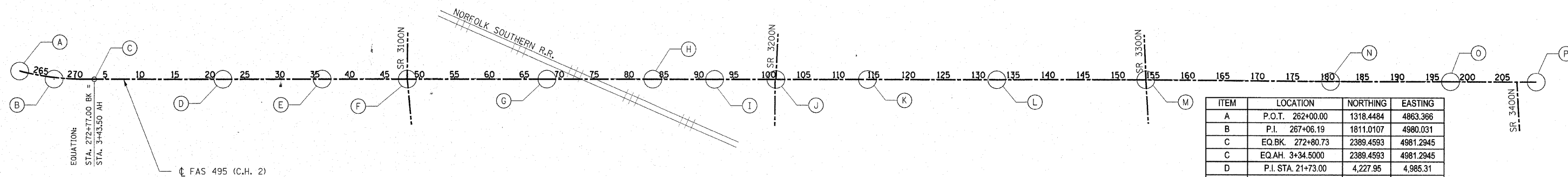
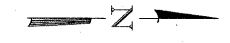

ITEM	LOCATION	NORTHING	EASTING
A	P.O.T. 262+00.00	1318.4484	4863.366
B	P.I. 267+06.19	1811.0107	4980.031
C	EQ.BK. 272+80.73	2389.4593	4981.2945
C	EQ.AH. 3+34.5000	2389.4593	4981.2945
D	P.I. STA. 21+73.00	4,227.95	4,985.31
E	P.I. STA. 35+92.86	5,647.81	4,982.77
F	P.I. STA. 48+12.36	6,867.31	4,980.87
G	P.I. STA. 68+10.36	8,865.31	4,982.48
H	P.I. STA. 83+27.34	10,382.29	4,982.13
I	P.I. STA. 92+11.36	11,266.31	4,982.79
J	P.I. STA. 100+89.36	12,144.31	4,982.95
K	P.I. STA. 113+99.35	13,454.30	4,981.30
L	P.I. STA. 132+50.35	15,305.30	4,982.55
M	P.I. STA. 153+84.39	17,439.34	4,980.35
N	P.I. STA. 180+27.97	20,082.86	4,998.61
O	P.I. STA. 197+44.85	21,799.74	4,998.22
P	P.I. STA. 209+71.71	23,026.60	4,999.71

HORIZONTAL ALIGNMENT
 FAS 495 C.H. 2

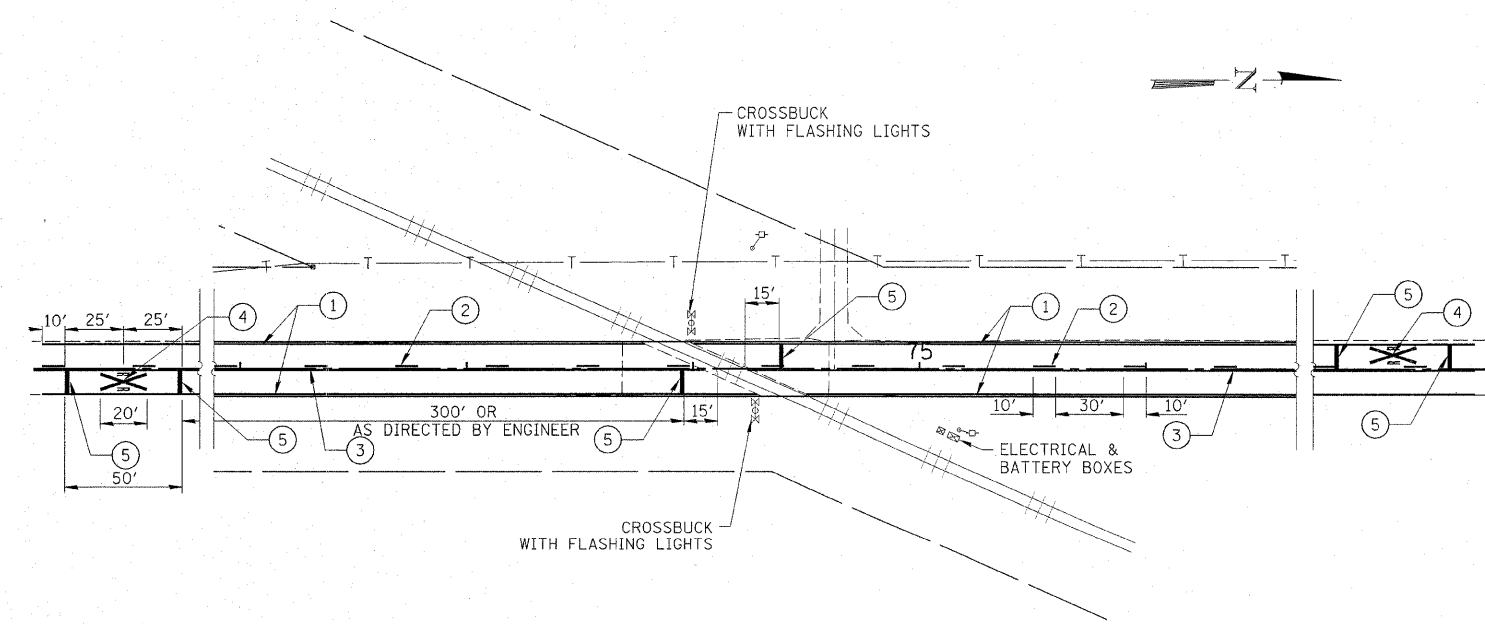

- LEGEND**
- ① 4" WHITE LINE
 - ② 4" SKIP DASH YELLOW LINE
 - ③ 4" YELLOW LINE
 - ④ LETTERS AND SYMBOLS
 - ⑤ 24" WHITE LINE
- PAVEMENT MARKING**

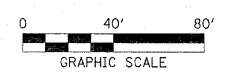

HAMPTON, LENZINI & RENWICK, INC.
 CIVIL & STRUCTURAL ENGINEERS

3085 STEVENSON DRIVE, SUITE 201
 SPRINGFIELD, ILLINOIS 62703
 (217) 548-3400

ELGIN • SPRINGFIELD

PROJECT NUMBER: 03-75-0007-1 DATE: 02/11/08
 DESIGNED: L.F.S. CHECKED: S.W.M. DRAWN: TWK

HORIZONTAL ALIGNMENT
PAVEMENT MARKING
 SECTION 95-00215-01-RS
 FAS 495 C.H. 2
 PIATT COUNTY