

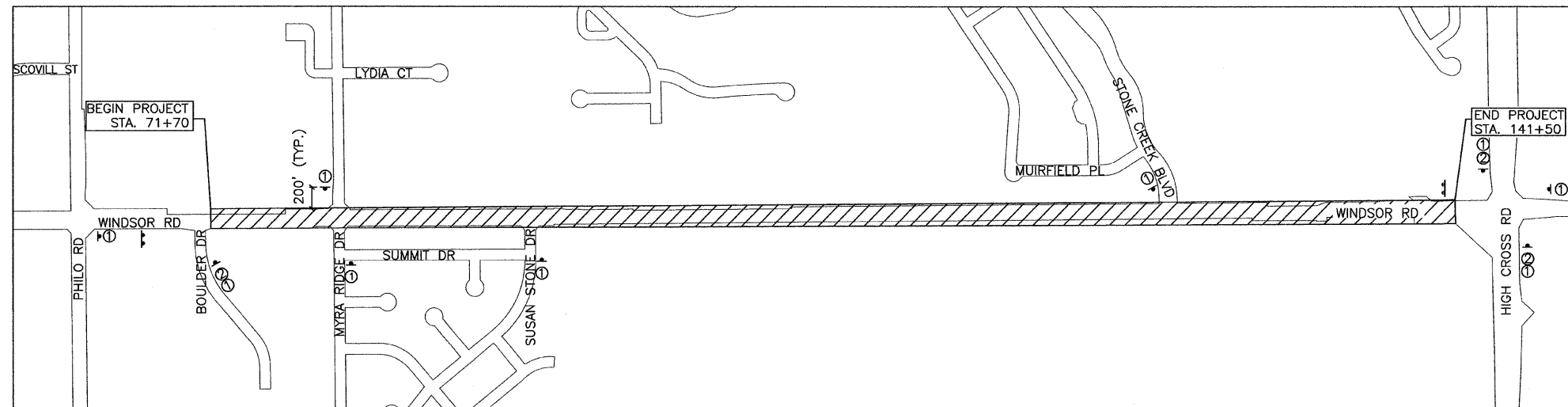

CITY OF URBANA
PUBLIC WORKS
ENGINEERING DIVISION

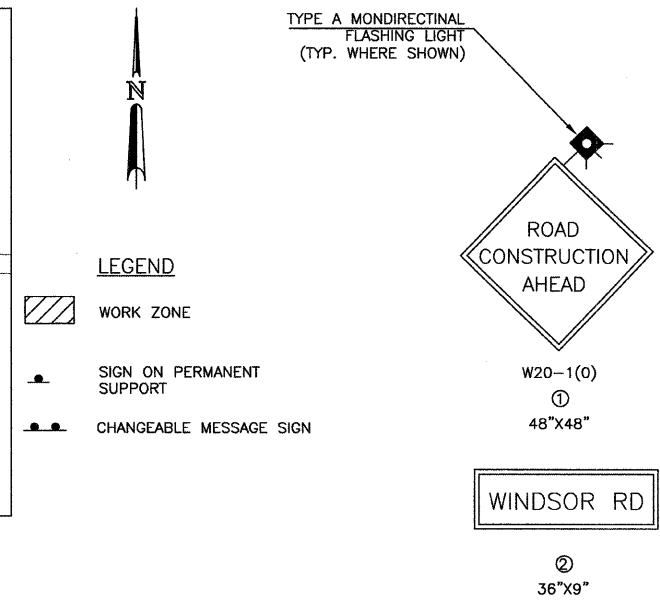

PROJECT OVERVIEW MAP
NOT TO SCALE



TRAFFIC CONTROL GENERAL NOTES

1. TRAFFIC CONTROL AND PROTECTION AS DETAILED HEREIN WILL BE PAID AT THE CONTRACT LUMP SUM PRICE FOR "TRAFFIC CONTROL COMPLETE".
2. TRAFFIC CONTROL SHALL BE IN ACCORDANCE WITH THE APPLICABLE ARTICLES OF THE STANDARD SPECIFICATIONS, THE APPLICABLE GUIDELINES CONTAINED IN THE "MANUAL ON UNIFORM TRAFFIC CONTROL DEVICES FOR STREETS AND HIGHWAYS", THE SPECIAL PROVISIONS, THESE PLANS AND HIGHWAY STANDARDS 701006, 701311, 701501, 701606, 701701, 701801, AND 701901.
3. CHANGEABLE MESSAGE SIGNS SHALL BE INSTALLED AND OPERATIONAL FIVE DAYS PRIOR TO THE START OF ROAD CLOSURE TO ALERT THE PUBLIC OF THE UPCOMING START OF CONSTRUCTION. THE CONTRACTOR SHALL INSPECT THE MESSAGE SIGNS BY 8:00 A.M. EACH DAY TO ENSURE THAT THE SIGNS ARE FULLY OPERATIONAL AND IN PROPER WORKING ORDER. THE SIGNS SHALL BE REMOVED AT THE START OF CONSTRUCTION. PAYMENT FOR CHANGEABLE MESSAGE SIGNS AND DAILY INSPECTION OF THE SIGNS SHALL BE INCLUDED IN THE COST OF "TRAFFIC CONTROL COMPLETE" WITH NO ADDITIONAL COMPENSATION ALLOWED.
4. CHANGEABLE MESSAGE SIGNS SHALL BE INSTALLED AND OPERATIONAL ON WINDSOR ROAD AT LEAST THREE DAYS PRIOR TO THE TURN ON OF TRAFFIC SIGNALS, AT THE MYRA RIDGE DRIVE AND WINDSOR ROAD INTERSECTION. THE CONTRACTOR SHALL INSPECT THE MESSAGE SIGNS BY 8:00A.M. EACH DAY TO ENSURE THAT THE SIGNS ARE FULLY OPERATIONAL AND IN PROPER WORKING ORDER. THE SIGNS SHALL BE REMOVED UPON ACTIVATION OF THE TRAFFIC SIGNALS. PAYMENT FOR CHANGEABLE MESSAGE SIGNS AND DAILY INSPECTION OF THE SIGNS SHALL BE INCLUDED IN THE COST OF "TRAFFIC CONTROL COMPLETE" WITH NO ADDITIONAL COMPENSATION ALLOWED.
5. THE CONTRACTOR SHALL MAINTAIN ACCESS TO ANY COMMERCIAL AND PRIVATE ENTRANCES WITHIN THE PROJECT LIMITS. ACCESS SHALL BE MAINTAINED BY CONSTRUCTING ENTRANCES IN HALF WIDTHS OR OTHER MEANS APPROVED BY THE ENGINEER. A QUANTITY OF "AGGREGATE FOR TEMPORARY ACCESS" HAS BEEN INCLUDED IN THE CONTRACT FOR ENTRANCE ACCESS.
6. TRAFFIC CONTROL DEVICES SHALL REMAIN IN PLACE UNTIL ALL SECTIONS OF THE ROADWAY ARE SUBSTANTIALLY COMPLETE. TRAFFIC CONTROL DEVICES SHALL BE REMOVED AS DIRECTED BY THE ENGINEER.
7. PROPER DRAINAGE SHALL BE MAINTAINED AT ALL TIMES WITHIN THE PROJECT LIMITS. THE CONTRACTOR SHALL BE RESPONSIBLE FOR COORDINATING THIS WORK AND ANY CONSTRUCTION TECHNIQUES NECESSARY TO ENSURE PROPER DRAINAGE IS MAINTAINED AT ALL TIMES. THE COST OF ALL LABOR, EQUIPMENT AND MATERIALS TO MAINTAIN PROPER DRAINAGE WILL NOT BE PAID FOR SEPARATELY BUT SHALL BE INCLUDED IN THE COST OF THE MISCELLANEOUS PAY ITEMS INVOLVED.
8. THE CONTRACTOR SHALL BE RESPONSIBLE FOR PROVIDING TRAFFIC CONTROL SURVEILLANCE FOR THIS PROJECT. THE CONTRACTOR SHALL INSPECT AND MAINTAIN ALL TRAFFIC CONTROL DEVICES AT ALL TIMES INCLUDING NIGHTTIME, WEEKENDS, WINTER SHUT-DOWN PERIOD AND ANY TIME WORKERS ARE NOT PRESENT. THIS WORK SHALL BE PERFORMED IN ACCORDANCE WITH THE SPECIAL PROVISIONS. THE COST OF ALL LABOR AND MATERIALS FOR THE SURVEILLANCE AND MAINTENANCE OF TRAFFIC CONTROL DEVICES SHALL BE INCLUDED IN THE COST OF "TRAFFIC CONTROL COMPLETE".
9. LONGITUDINAL DIMENSIONS MAY BE ADJUSTED SLIGHTLY TO FIT FIELD CONDITIONS.

TRAFFIC CONTROL STANDARDS

THE FOLLOWING TRAFFIC CONTROL STANDARDS ARE THE MINIMUM REQUIREMENTS FOR THE TRAFFIC CONTROL FOR THIS PROJECT.

STANDARD	APPLICATION
701006	WHERE VEHICLES, EQUIPMENT, WORKERS OR THEIR ACTIVITIES WILL ENCROACH IN THE AREA 15' TO 2' FROM THE EDGE OF PAVEMENT.
701311	WHERE ANY VEHICLE, EQUIPMENT, WORKERS OR THEIR ACTIVITIES REQUIRE A CONTINUOUS MOVING OPERATION WHERE THE AVERAGE SPEED IS GREATER THAN 3 MPH.
701501	WHERE AT ANYTIME ANY VEHICLE, EQUIPMENT, WORKER OR THEIR ACTIVITIES ENCROACH ON THE PAVEMENT REQUIRING CLOSURE OF ONE TRAFFIC LANE.
701606	WHERE AT ANYTIME ANY VEHICLE, EQUIPMENT, WORKER OR THEIR ACTIVITIES ENCROACH ON THE PAVEMENT REQUIRING THE CLOSURE OF ONE OR MORE TRAFFIC LANES.
701701	WHERE AT ANYTIME ANY VEHICLE, EQUIPMENT, WORKER OR THEIR ACTIVITIES ENCROACH ON THE PAVEMENT WITHIN THE VICINITY OF AN INTERSECTION.
701801	WHERE AT ANYTIME PEDESTRIAN TRAFFIC MUST BE REROUTED.
701901	ALL TRAFFIC CONTROL DEVICES

DRAWN BY: CES
DESIGNED BY: CES
CHECKED BY: GLJ
CITY SECTION
00-00361-00-PV

WINDSOR ROAD IMPROVEMENTS
STAGE CONSTRUCTION AND
MAINTENANCE OF TRAFFIC PLANS

SHEET NO.
22
OF
145