

MAST ARM LOADING DIAGRAM
NO SCALE

WINDSOR ROAD/MYRA RIDGE DRIVE INTERSECTION
NORTHWEST QUADRANT

MAST ARM DESIGN SHALL MEET MINIMUM DESIGN LOADING REQUIREMENTS PER HIGHWAY STANDARD 877011

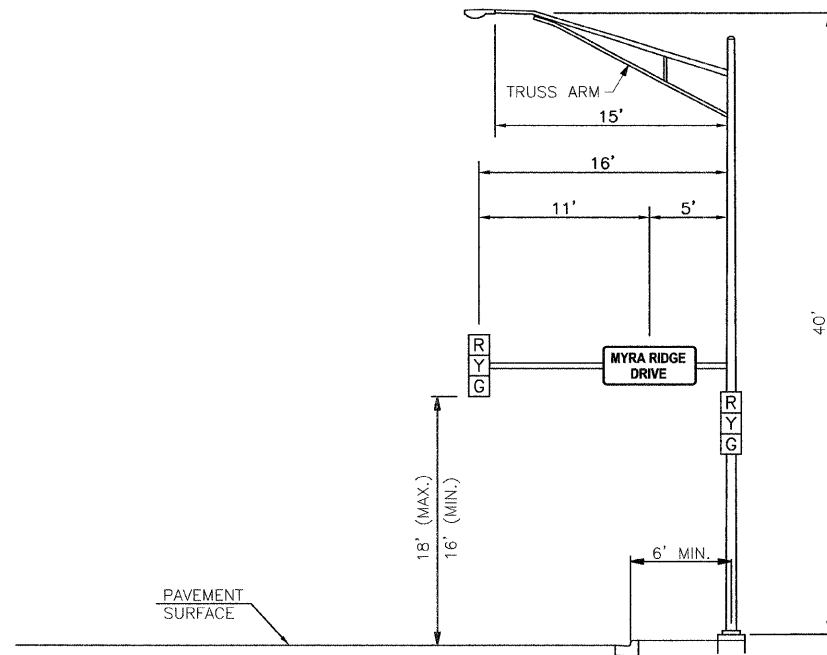

MAST ARM LOADING DIAGRAM
NO SCALE

WINDSOR ROAD/MYRA RIDGE DRIVE INTERSECTION
NORTHEAST QUADRANT

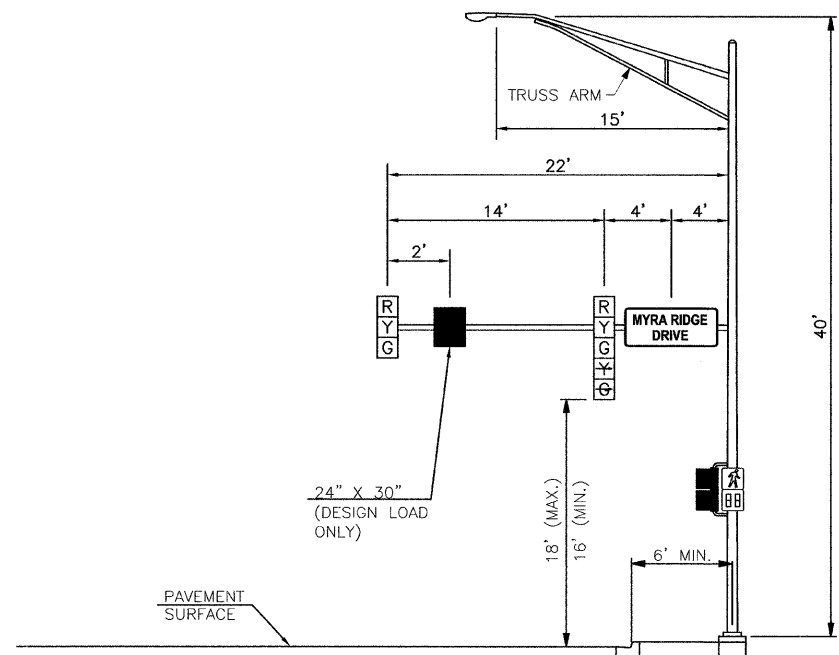

MAST ARM LOADING DIAGRAM
NO SCALE

WINDSOR ROAD/MYRA RIDGE DRIVE INTERSECTION
SOUTHWEST QUADRANT

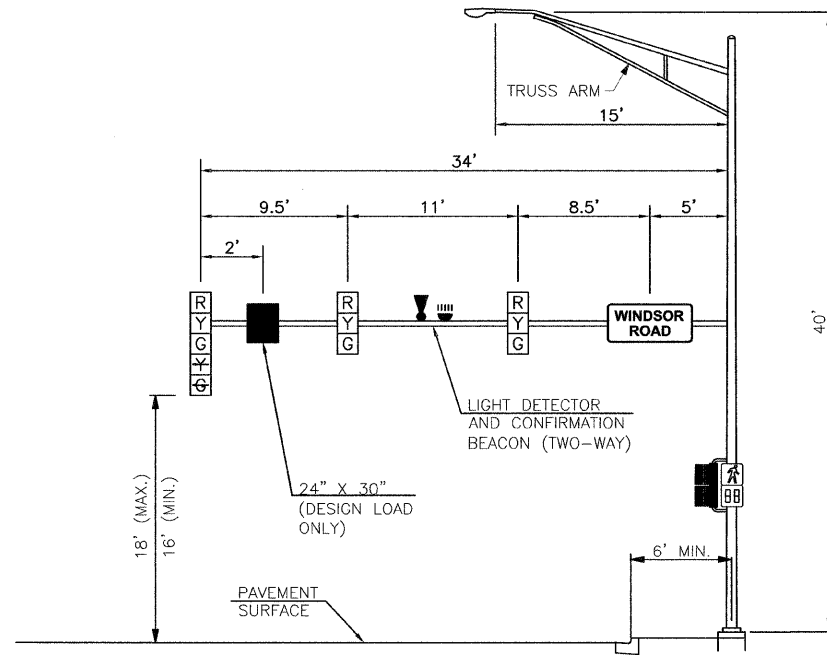

MAST ARM LOADING DIAGRAM
NO SCALE

WINDSOR ROAD/MYRA RIDGE DRIVE INTERSECTION
SOUTHEAST QUADRANT

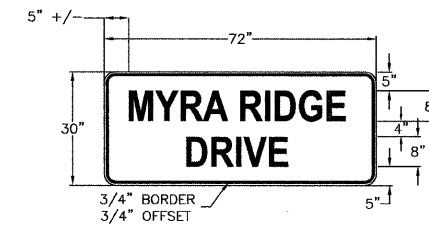

TEXT SPECIFICATIONS
- ALL TEXT IS 8" IN HIGH
- WIDTH SCALE OF 1:1.
- BORDER AND LEGEND :
3M DIAMOND GRADE VIP 3990 WHITE
- BACKGROUND:
EC SERIES 1170 GREEN TRANSLUCENT
(REVERSE IMAGE)

MAST ARM MOUNTED STREET NAME SIGN PANEL DETAIL

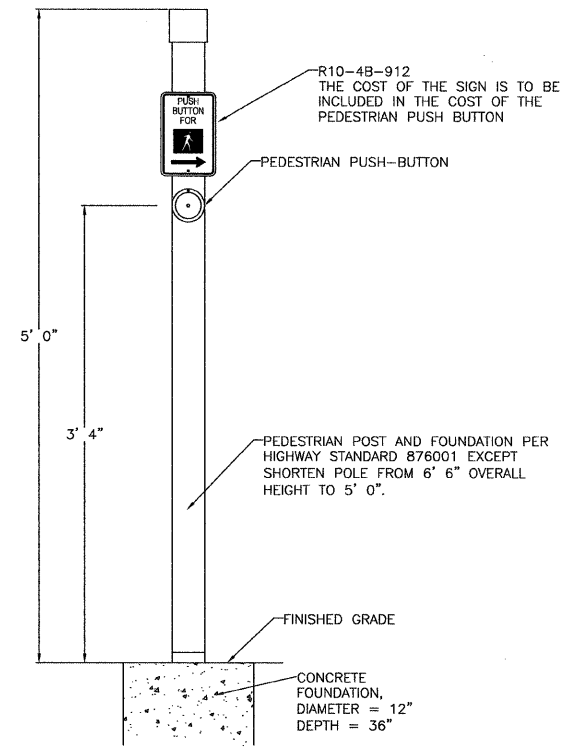

PEDESTRIAN PUSH-BUTTON POST DETAIL
NO SCALE

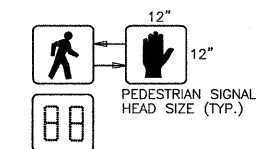

PEDESTRIAN COUNTDOWN
SIGNAL DISPLAY DETAIL
NO SCALE

DRAWN BY: AUS
CHECKED BY: GLJ
DESIGNED BY: CES
CITY SECTION
00-00361-00-PV

WINDSOR ROAD IMPROVEMENTS
TRAFFIC SIGNAL PLANS
TRAFFIC SIGNAL DETAILS

SHEET NO.
81
OF
145