

SEE THE TRAFFIC SIGNAL PLANS FOR TRAFFIC SIGNAL REMOVAL ITEMS.  
SEE THE ROADWAY LIGHTING PLANS FOR ROADWAY LIGHTING REMOVAL ITEMS.  
SEE DRAINAGE PLANS FOR ADDITIONAL INFORMATION.

THE LIMITS OF SIDEWALK REMOVAL AND BRICK PAVER REMOVAL ARE NOT SHOWN FOR THE REMOVAL AND/OR INSTALLATION OF LIGHT POLES, JUNCTION BOXES, OR PARKING METERS. QUANTITIES FOR THIS WORK ARE INCLUDED ON THE PLANS.

THE STRUCTURE INFORMATION SHOWN IN ITALICS IS ALSO SHOWN ON THE DRAINAGE PLANS. THE SCHEDULE OF QUANTITIES FOR THESE ITEMS IS SHOWN ON THE REMOVAL PLANS.

SEE SHEET 11 FOR REMOVAL NOTES

STA. 20+21.10 (C GOODWIN AVE.) =  
STA. 300+00.00 (C OREGON ST.)

STA. 20+21.10 (C GOODWIN AVE.) =  
STA. 300+03.33 (C OREGON ST.)

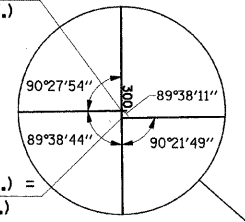

**LEGEND**  
Ⓡ - STRUCTURE TO BE REMOVED

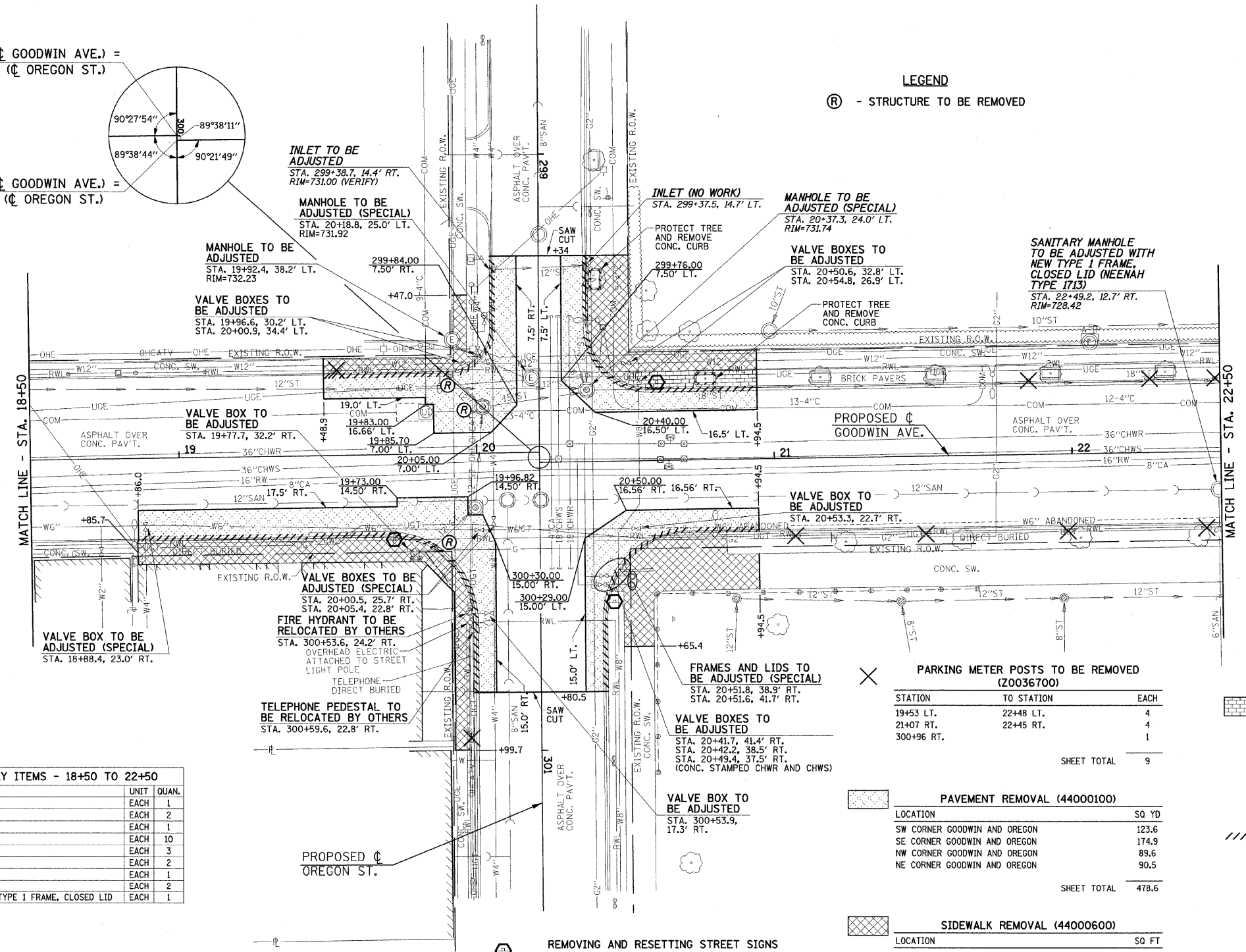

**STRUCTURE ADJUSTMENT AND REMOVAL PAY ITEMS - 18+50 TO 22+50**

CODE NO.	DESCRIPTION	UNIT	QUAN.
6025500	MANHOLES TO BE ADJUSTED	EACH	1
6025560	MANHOLES TO BE ADJUSTED (SPECIAL)	EACH	2
6026010	INLETS TO BE ADJUSTED	EACH	1
6026600	VALVE BOXES TO BE ADJUSTED	EACH	10
6026660	VALVE BOXES TO BE ADJUSTED (SPECIAL)	EACH	3
60300310	FRAMES AND LIDS TO BE ADJUSTED (SPECIAL)	EACH	2
60500040	REMOVING MANHOLES	EACH	1
60500060	REMOVING INLETS	EACH	2
X0321558	SANITARY MANHOLES TO BE ADJUSTED WITH NEW TYPE 1 FRAME, CLOSED LID	EACH	1

**PARKING METER POSTS TO BE REMOVED (Z0036700)**

STATION	TO STATION	EACH
19+53 LT.	22+48 LT.	4
21+07 RT.	22+45 RT.	4
300+96 RT.		1
<b>SHEET TOTAL</b>		<b>9</b>

**PAVEMENT REMOVAL (44000100)**

LOCATION	SQ YD	
SW CORNER GOODWIN AND OREGON	123.6	
SE CORNER GOODWIN AND OREGON	174.9	
NW CORNER GOODWIN AND OREGON	89.6	
NE CORNER GOODWIN AND OREGON	90.5	
<b>SHEET TOTAL</b>		<b>478.6</b>

**SIDEWALK REMOVAL (44000600)**

LOCATION	SQ FT	
SW CORNER GOODWIN AND OREGON	342.3	
SE CORNER GOODWIN AND OREGON	1146.1	
NW CORNER GOODWIN AND OREGON	800.0	
NE CORNER GOODWIN AND OREGON	970.4	
ROADWAY LIGHTING	105.0	
<b>SHEET TOTAL</b>		<b>3363.8</b>

**REMOVE AND REINSTALL BRICK PAVER (XX003313)**

LOCATION	SQ FT	
NW CORNER GOODWIN AND OREGON	206.6	
ROADWAY LIGHTING	75.0	
PARKING METER POSTS	24.0	
<b>SHEET TOTAL</b>		<b>305.6</b>

**COMBINATION CURB AND GUTTER REMOVAL (44000500)**

LOCATION	FOOT	
SW CORNER GOODWIN AND OREGON	88.9	
SE CORNER GOODWIN AND OREGON	154.0	
NW CORNER GOODWIN AND OREGON	93.4	
NE CORNER GOODWIN AND OREGON	93.2	
<b>SHEET TOTAL</b>		<b>429.5</b>

**CURB REMOVAL (44000300)**

LOCATION	FOOT	
NW CORNER GOODWIN AND OREGON	44.0	
<b>SHEET TOTAL</b>		<b>44.0</b>

**REMOVING AND RESETTING STREET SIGNS (Z0051500)**

LOCATION	EACH	
STA. 19+72 RT.	1	
STA. 20+61 LT.	1	
STA. 300+50 RT.	1	
<b>SHEET TOTAL</b>		<b>3</b>

FILE NAME = p:\u0070052\plans\sheet\10-Removal.dgn  
DESIGNED - JAJ  
DRAWN - DLH  
CHECKED - RLH  
DATE - 01-2009

REVISED -  
REVISED -  
REVISED -  
REVISED -

STATE OF ILLINOIS  
DEPARTMENT OF TRANSPORTATION

**REMOVALS/RELOCATIONS PLAN**

SCALE: 1"=20' SHEET NO. 13 OF 75 SHEETS STA. 18+50 TO STA. 22+50

**REVISED A-6-09**

F.A.U. RTE.	SECTION	COUNTY	TOTAL SHEETS	SHEET NO.
7175	07-00456-00-RS	CHAMPAIGN	75	13
GOODWIN AVENUE		CONTRACT NO. 91392		
FED. ROAD DIST. NO.		ILLINOIS FED. AID PROJECT		